



Remote Temperature Sensor

Installation Manual

Instructions for :-

KS9-BS1-A Remote Temperature Sensor

For safe and correct use please read this installation manual and the relevant Mitsubishi Electric installation manual

Contents

Page



- 3 Safety precautions
- 4 Installation instructions
 - Parts supplied
 - How to install
 - Setting of the indoor unit
- 5 Disclaimer / Warranty

Safety Precautions

Safety

For your safety first be sure to read Safety Precautions described below thoroughly and then install the Remote Temperature Sensor correctly.

The following two symbols are used to denote dangers that may be caused by incorrect use and their degree:

-  **WARNING** This symbol denotes what could lead to serious injury or death if you misuse the Sensor
-  **CAUTION** This symbol denotes what could lead to personal injury or damage to your property if you misuse the Sensor

After reading this installation manual, keep it in a place where the final user can see it at any time they want to. When someone moves, repairs or uses the Remote Temperature Sensor, make sure that this manual is forwarded to the final user.

WARNING

Ask your dealer or technical representative to install the unit.
Any deficiency caused by your own installation may result in an electric shock or fire.

Firmly connect the wiring to the specified cables.
Carefully check that the cables do not exert any force on the terminals.

Never modify or repair the Remote Temperature Sensor yourself.
Any deficiency caused by your own modification or repair may result in an electric shock or fire.

Ensure the installation work is carried out correctly following this installation manual.
Any deficiency caused by poor installation may result in an electric shock or fire.

All electrical work must be performed by a licensed technician, according to local regulations and the instructions given in this manual.
Any lack of electric circuit or any deficiency caused by poor installation may result in an electric shock or fire.

Do not move and re-install the Remote Temperature Sensor yourself.
Any deficiency caused by poor installation may result in an electric shock or fire.

Ensure the installation work is carried out correctly following this installation manual.
Any deficiency caused by poor installation may result in an electric shock or fire.

CAUTION

Do not use in any special environment.
Using in any place exposed to oil (including machine oil), steam, and sulphuric gas may deteriorate the performance significantly or give damage to the component parts.

Wire so that it does not receive any tension.

Do not wash with water.

Do not install in any place where acidic or alkaline solution or special spray are often used.

Use wires in compliance with the current capacity.

Do not install in any steamy location such as a bathroom or kitchen.
Avoid any place where moisture is condensed into dew.

Do not touch any PCB (Printed Circuit Board) with your hands or with tools. Do not allow dust to collect on the PCB.

Do not install in any place at a temperature of more than 40°C or less than 0°C or exposed to direct sunlight.

Installation Instructions

Parts Supplied

Confirm that the following parts are enclosed in the packaging in addition to this Installation Manual.

1. Remote Temperature Sensor complete with fitted 10m extension cable and CN20 plug.

How to Install

Determine the location for the installation of the Remote Temperature Sensor. The following items must be observed.

1. Select a place where the remote temperature sensor will detect an average temperature of the room and where the sensor will not be subject to direct sunlight, heat sources, or air flow from the air conditioning unit etc.
2. Install the sensor within the length of cable provided (10m). (The cable cannot be extended. If extended, it may cause operational malfunction due to noise.)

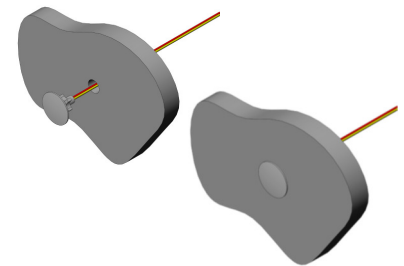
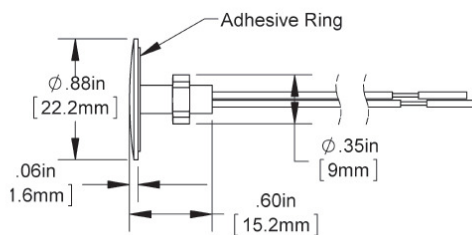

Fig.1

Fitting the Remote Temperature Sensor in wall space

1. Select a location with a flat surface on an interior wall approximately 5' (1.5m) off the floor.
2. Drill a 7/16" hole where you want the sensor mounted.
3. Pull the cable through the hole.
4. Be sure the wall interior is insulated behind the sensor. In-wall drafts can affect the temperature reading.
5. Clean the wall surface from any dust or filings to make a clean mounting surface.
6. Remove the mounting tape from the back of the sensor rim and push the sensor firmly into the 7/16" hole until the double stick tape adheres firmly to the wall.
7. Remove the sensor protector (Fig.2) before putting sensor into service.

Note: Once installed the sensor is difficult to remove and may damage the wall.

Connecting the Remote Temperature Sensor to the Mitsubishi Electric Air Conditioning Unit

1. Remove the existing connection from CN20 on the Mitsubishi Electric unit PCB (Fig.3).
2. Connect the remote temperature sensor CN20 connector to the Mitsubishi Electric PCB.
3. Test the sensor at the controller to be sure of your connections and sensor operation.

Fig. 3

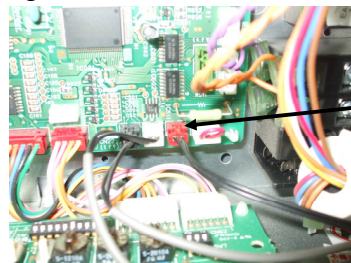

CN20 Connection

Setting of the indoor unit

When the Remote Temperature Sensor is connected to the Mitsubishi Electric indoor unit and room temperature detection position is changed, reset the setting of "Set temp. 4 deg. up" in the heating mode as described below.

1. K control models SW1-DIP switch number 6 on located on the control PCB of the indoor unit.
2. M-NET control models SW3-DIP switch number 8 on located on the control PCB of the indoor unit.
3. A controls models Refer to A-control air-conditioners SERVICE TECHNICAL GUIDE.

Disclaimer

Warranty:

All products manufactured on behalf of Mitsubishi Electric UK are warranted against defective materials for a period of three years from the date of delivery to the original purchaser.

**Warning:**

Mitsubishi Electric UK assumes no liability for damages consequent to the user of this product. We reserve the right to change this manual at any time without notice. The information furnished by us is believed to be accurate and reliable. However, no responsibility is assumed by us for its use, nor for any infringements of patents or other rights of third parties resulting from its use.

Please be sure to put the contact address/telephone number
on this manual before handing it to the customer.



mitsubishi electric uk

MITSUBISHI ELECTRIC UK, TRAVELLERS LANE, HATFIELD, HERTFORDSHIRE, AL10 8XB