

TECHNICAL & SERVICE MANUAL

Series PLH Ceiling Cassettes R407C

Indoor unit
[Model names]

PLH-P1.6KAH

PLH-P2KAH

PLH-P2.5KAH

[Service Ref.]

PLH-P1.6KAH.UK
PLH-P1.6KAH₁.UK
PLH-P2KAH.UK
PLH-P2KAH₁.UK
PLH-P2.5KAH.UK
PLH-P2.5KAH₁.UK

Revision:

- "12. PARTS LIST" has been modified.
- Program timer <PAC-YT32PTA> has been added in "13. OPTIONAL PARTS".

Note:

- Refer to the OCT03 REVISED EDITION-E as for control relation. This manual does not cover outdoor units. When servicing them, please refer to the service manual No.OC180 REVISED EDITION-A OC261 and this manual in a set.

- Please void OC235 REVISED EDITION-A.

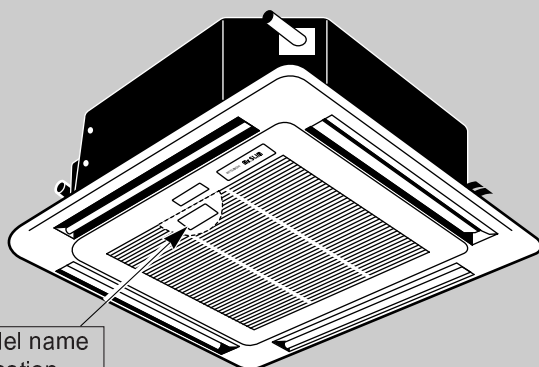

INDOOR UNIT

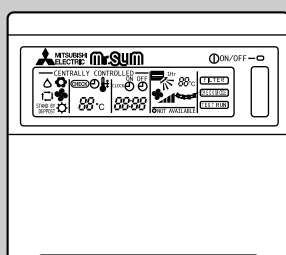

PLH-P1.6, 2, 2.5KAH.UK

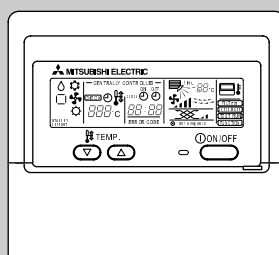

PLH-P1.6, 2, 2.5KAH.UK

REMOTE CONTROLLER

CONTENTS

1. TECHNICAL CHANGES	3
2. COMBINATION OF INDOOR AND OUTDOOR UNITS	3
3. SAFETY PRECAUTION	4
4. PART NAMES AND FUNCTIONS	6
5. SPECIFICATIONS	11
6. DATA	17
7. OUTLINES AND DIMENSIONS	36
8. WIRING DIAGRAM	37
9. REFRIGERANT SYSTEM DIAGRAM	38
10. TROUBLESHOOTING	39
11. DISASSEMBLY PROCEDURE	41
12. PARTS LIST	44
13. OPTIONAL PARTS	48

PANEL PARTS

PLH-P1.6KAH.UK, PLH-P2KAH.UK, PLH-P2.5KAH.UK
 PLH-P1.6KAH₁.UK, PLH-P2KAH₁.UK, PLH-P2.5KAH₁.UK

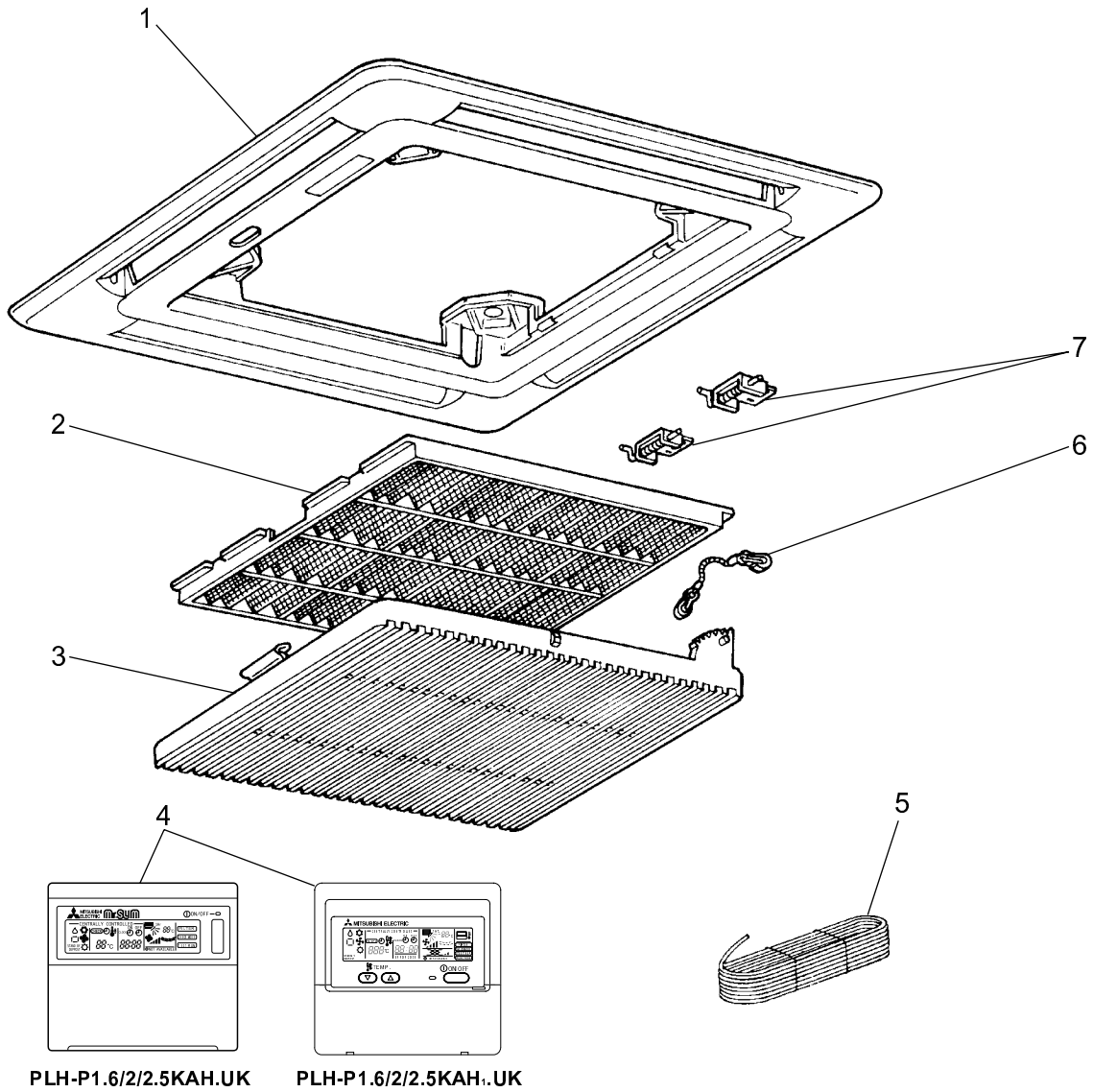

No.	Part No.	Part Name	Specification	Q'ty/set		Remarks (Drawing No.)	Wiring Diagram Symbol	Recom- mended Q'ty	Price	
				PLH-P1.6/2/2.5					Unit	Amount
				KAH.UK	KAH ₁ .UK					
1	S70 560 003	AIR OUTLET GRILLE		1	1					
2	S70 29H 500	AIR FILTER		1	1					
3	S70 29H 691	INTAKE GRILLE		1	1					
4	S70 E00 713	REMOTE CONTROLLER	PAR-S27A-E	1			R.B			
	S70 E13 713	REMOTE CONTROLLER	PAR-20MAA-E		1		R.B			
5	S70 58A 246	CORD		1	1					
6	S70 29H 098	GRILLE HANGER		1	1					
7	S70 29H 061	HINGE		2	2					

PANEL PARTS

PLH-P1.6KAH.UK, PLH-P2KAH.UK, PLH-P2.5KAH.UK

PLH-P1.6KAH₁.UK, PLH-P2KAH₁.UK, PLH-P2.5KAH₁.UK

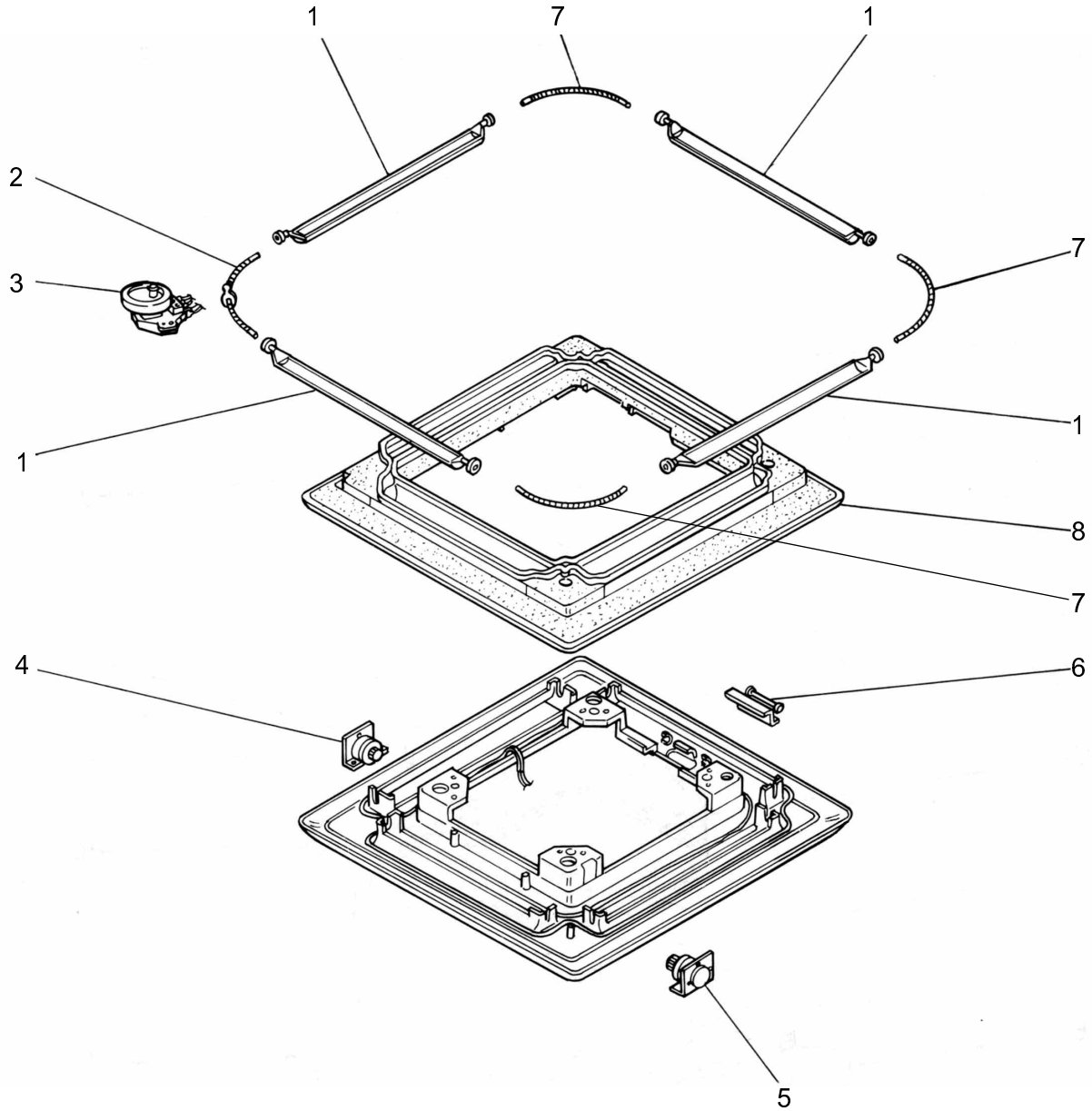

No.	Part No.	Part Name	Specification	Q'ty/set		Remarks (Drawing No.)	Wiring Diagram Symbol	Recom- mended Q'ty	Price	
				PLH-P1.6/2/2.5					Unit	Amount
				KAH.UK	KAH ₁ .UK					
1	S70 29H 002	AUTO VANE		4	4					
2	S70 31H 063	SPRING JOINT 2		1	1					
3	S70 29H 223	VANE MOTOR		1	1		MV			
4	S70 29H 041	GRILLE GEAR LEFT		1	1					
5	S70 29H 040	GRILLE GEAR RIGHT		1	1					
6	S70 29H 056	PUSH BUTTON		1	1					
7	S70 29H 063	SPRING JOINT 1		1	1	<3/SET>				
8	S70 29H 085	AIR GUIDE		1	1					

FUNCTIONAL PARTS

PLH-P1.6KAH.UK, PLH-P2KAH.UK, PLH-P2.5KAH.UK
 PLH-P1.6KAH₁.UK, PLH-P2KAH₁.UK, PLH-P2.5KAH₁.UK

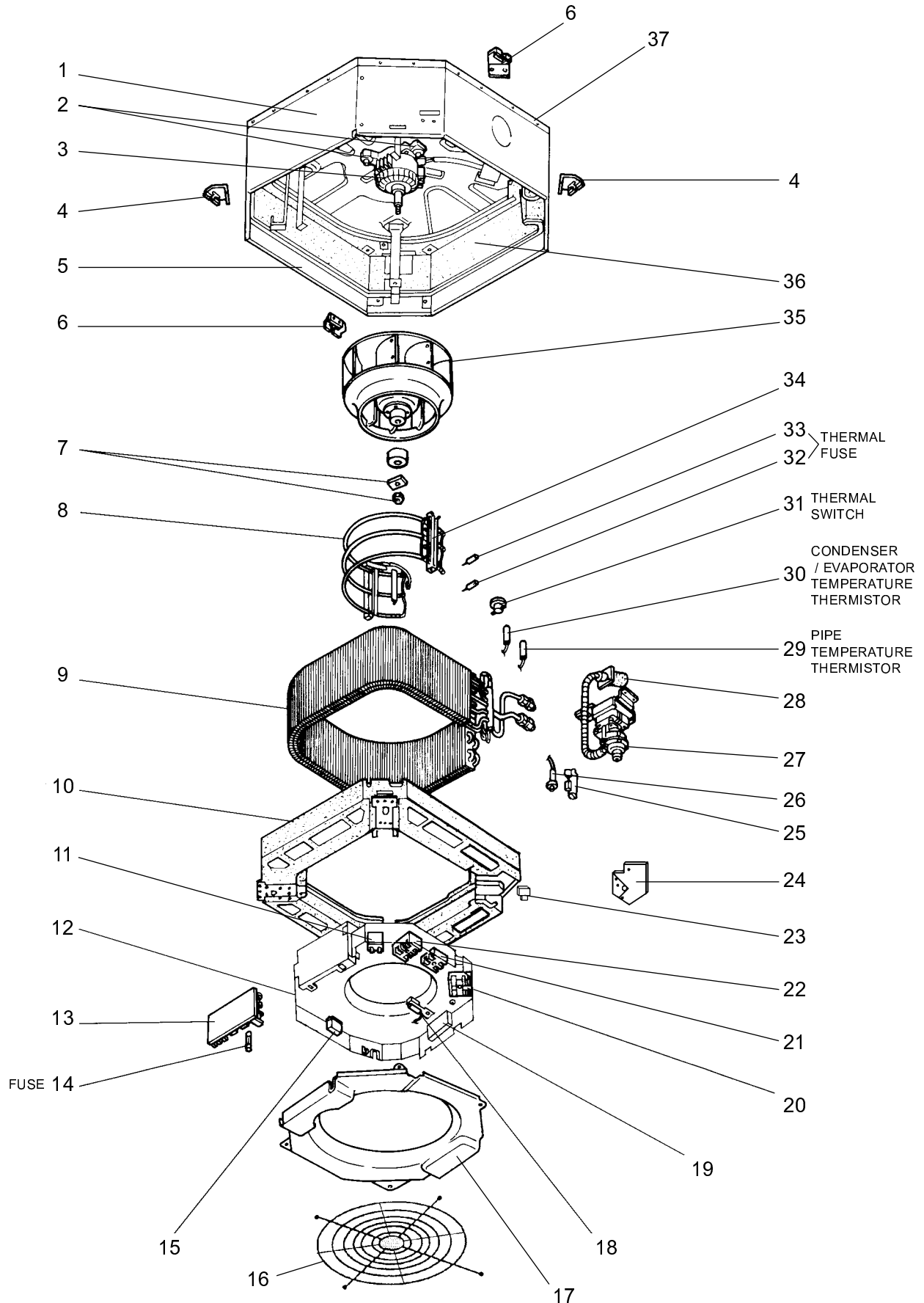

Part numbers that is circled is not shown in the figure.

No.	Part No.	Part Name	Specification	Q'ty/set						Remarks (Drawing No.)	Wiring Diagram Symbol	Recom- mended Q'ty	Price	
				PLH-P-KAH.UK			PLH-P-KAH..UK						Unit	Amount
				1.6	2	2.5	1.6	2	2.5					
1	S70 003 688	DRUM1 ASSY		1	1	1	1	1	1					
2	S70 29H 105	MOTOR MOUNT		3	3	3	3	3	3					
3	S70 E00 762	FAN MOTOR	PAI-V30F-1	1	1	1	1	1	1		MF			
4	S70 100 130	LEG		2	2	2	2	2	2					
5	S70 004 688	DRUM2 ASSY		1	1	1	1	1	1					
6	S70 101 130	LEG		2	2	2	2	2	2					
7	S70 08K 097	SPL WASHER		1	1	1	1	1	1					
8	S70 A00 300	HEATER ELEMENT	467W 240V	3	3		3	3			H1			
	S70 A01 300	HEATER ELEMENT	700W 240V			3			3		H1			
9	S70 E23 480	HEAT EXCHANGER		1	1		1	1						
	S70 E29 480	HEAT EXCHANGER				1			1					
10	S70 A10 529	DRAIN PAN		1	1	1	1	1	1					
11	S70 29H 255	CAPACITOR	2.5μF 400V	1	1	1	1	1	1		C			
12	S70 003 501	CONTROL COVER ASSY		1	1	1	1	1	1					
13	S70 E20 310*	CONTROLLER BOARD		1	1	1	1	1	1		I.B ※			
14	S70 E00 239	FUSE	250V 4A	1	1	1	1	1	1		F1<P.B>			
15	S70 71G 215	RELAY	JC-1a DC12V	1	1	1	1	1	1		88H			
16	S70 A00 675	FAN GUARD		1	1	1	1	1	1					
17	S70 003 502	BELL MOUTH		1	1	1	1	1	1					
18	S70 E10 202	ROOM TEMPERATURE THERMISTOR	S/750XAP	1	1	1	1	1	1		TH1			
19	S70 E00 313	POWER BOARD		1	1	1	1	1	1		P.B			
20	S70 E01 716	TERMINAL BLOCK	3P(S1,S2,S3)	1	1	1	1	1	1		TB4			
21	S70 515 716	TERMINAL BLOCK	2P(1,2)	1	1	1	1	1	1		TB5			
22	S70 A14 716	TERMINAL BLOCK	3P(L,N,⊙)	1	1	1	1	1	1		TB2			
23	S70 A48 524	DRAIN PLUG		1	1	1	1	1	1					
24	S70 002 660	CORNER COVER		1	1	1	1	1	1					
25	S70 32K 241	SENSOR HOLDER		1	1	1	1	1	1					
26	S70 31K 266	DRAIN SENSOR		1	1	1	1	1	1		DS			
27	S70 55K 355	DRAIN PUMP		1	1	1	1	1	1		DP			
28	S70 29H 523	DRAIN SOCKET		1	1	1	1	1	1					
29	S70 08K 202	PIPE TEMPERATURE THERMISTOR		1	1	1	1	1	1		TH2			
30	S70 E09 202	CONDENSER / EVAPORATOR TEMPERATURE THERMISTOR		1	1	1	1	1	1		TH5			
31	S70 046 700	THERMAL SWITCH	OFF42°C ON32°C	1	1	1	1	1	1		26H			
32	S70 32K 706	THERMAL FUSE	77°C 250V 10A	1	1	1	1	1	1		FS2			
33	S70 33K 706	THERMAL FUSE	98°C 250V 10A	1	1	1	1	1	1		FS1			
34	S70 20J 303	INSULATOR		1	1	1	1	1	1					
35	S70 41N 114	TURBO FAN		1	1	1	1	1	1					
36	S70 002 659	INNER COVER		1	1	1	1	1	1					
37	S70 002 687	BASE		1	1	1	1	1	1					
38	S70 W28 527	DRAIN HOSE		1	1	1	1	1	1					

※ The part name of symbol "I.B" is "SPCB".

1. Program timer (PLH-P1.6 / 2 / 2.5KAH.UK)

Part No.	PAC-SC32PTA (with set back function)
Applied Service Ref.	PLH-P1.6 / 2 / 2.5KAH.UK

1-1 Program timer specifications

Part name	Program timer
Parts No.	PAC-SC32PTA
Exterior dimensions (inch)	5-4/32X4-23/32X23/32 (130X120X18mm)
Installation	Wall mount
Type of clock	Quartz
Clock accuracy	± 50 second / month at 25°C
Display-Time	Liquid crystal display
-Week	Liquid crystal display
-Timer setting unit	Liquid crystal display
Program cycle	24 hours
Timer setting unit	30 minutes
No. of set points	48 / day
Power rating	5V DC ±5% (Supplied by Remote Controller)

1-2 Feature of program timer

- (1) Daily timer function
Daily timer can be set in 30 minutes units for up to 24 hours.
Each unit can be set for unit ON, unit OFF, or setback operation.
- (2) Setback operation
Set back operation is useful for reducing running costs
e.g. At a hotel with a 24-hour system
8:00~23:00 Cooling operation with set temperature at 26°C
23:00~8:00 Setback operation with 2 degrees of setback
As shown in the chart on the right, the set temperature rises 2 degrees automatically during the setback operation. When the setback operation ends, normal operation will begin.
- (3) Weekly timer function
Daily timer function can apply to each day of the week.

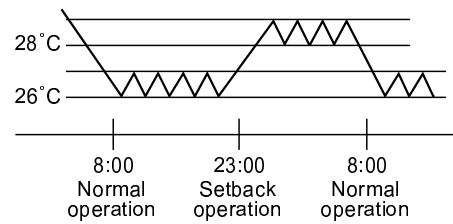

1-3 How to connect program timer

- (1) Install the program timer next to the remote controller the same way as the remote controller is installed.
- (2) Connect the program timer and the remote controller with a 5-wire cable as shown in the figure below

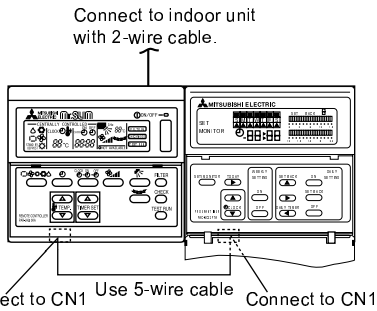

NOTE: While the program timer is connected to the remote controller, the 24hour ON/OFF timer on the remote controller will not operate.

1-4 Names and functions

<PAC-SC32PTA>

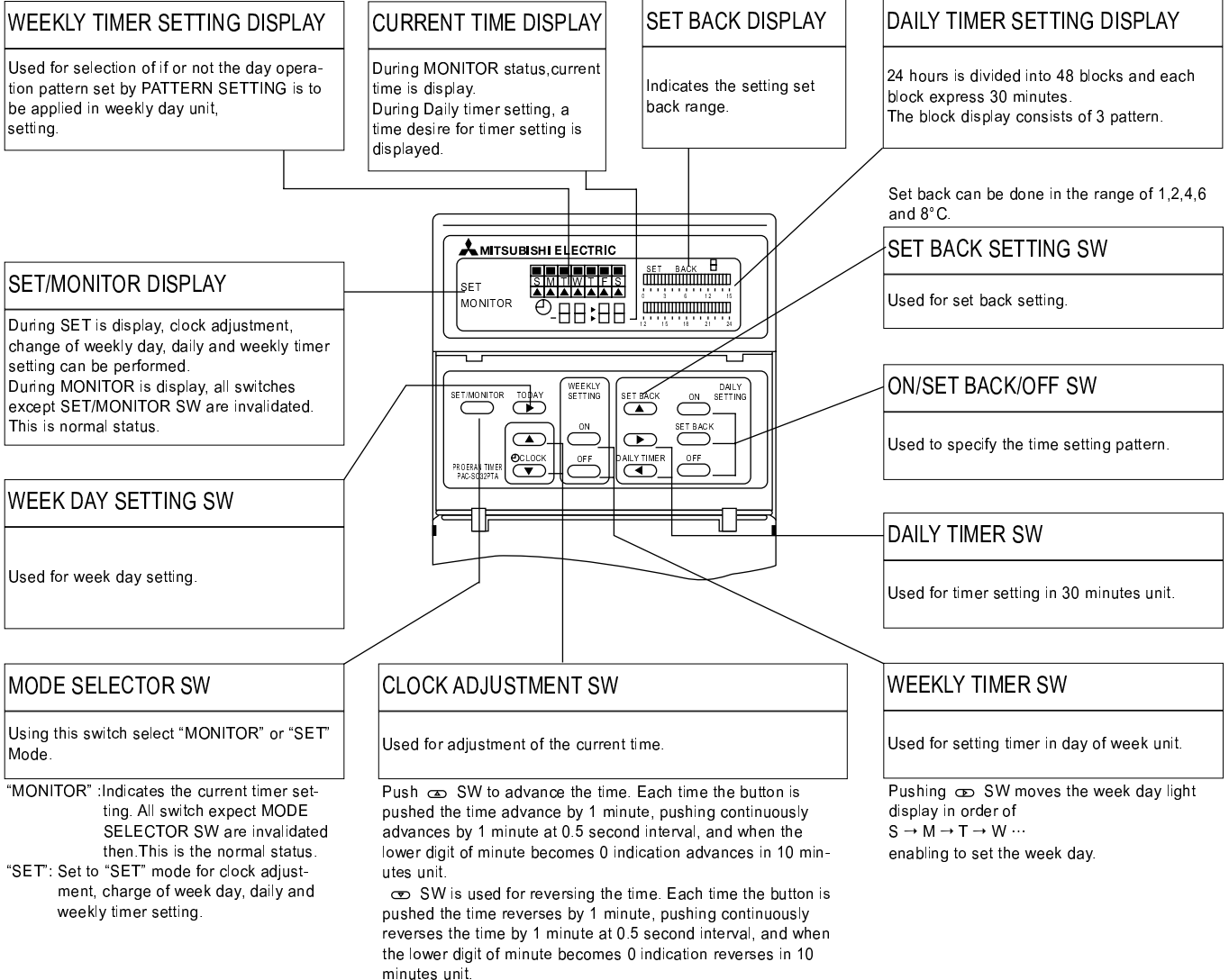

2. Program timer (PLH-P1.6 / 2 / 2.5KAH₁.UK)

Part No.	PAC-YT32PTA
Applied Service Ref.	PLH-P1.6 / 2 / 2.5KAH ₁ .UK

2-1 Names and functions

<PAC-YT32PTA>

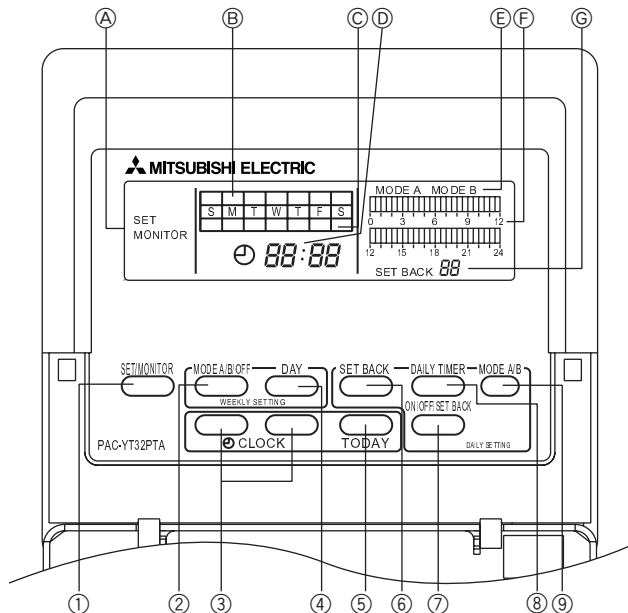

- A SET/MONITOR DISPLAY:**
When SET is displayed, clock adjustment, change of day, and daily and weekly timer settings can be performed. When MONITOR is displayed, all switches except SET/MONITOR SW are invalidated. This is normal status.
- B WEEKLY TIMER SETTING DISPLAY:**
Used to select whether the operation pattern set using the PATTERN SETTING can be applied to different days of the week.
- C CURRENT DAY DISPLAY:**
Indicates the current day.
- D CURRENT TIMEDISPLAY:**
During MONITOR status, current time is display.
During daily timer setting, a time desire for timer setting is displayed.
- E OPERATION MODE DISPLAY:**
Indicates the operation mode.
- F DAILY TIMER SETTING DISPLAY:**
24 hours is divided into 48 blocks and each block is expressed in 30 minutes.
The block display consists of 3 patterns.
- G SET BACK DISPLAY**
Indicates the set back value.
- 1 SET/MONITOR Button**
Using this switch, select "MONITOR" or "SET" Mode.
"MONITOR": Indicates the current timer setting. All switches except MODE SELECTOR SW are invalidated then. This is the normal status.
"SET": Set to "SET" mode for clock adjustment, change of day and daily and weekly timer settings.
- 2 MODE A/B/OFF Button**
Used for setting timer in day of week unit.
- 3 CLOCK ADJUSTMENT Button**
Used for adjustment of the current time.
Push [▲] SW to advance the time. Each time the button is pushed the time advances by 1 minute, pushing continuously advances by 1 minute at 0.5 second intervals, and when the lower digit of the minute becomes "0" the time advances in 10 minute units.
[▼] SW is used for reversing the time. Each time the button is pushed the time reverses by 1 minute at 0.5 second intervals, and when the lower digit of the minute becomes "0" the time reverses in 10 minute units.
- 4 DAY SETTING Button**
Used when setting the day.
- 5 WEEK DAY SETTING Button**
Used for week day setting.
Pushing [▶] SW moves the week day light display in order of S → M → T → W → ... enabling to set the week day.
- 6 SET BACK SETTING Button**
Used for set back setting.
Set back can be done in the range of 1, 2, 4, 6 and 8°C (2, 4, 8, 12 and 16°F).
- 7 ON/OFF/SET BACK Button**
Used to specify the time setting pattern.
- 8 DAILY TIMER Button**
Used for timer setting in 30 minute units.
- 9 MODE A/B Button**
Used to set A Mode or B Mode when specifying the operation time.

3. Wide Panel

Part No.	PAC-SE06WP-E
Applied Service Ref.	PLH-P1.6 / 2 / 2.5KAH.UK, PLH-P1.6 / 2 / 2.5KAH.UK

4. Space Panel

Part No.	PAC-SE01AS-E
Applied Service Ref.	PLH-P1.6 / 2 / 2.5KAH.UK, PLH-P1.6 / 2 / 2.5KAH.UK

5. Multi-Functional Casement (For HIGH EFFICIENCY FILTER AND FRESH AIR INTAKE)

Part No.	PAC-SE21TM-E
Applied Service Ref.	PLH-P1.6 / 2 / 2.5KAH.UK, PLH-P1.6 / 2 / 2.5KAH.UK

6. High-Efficiency Filter Element

Part No.	PAC-SE13KF-E
Applied Service Ref.	PLH-P1.6 / 2 / 2.5KAH.UK, PLH-P1.6 / 2 / 2.5KAH.UK

7. Grille + Wireless Remote Controller

Part No.	PLP-2.5KAL-E	PLP-2.5KLM
Applied Service Ref.	PLH-P1.6 / 2 / 2.5KAH.UK	PLH-P1.6 / 2 / 2.5KAH.UK

8. Remote Sensor

Part No.	PAC-SE41TS-E
Applied Service Ref.	PLH-P1.6 / 2 / 2.5KAH.UK, PLH-P1.6 / 2 / 2.5KAH.UK

9. Remote Operation Adapter

Part No.	PAC-SF40RM-E
Applied Service Ref.	PLH-P1.6 / 2 / 2.5KAH.UK, PLH-P1.6 / 2 / 2.5KAH.UK

10. Remote ON/OFF Adapter

Part No.	PAC-SE55RA-E
Applied Service Ref.	PLH-P1.6 / 2 / 2.5KAH.UK, PLH-P1.6 / 2 / 2.5KAH.UK

Mr. SLIM™

 **mitsubishi electric corporation**
HEAD OFFICE : MITSUBISHI DENKI BLDG., 2-2-3, MARUNOUCHI, CHIYODA-KU, TOKYO100-8310, JAPAN