

TECHNICAL & SERVICE MANUAL

Series PLA

Ceiling Cassettes R407C

Indoor unit
[Model names]

PLA-P3AA

PLA-P4AA

PLA-P5AA

PLA-P6AA

[Service Ref.]

PLA-P3AA.UK
PLA-P3AA₁.UK
PLA-P4AA.UK
PLA-P4AA₁.UK
PLA-P5AA.UK
PLA-P5AA₁.UK
PLA-P6AA.UK
PLA-P6AA₁.UK

Revision:

- "12. PARTS LIST" has been modified.
- Program timer <PAC-YT32PTA> has been added in "13. OPTIONAL PARTS".

Note:

- Refer to the OCT03 REVISED EDITION-E as for control relation. This manual does not cover outdoor units. When servicing them, please refer to the service manual No.OC180 REVISED EDITION-A OC261 and this manual in a set.

- Please void OC241 REVISED EDITION-A.

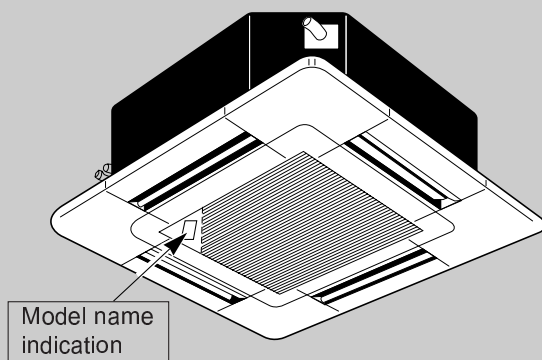

PLA-P•AA.UK PLA-P•AA₁.UK

WIRELESS REMOTE
CONTROLLER

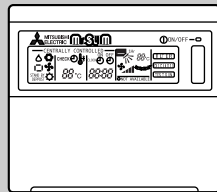

PLA-P•AA.UK

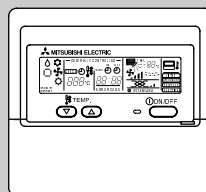

PLA-P•AA₁.UK

WIRED REMOTE
CONTROLLER

CONTENTS

1. TECHNICAL CHANGES	2
2. COMBINATION OF INDOOR AND OUTDOOR UNITS ..	3
3. SAFETY PRECAUTION	3
4. PART NAMES AND FUNCTIONS	5
5. SPECIFICATIONS	11
6. DATA	23
7. OUTLINES AND DIMENSIONS	52
8. WIRING DIAGRAM	53
9. REFRIGERANT SYSTEM DIAGRAM	54
10. TROUBLESHOOTING	58
11. DISASSEMBLY PROCEDURE	60
12. PARTS LIST	63
13. OPTIONAL PARTS	68

12

PARTS LIST

PANEL PARTS

PLA-P3AA.UK, PLA-P4AA.UK, PLA-P5AA.UK, PLA-P6AA.UK
 PLA-P3AA1.UK, PLA-P4AA1.UK, PLA-P5AA1.UK, PLA-P6AA1.UK

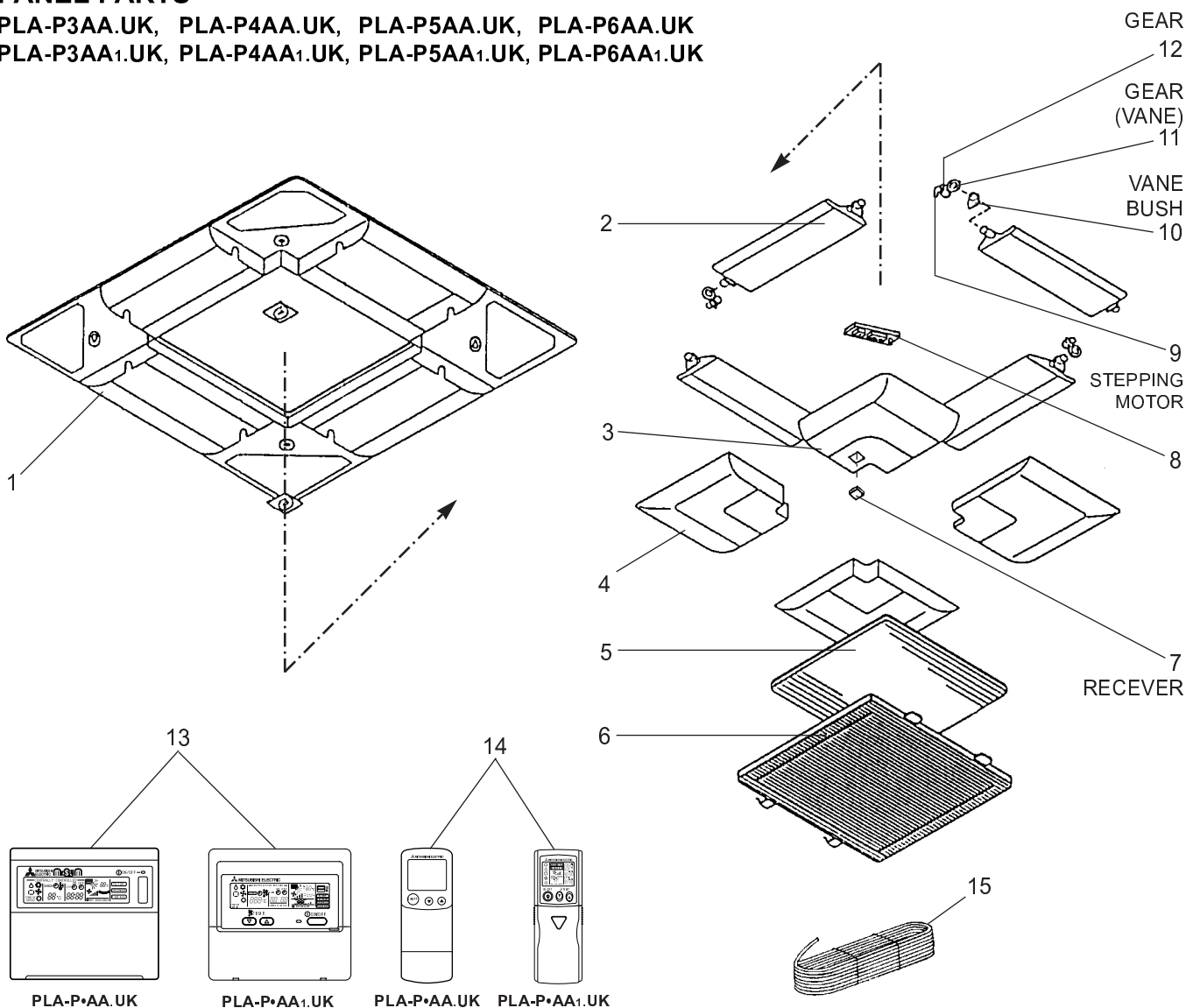

No.	Parts No.	Parts Name	Specifi- cation	Q'ty / set				Remarks (Drawing No.)	Wiring Diagram Symbol	Recom- mended Q'ty	Price	
				PLA -P3/4/5/6							Unit	Amount
				AA.UK		AA1.UK						
WIRED	WIRELESS	WIRED	WIRELESS									
1	S70 E10 003	AIR OUTLET GRILLE		1	1	1	1					
2	S70 E01 002	VANE ASSY		4	4	4	4					
3	S70 E01 638	CORNER PANEL		1	2	1	2					
4	S70 E00 638	CORNER PANEL		3	2	3	2					
5	S70 E00 500	L.L FILTER-A		1	1	1	1					
6	S70 E00 691	GRILLE ASSY		1	1	1	1					
7	S70 24K 658	RECEIVER					1	RU				
8	S70 E00 317	WIRELESS ADAPTER					1	W.B				
9	S70 E00 223	STEPPING MOTOR		4	4	4	4	MV				
10	S70 E00 063	VANE BUSH		8	8	8	8					
11	S70 E00 040	GEAR (VANE)		4	4	4	4					
12	S70 E01 040	GEAR		4	4	4	4					
13	S70 E03 713	REMOTE CONTROLLER ASSY	PAR-S27A-E	1				R.B				
	S70 E13 713	REMOTE CONTROLLER ASSY	PAR-20MAA-E			1		R.B				
14	S70 E05 714	WIRELESS REMOTE CONTROLLER ASSY	PAR-SL95A-E		1							
	S70 E15 714	WIRELESS REMOTE CONTROLLER ASSY	PAR-SL97A-E				1					
15	S70 58A 246	CORD		1	1	1	1					

FUNCTIONAL PARTS

PLA-P3AA.UK, PLA-P4AA.UK
 PLA-P3AA1.UK, PLA-P4AA1.UK

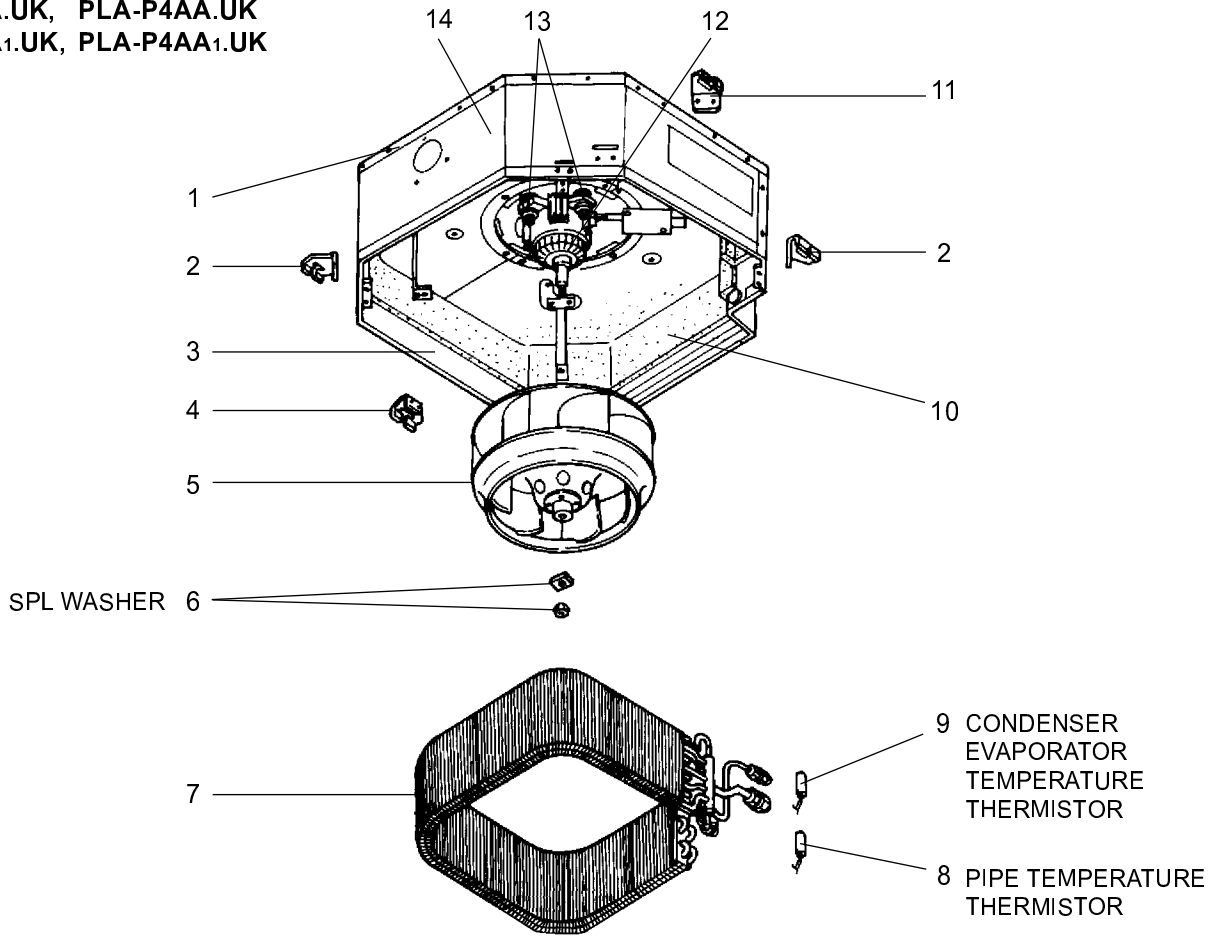

No.	Parts No.	Parts Name	Specifi- cation	Q'ty / set				Remarks (Drawing No.)	Wiring Diagram Symbol	Recom- mended Q'ty	Price	
				PLA-P3		PLA-P4					Unit	Amount
				AA.UK	AA1.UK	AA.UK	AA1.UK					
1	S70 003 687	BASE		1	1	1	1					
2	S70 E01 130	LEG		2	2	2	2					
3	S70 005 688	DRUM 1 ASSY		1	1							
	S70 007 688	DRUM 1 ASSY				1	1					
4	S70 E00 130	LEG		1	1	1	1					
5	S70 E00 114	TURBO FAN		1	1							
	S70 E01 114	TURBO FAN				1	1					
6	S70 08K 097	SPL WASHER		1	1	1	1					
7	S70 E20 480	HEAT EXCHANGER		1	1							
	S70 E21 480	HEAT EXCHANGER				1	1					
8	S70 17J 202	PIPE TEMPERATURE THERMISTOR		1	1	1	1	TH2				
9	S70 E20 202	CONDENSER EVAPORATOR TEMPERATURE THERMISTOR		1	1	1	1	TH5				
10	S70 E01 659	INNER COVER		1	1							
	S70 E02 659	INNER COVER				1	1					
11	S70 E02 130	LEG		1	1	1	1					
12	S70 E06 762	FAN MOTOR	D17B6P70MS	1	1			MF				
	S70 E07 762	FAN MOTOR	D176P120MS			1	1	MF				
13	S70 A41 105	MOTOR MOUNT		4	4	4	4					
14	S70 006 688	DRUM 2 ASSY		1	1							
	S70 008 688	DRUM 2 ASSY				1	1					

FUNCTIONAL PARTS

PLA-P5AA.UK, PLA-P6AA.UK
 PLA-P5AA1.UK, PLA-P6AA1.UK

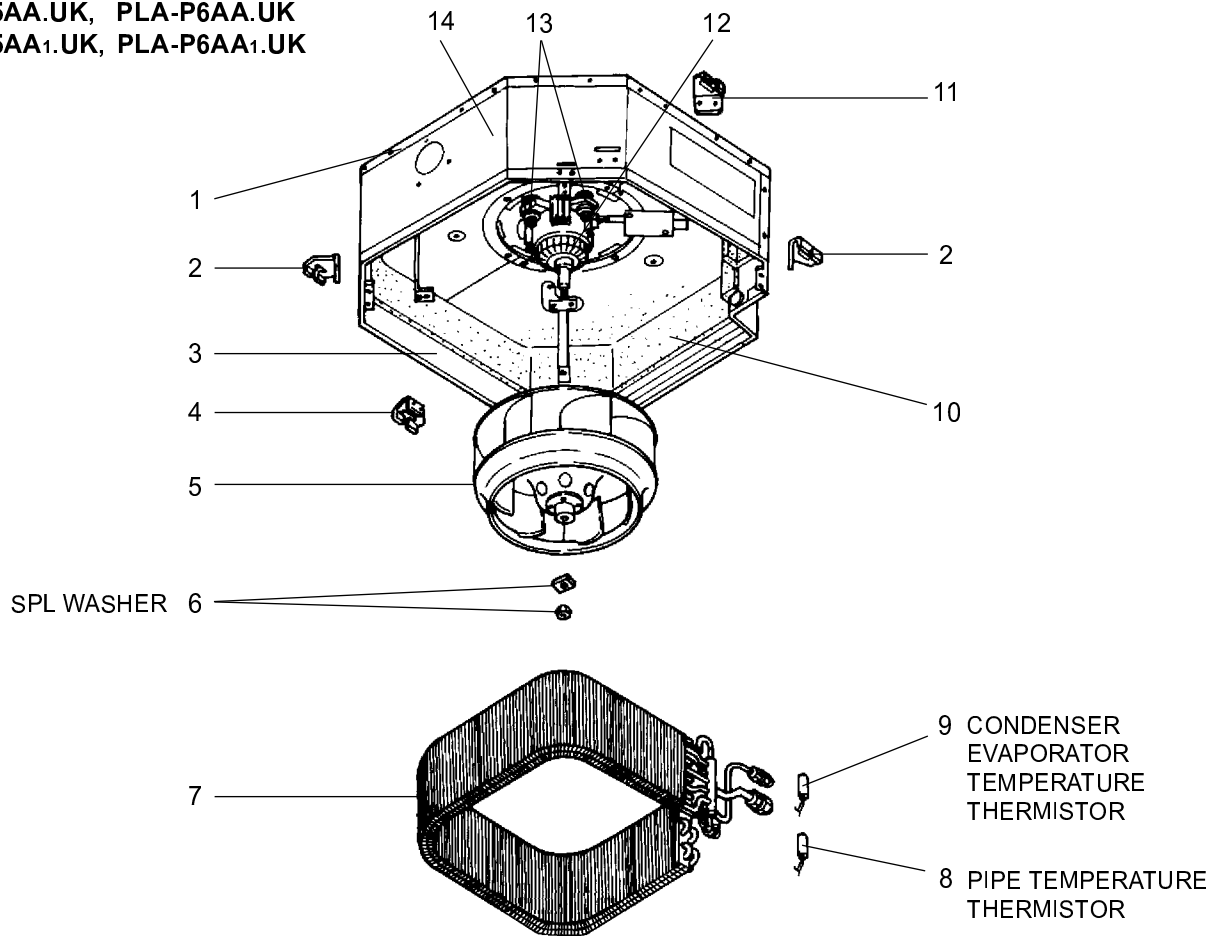

No.	Parts No.	Parts Name	Specifi- cation	Q'ty / set				Remarks (Drawing No.)	Wiring Diagram Symbol	Recom- mended Q'ty	Price	
				PLA-P5		PLA-P6					Unit	Amount
				AA.UK	AA1.UK	AA.UK	AA1.UK					
1	S70 003 687	BASE		1	1	1	1					
2	S70 E01 130	LEG		2	2	2	2					
3	S70 007 688	DRUM 1 ASSY		1	1	1	1					
4	S70 E00 130	LEG		1	1	1	1					
5	S70 E01 114	TURBO FAN		1	1	1	1					
6	S70 08K 097	SPL WASHER		1	1	1	1					
7	S70 E24 480	HEAT EXCHANGER		1	1							
	S70 E25 480	HEAT EXCHANGER				1	1					
8	S70 17J 202	PIPE TEMPERATURE THERMISTOR		1	1	1	1		TH2			
9	S70 E20 202	CONDENSER EVAPORATOR TEMPERATURE THERMISTOR		1	1	1	1		TH5			
10	S70 E02 659	INNER COVER		1	1	1	1					
11	S70 E02 130	LEG		1	1	1	1					
12	S70 E07 762	FAN MOTOR	D176P120MS	1	1	1	1		MF			
13	S70 A41 105	MOTOR MOUNT		4	4	4	4					
14	S70 008 688	DRUM 2 ASSY		1	1	1	1					

FUNCTIONAL PARTS

PLA-P3AA.UK, PLA-P4AA.UK

PLA-P3AA₁.UK, PLA-P4AA₁.UK

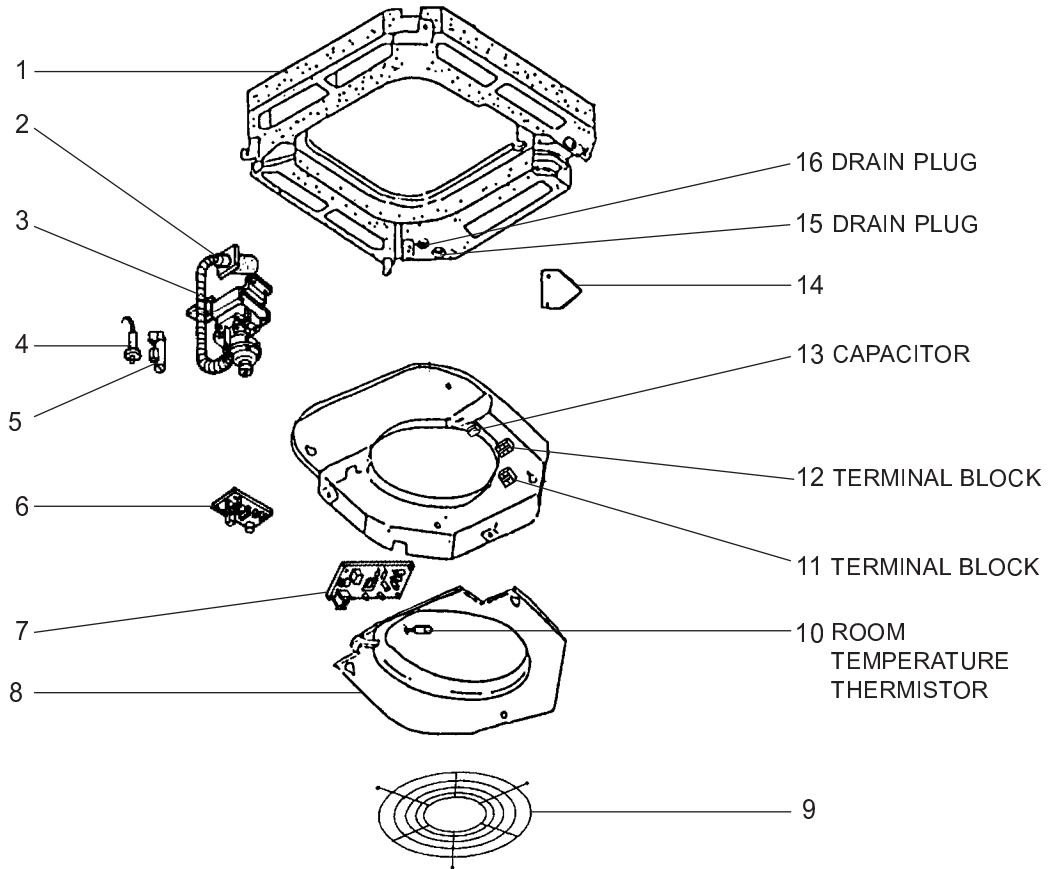

Part numbers that is circled is not shown in the figure.

No.	Parts No.	Parts Name	Specifi- cation	Q'ty / set				Remarks (Drawing No.)	Wiring Diagram Symbol	Recom- mended Q'ty	Price	
				PLA-P3		PLA-P4					Unit	Amount
				AA.UK	AA ₁ .UK	AA.UK	AA ₁ .UK					
1	S70 E02 529	DRAIN PAN		1	1							
	S70 E00 529	DRAIN PAN				1	1					
2	S70 29H 523	DRAIN SOCKET		1	1	1	1					
3	S70 E02 355	DRAIN PUMP		1	1	1	1		DP			
4	S70 E00 266	DRAIN SENSOR		1	1	1	1		DS			
5	S70 31K 241	DRAIN SENSOR HOLDER		1	1	1	1					
6	S70 E02 313	POWER BOARD		1	1	1	1		P.B			
7	S70 E20 310*	INDOOR CONTROLLER BOARD		1	1	1	1		I.B ※			
8	S70 003 503	CONTROL COVER ASSY		1	1	1	1					
9	S70 E10 675	FAN GUARD		1	1	1	1					
10	S70 E00 202	ROOM TEMPERATURE THERMISTOR		1	1	1	1		TH1			
11	S70 512 716	TERMINAL BLOCK	2P (1, 2)	1	1	1	1		TB5			
	S70 E01 716	TERMINAL BLOCK	3P (S1, S2, S3)	1	1	1	1		TB4			
13	S70 17T 255	CAPACITOR	3.5μF 440V	1	1				C			
	S70 E02 255	CAPACITOR	7.0μF 440V			1	1		C			
14	S70 001 663	CORNER COVER		1	1	1	1					
15	S70 A48 524	DRAIN PLUG		1	1	1	1					
16	S70 A41 524	DRAIN PLUG		1	1	1	1					
17	S70 W29 527	DRAIN HOSE		1	1	1	1					

※ The part name of symbol "I.B" is "SPCB".

FUNCTIONAL PARTS

PLA-P5AA.UK, PLA-P6AA.UK
 PLA-P5AA1.UK, PLA-P6AA1.UK

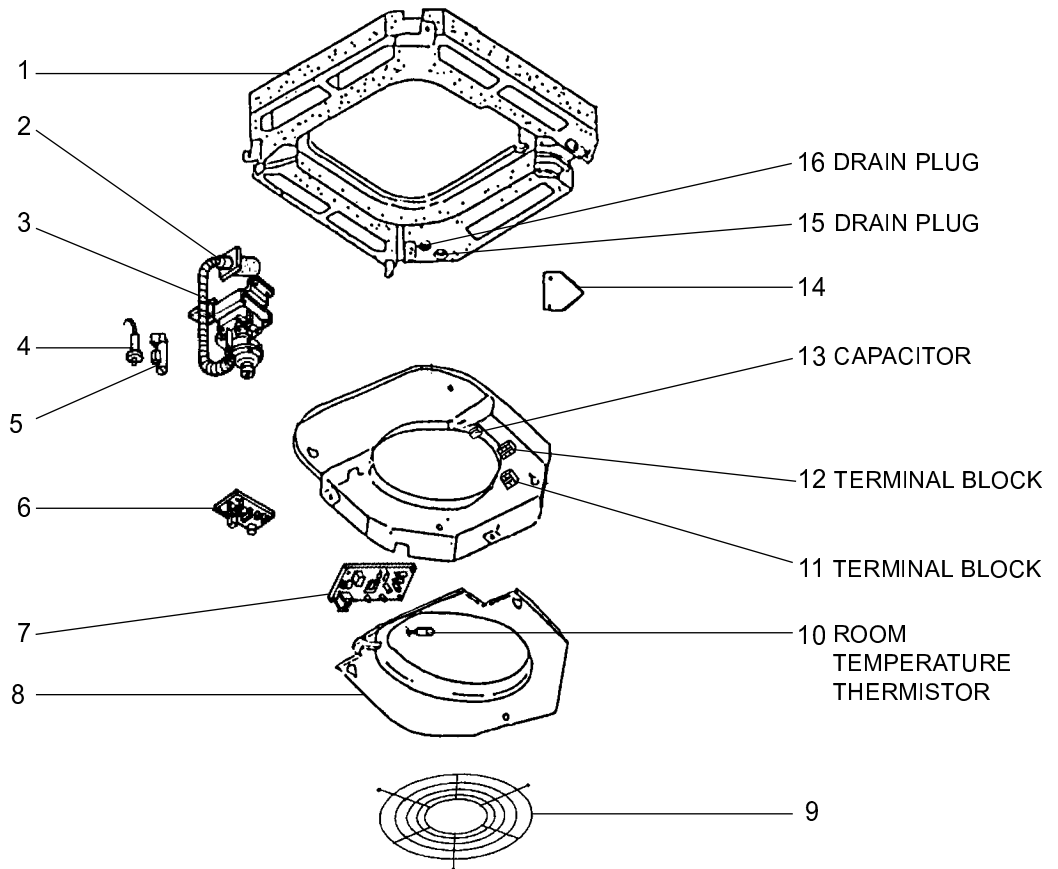

Part numbers that is circled is not shown in the figure.

No.	Parts No.	Parts Name	Specifi- cation	Q'ty / set				Remarks (Drawing No.)	Wiring Diagram Symbol	Recom- mended Q'ty	Price	
				PLA-P5		PLA-P6					Unit	Amount
				AA.UK	AA1.UK	AA.UK	AA1.UK					
1	S70 E00 529	DRAIN PAN		1	1							
	S70 E01 529	DRAIN PAN				1	1					
2	S70 29H 523	DRAIN SOCKET		1	1	1	1					
3	S70 E02 355	DRAIN PUMP		1	1	1	1		DP			
4	S70 E00 266	DRAIN SENSOR		1	1	1	1		DS			
5	S70 31K 241	DRAIN SENSOR HOLDER		1	1	1	1					
6	S70 E20 313	POWER BOARD		1	1	1	1		P.B			
7	S70 E20 310*	INDOOR CONTROLLER BOARD		1	1	1	1		I.B ※			
8	S70 003 503	CONTROL COVER ASSY		1	1	1	1					
9	S70 E10 675	FAN GUARD		1	1	1	1					
10	S70 E00 202	ROOM TEMPERATURE THERMISTOR		1	1	1	1		TH1			
11	S70 512 716	TERMINAL BLOCK	2P (1, 2)	1	1	1	1		TB5			
12	S70 E01 716	TERMINAL BLOCK	3P (S1, S2, S3)	1	1	1	1		TB4			
13	S70 E02 255	CAPACITOR	7.0μF 440V	1	1	1	1		C			
14	S70 001 663	CORNER COVER		1	1	1	1					
15	S70 A48 524	DRAIN PLUG		1	1	1	1					
16	S70 A41 524	DRAIN PLUG		1	1	1	1					
17	S70 W29 527	DRAIN HOSE		1	1	1	1					

※ The part name of symbol "I.B" is "SPCB".

1. Program timer (PLA-P3 / 4 / 5 / 6AA.UK)

Part No.	PAC-SC32PTA (with set back function)
Applied Service Ref.	PLA-P3 / 4 / 5 / 6AA.UK

1-1 Program timer specifications

Part name	Program timer
Parts No.	PAC-SC32PTA
Exterior dimensions (inch)	5-4/32X4-23/32X23/32 (130X120X18mm)
Installation	Wall mount
Type of clock	Quartz
Clock accuracy	± 50 second / month at 25°C
Display-Time	Liquid crystal display
-Week	Liquid crystal display
-Timer setting unit	Liquid crystal display
Program cycle	24 hours
Timer setting unit	30 minutes
No. of set points	48 / day
Power rating	5V DC ±5% (Supplied by Remote Controller)

1-2 Feature of program timer

(1) Daily timer function

Daily timer can be set in 30 minutes units for up to 24 hours.
Each unit can be set for unit ON, unit OFF, or setback operation.

(2) Setback operation

Set back operation is useful for reducing running costs
e.g. At a hotel with a 24-hour system

8:00~23:00 Cooling operation with set temperature at 26°C
23:00~8:00 Setback operation with 2 degrees of setback

As shown in the chart on the right, the set temperature rises 2 degrees automatically during the setback operation. When the setback operation ends, normal operation will begin.

(3) Weekly timer function

Daily timer function can apply to each day of the week.

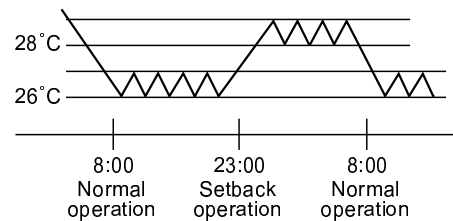

1-3. How to connect program timer

- (1) Install the program timer next to the remote controller the same way as the remote controller is installed.
- (2) Connect the program timer and the remote controller with a 5-wire cable as shown in the figure below

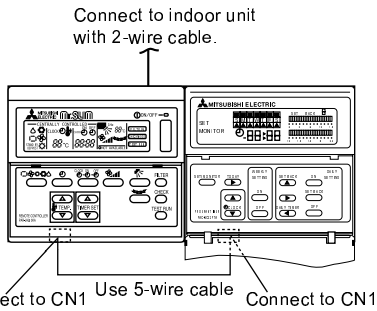

NOTE: While the program timer is connected to the remote controller, the 24hour ON/OFF timer on the remote controller will not operate.

1-4. Names and functions

<PAC-SC32PTA>

WEEKLY TIMER SETTING DISPLAY

Used for selection of if or not the day operation pattern set by PATTERN SETTING is to be applied in weekly day unit, setting.

CURRENT TIME DISPLAY

During MONITOR status, current time is display.
During Daily timer setting, a time desire for timer setting is displayed.

SET BACK DISPLAY

Indicates the setting set back range.

DAILY TIMER SETTING DISPLAY

24 hours is divided into 48 blocks and each block express 30 minutes.
The block display consists of 3 pattern.

SET/MONITOR DISPLAY

During SET is display, clock adjustment, change of weekly day, daily and weekly timer setting can be performed.
During MONITOR is display, all switches except SET/MONITOR SW are invalidated. This is normal status.

WEEK DAY SETTING SW

Used for week day setting.

MODE SELECTOR SW

Using this switch select "MONITOR" or "SET" Mode.

"MONITOR" :Indicates the current timer setting. All switch except MODE SELECTOR SW are invalidated then. This is the normal status.
"SET": Set to "SET" mode for clock adjustment, change of week day, daily and weekly timer setting.

CLOCK ADJUSTMENT SW

Used for adjustment of the current time.

Push SW to advance the time. Each time the button is pushed the time advance by 1 minute, pushing continuously advances by 1 minute at 0.5 second interval, and when the lower digit of minute becomes 0 indication advances in 10 minutes unit.

SW is used for reversing the time. Each time the button is pushed the time reverses by 1 minute, pushing continuously reverses the time by 1 minute at 0.5 second interval, and when the lower digit of minute becomes 0 indication reverses in 10 minutes unit.

SET BACK SETTING SW

Used for set back setting.

ON/SET BACK/OFF SW

Used to specify the time setting pattern.

DAILY TIMER SW

Used for timer setting in 30 minutes unit.

WEEKLY TIMER SW

Used for setting timer in day of week unit.

Pushing SW moves the week day light display in order of S → M → T → W ... enabling to set the week day.

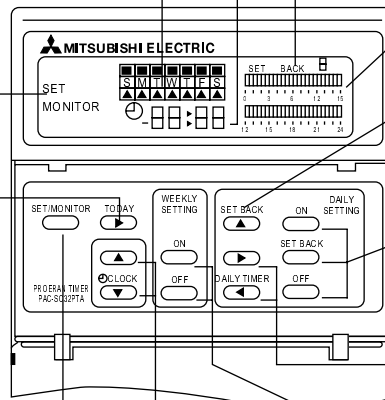

2. Program timer (PLA-P3 / 4 / 5 / 6AA₁.UK)

Part No.	PAC-YT32PTA
Applied Service Ref.	PLA-P3 / 4 / 5 / 6AA ₁ .UK

2-1 Names and functions

<PAC-YT32PTA>

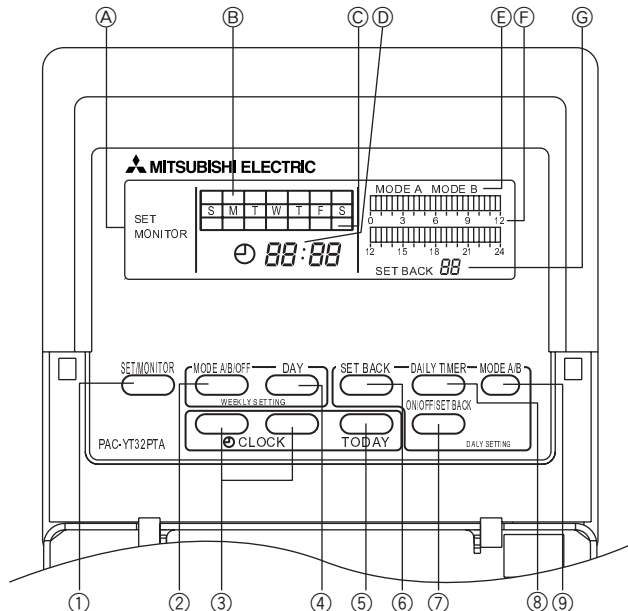

- A SET/MONITOR DISPLAY:**
When SET is displayed, clock adjustment, change of day, and daily and weekly timer settings can be performed. When MONITOR is displayed, all switches except SET/MONITOR SW are invalidated. This is normal status.
- B WEEKLY TIMER SETTING DISPLAY:**
Used to select whether the operation pattern set using the PATTERN SETTING can be applied to different days of the week.
- C CURRENT DAY DISPLAY:**
Indicates the current day.
- D CURRENT TIMEDISPLAY:**
During MONITOR status, current time is displayed.
During daily timer setting, a time desire for timer setting is displayed.
- E OPERATION MODE DISPLAY:**
Indicates the operation mode.
- F DAILY TIMER SETTING DISPLAY:**
24 hours is divided into 48 blocks and each block is expressed in 30 minutes.
The block display consists of 3 patterns.
- G SET BACK DISPLAY**
Indicates the set back value.
- 1 SET/MONITOR Button**
Using this switch, select "MONITOR" or "SET" Mode.
"MONITOR": Indicates the current timer setting. All switches except MODE SELECTOR SW are invalidated then. This is the normal status.
"SET": Set to "SET" mode for clock adjustment, change of day and daily and weekly timer settings.
- 2 MODE A/B/OFF Button**
Used for setting timer in day of week unit.
- 3 CLOCK ADJUSTMENT Button**
Used for adjustment of the current time.
Push [▲] SW to advance the time. Each time the button is pushed the time advances by 1 minute, pushing continuously advances by 1 minute at 0.5 second intervals, and when the lower digit of the minute becomes "0" the time advances in 10 minute units.
[▼] SW is used for reversing the time. Each time the button is pushed the time reverses by 1 minute, pushing continuously reverses the time by 1 minute at 0.5 second intervals, and when the lower digit of the minute becomes "0" the time reverses in 10 minute units.
- 4 DAY SETTING Button**
Used when setting the day.
- 5 WEEK DAY SETTING Button**
Used for week day setting.
Pushing [▶] SW moves the week day light display in order of S→M→T→W→... enabling to set the week day.
- 6 SET BACK SETTING Button**
Used for set back setting.
Set back can be done in the range of 1, 2, 4, 6 and 8°C (2, 4, 8, 12 and 16°F).
- 7 ON/OFF/SET BACK Button**
Used to specify the time setting pattern.
- 8 DAILY TIMER Button**
Used for timer setting in 30 minute units.
- 9 MODE A/B Button**
Used to set A Mode or B Mode when specifying the operation time.



3. Multi-Functional Casement

Part No.	PAC-SG03TM-E
Applied Service Ref.	PLA-P3/4/5/6AA.UK, PLA-P3/4/5/6AA1.UK

4. High-Efficiency Filter Element (2. Multi-Functional Casement is needed.)

Part No.	PAC-SG01KF
Applied Service Ref.	PLA-P3/4/5/6/AA.UK, PLA-P3/4/5/6AA1.UK

5. Grill + Wireless Remote Controller

Part No.	PLP-6AALA	PLP-6AALM
Applied Service Ref.	PLA-P3/4/5/6/AA.UK	PLA-P3/4/5/6/AA1.UK

6. Grill + Wired Remote Controller

Part No.	PLP-6AAA	PLP-6AAM
Applied Service Ref.	PLA-P3/4/5/6/AA.UK	PLA-P3/4/5/6/AA1.UK

7. Remote Sensor

Part No.	PAC-SE41TS-E
Applied Service Ref.	PLA-P3/4/5/6/AA.UK, PLA-P3/4/5/6AA1.UK

8. Remote Operation Adapter

Part No.	PAC-SF40RM-E
Applied Service Ref.	PLA-P3/4/5/6/AA.UK, PLA-P3/4/5/6AA1.UK

9. Remote ON/OFF Adapter

Part No.	PAC-SE55RA-E
Applied Service Ref.	PLA-P3/4/5/6/AA.UK, PLA-P3/4/5/6AA1.UK

10. Air Outlet Shutter Plate (20set , 2pcs/set)

Part No.	PAC-SG06SP-E
Applied Service Ref.	PLA-P3/4/5/6/AA.UK, PLA-P3/4/5/6AA1.UK

Mr. SLIM™

 **mitsubishi electric corporation**
HEAD OFFICE : MITSUBISHI DENKI BLDG., 2-2-3 MARUNOUCHI CHIYODA-KU, TOKYO 100-8310, JAPAN

©Copyright 2001 MITSUBISHI ELECTRIC ENGINEERING CO., LTD.
Distributed in Sep. 2004 No.OC241 REVISED EDITION-B PDF
Distributed in Sep. 2001 No.OC241 REVISED EDITION-A 350
Reprinted in Jul. 2001 No.OC241 50
Distributed in Apr. 2001 NO. OC241 225
Made in Japan

New publication, effective Sep. 2004
Specifications subject to change without notice