

# TECHNICAL & SERVICE MANUAL

## Series PMH Ceiling Cassettes R407C

**Indoor unit  
[Model names]**

PMH-P1BA

PMH-P1.6BA

PMH-P2BA

**[Service Ref.]**
**PMH-P1BA<sub>2</sub>**
**PMH-P1.6BA<sub>2</sub>**
**PMH-P2BA<sub>2</sub>**

- This service manual describes change points and parts list. Please refer to the OC238 REVISED EDITION-B as to excluding this manual.

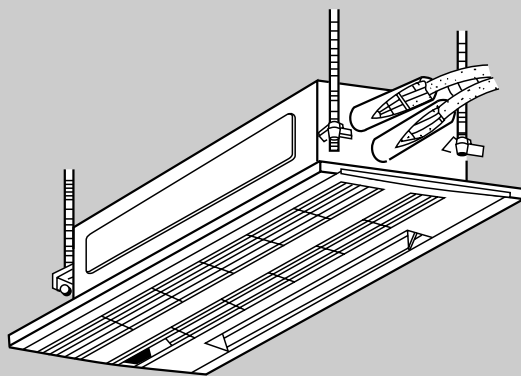
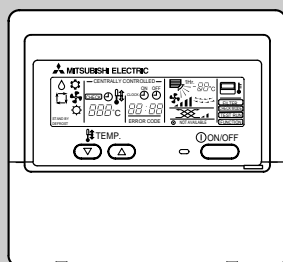
**INDOOR UNIT**

**REMOTE CONTROLLER**

### CONTENTS

|                            |   |
|----------------------------|---|
| 1. TECHNICAL CHANGES ..... | 3 |
| 2. SPECIFICATIONS .....    | 4 |
| 3. WIRING DIAGRAM.....     | 7 |
| 4. PARTS LIST .....        | 8 |



# 1

## TECHNICAL CHANGES

- The width dimension of indoor unit on **SPECIFICATIONS** is wrong.  
812(32) is the correct dimension.

|            |   |         |                           |                      |
|------------|---|---------|---------------------------|----------------------|
| Dimensions | W | mm(in.) | UNIT : <b>854(33-5/8)</b> | PANEL : 1000(39-3/8) |
|------------|---|---------|---------------------------|----------------------|



|            |   |         |                       |                      |
|------------|---|---------|-----------------------|----------------------|
| Dimensions | W | mm(in.) | UNIT : <b>812(32)</b> | PANEL : 1000(39-3/8) |
|------------|---|---------|-----------------------|----------------------|

- The compressor's model name of outdoor unit for PUH-P2YGAA.UK on the **SPECIFICATIONS** page is wrong.  
NE36YEJM is the correct model name

NE38YEJM → NE36YEJM

PMH-P1BA<sub>1</sub> → PMH-P1BA<sub>2</sub>  
PMH-P1.6BA<sub>1</sub> → PMH-P1.6BA<sub>2</sub>  
PMH-P2BA<sub>1</sub> → PMH-P2BA<sub>2</sub>

- INDOOR CONTROLLER BOARD (I.B) has changed.

[T7W E13 310] → [T7W E26 310]

- DRAIN PAN ASSY has changed.

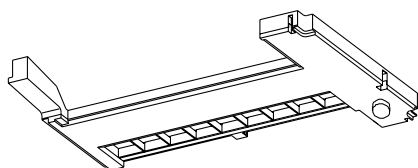

[R01 E04 529]

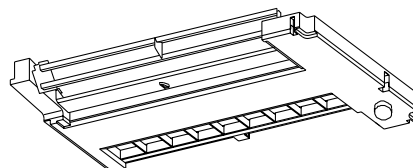

[R01 E10 529]

| Item                                 |                              | Service Ref.             | PMH-P1BA <sub>2</sub>  |                                  |
|--------------------------------------|------------------------------|--------------------------|--|----------------------------------|
| Function                             |                              |                          | Cooling  | Heating                          |
| Capacity                             |                              | Btu/h                    | 10,700   | 11,600                           |
|                                      |                              | W                        | 3,150  | 3,400                            |
| Total input                          |                              | kW                       | 1.15   | 1.06                             |
| <b>Service Ref.</b>                  |                              |                          | <b>PMH-P1BA<sub>2</sub></b>  |                                  |
| Power supply(phase, cycle, voltage)  |                              |                          | Single Phase, 50Hz, 220-230-240V   |                                  |
| Input                                |                              | kW                       | 0.04   | 0.04                             |
| Running current                      |                              | A                        | 0.19   | 0.19                             |
| Starting current                     |                              | A                        | 0.21   | 0.21                             |
| External finish                      |                              |                          | Unit : Galvanized sheets with gray heat insulation, Grille munsell 0.98Y 8.99/0.63 |                                  |
| Heat exchanger                       |                              |                          | Plate fin coil   |                                  |
| INDOOR UNIT                          | Fan                          |                          | Lineflow fan (direct) x 1  |                                  |
|                                      | Fan(drive) x No.             |                          |  |                                  |
|                                      | Fan motor output             |                          | kW   | 0.028                            |
|                                      | Airflow(Lo - Mi2 - Mi1 - Hi) |                          | m <sup>3</sup> /min(CFM)   | 6.3-6.8-7.6-8.4(222-240-268-297) |
|                                      | External static pressure     |                          | Pa(mmAq)   | 0(direct blow)                   |
| Operation control & Thermostat       |                              |                          | Remote controller & built-in   |                                  |
| Noise level(Lo - Mi2 - Mi1 - Hi)     |                              | dB                       | 29-31-33-35  |                                  |
| Unit drain pipe I.D.                 |                              | mm(in.)                  | 26(1)  |                                  |
| Dimensions                           |                              | W                        | UNIT : 812(32) PANEL : 1000(39-3/8)  |                                  |
|                                      |                              | D                        | UNIT : 395(15-9/16) PANEL : 470(18-1/2)  |                                  |
|                                      |                              | H                        | UNIT : 230(9-1/16) PANEL : 30(1-3/16)  |                                  |
| Weight                               |                              | kg(lbs)                  | UNIT : 14(31) PANEL : 3.0(6.6)   |                                  |
| <b>Service Ref.</b>                  |                              |                          | <b>PUH-P1VGAA.UK</b>   |                                  |
| Power supply (phase, cycle, voltage) |                              |                          | Single Phase, 50Hz, 220-230-240V   |                                  |
| Running current                      |                              | A                        | 4.92   | 4.52                             |
| Starting current                     |                              | A                        | 30   |                                  |
| External finish                      |                              |                          | Munsell 5Y 7/1   |                                  |
| Refrigerant control                  |                              |                          | Linear Expansion Valve   |                                  |
| Compressor                           |                              |                          | Hermetic   |                                  |
| Model                                |                              |                          | RE189VHSMT   |                                  |
| Motor output                         |                              | kW                       | 0.85   |                                  |
| Starter type                         |                              |                          | Line start   |                                  |
| Protection devices                   |                              |                          | Inner thermostat, HP switch, Discharge thermo.                                     |                                  |
| Crankcase heater                     |                              | W                        | 30   |                                  |
| Heat exchanger                       |                              |                          | Plate fin coil   |                                  |
| OUTDOOR UNIT                         | Fan                          |                          | Propeller (direct) x 1   |                                  |
|                                      | Fan(drive) x No.             |                          |  |                                  |
|                                      | Fan motor output             |                          | kW   | 0.070                            |
| Airflow                              |                              | m <sup>3</sup> /min(CFM) | 45(1,590)  |                                  |
| Defrost method                       |                              |                          | Reverse cycle  |                                  |
| Noise level                          |                              | Cooling                  | dB   |                                  |
|                                      |                              | Heating                  | dB   |                                  |
| Dimensions                           |                              | W                        | 900(35-7/16)   |                                  |
|                                      |                              | D                        | 330+20(13+3/4)   |                                  |
|                                      |                              | H                        | 650(25-5/8)  |                                  |
| Weight                               |                              | kg(lbs)                  | 50(110)  |                                  |
| Refrigerant                          |                              |                          | R407C  |                                  |
| Charge                               |                              | kg(lbs)                  | 1.7(3.7)   |                                  |
| Oil (Model)                          |                              | L                        | 0.57(Ester)MEL56   |                                  |
| Pipe size O.D.                       |                              | Liquid                   | mm(in.)  |                                  |
|                                      |                              | Gas                      | mm(in.)  |                                  |
| Connection method                    |                              | Indoor side              | Flared   |                                  |
|                                      |                              | Outdoor side             | Flared   |                                  |
| Between the indoor & outdoor unit    |                              | Height difference        | Max. 30m   |                                  |
|                                      |                              | Piping length            | Max. 30m   |                                  |
| REFRIGERANT PIPING                   | Refrigerant                  |                          | R407C  |                                  |
|                                      | Charge                       |                          | kg(lbs)  |                                  |
|                                      | Oil (Model)                  |                          | L  |                                  |
|                                      | Pipe size O.D.               |                          | mm(in.)  |                                  |
| Connection method                    |                              | Indoor side              |  |                                  |
| Between the indoor & outdoor unit    |                              | Height difference        |  |                                  |

## Notes1. Rating Conditions (ISO T1)

Cooling....Indoor : D.B. 27°C(80°F), W.B. 19°C (66°F)

Heating....Indoor : D.B. 20°C(68°F)

Refrigerant piping length (one way) : 5m (16ft)

Outdoor : D.B. 35°C(95°F), W.B. 24°C (75°F)

Outdoor : D.B. 7°C(45°F), W.B. 6°C (43°F)

## 2. Guaranteed operating range

|         |             | Indoor    |             | Outdoor               |
|---------|-------------|-----------|-------------|-----------------------|
| Cooling | Upper limit | D.B. 35°C | W.B. 22.5°C | D.B. 46°C             |
|         | Lower limit | D.B. 19°C | W.B. 15°C   | D.B. -5°C             |
| Heating | Upper limit | D.B. 28°C |             | D.B. 24°C W.B. 18°C   |
|         | Lower limit | D.B. 17°C |             | D.B. -11°C W.B. -12°C |

## 3. Above data based on indicated voltage

Indoor Unit Single phase 240V 50Hz  
Outdoor Unit Single phase 240V 50Hz



| Item                              |                                      | Service Ref.             | PMH-P1.6BA <sub>2</sub>  |                                     |   |                                     |      |
|-----------------------------------|--------------------------------------|--------------------------|--|-------------------------------------|---|-------------------------------------|------|
| Function                          |                                      |                          | Cooling  |                                     | Heating                                 |                                     |      |
| Capacity                          |                                      | Btu/h                    | 15,000   |                                     | 17,100                                  |                                     |      |
|                                   |                                      | W                        | 4,400  |                                     | 5,000                                   |                                     |      |
| Total input                       |                                      | kW                       | 1.65   |                                     | 1.70                                    |                                     |      |
| INDOOR UNIT                       | <b>Service Ref.</b>                  |                          | <b>PMH-P1.6BA<sub>2</sub></b>  |                                     |   |                                     |      |
|                                   | Power supply(phase, cycle, voltage)  |                          | Single Phase, 50Hz, 220-230-240V   |                                     |   |                                     |      |
|                                   | Input                                |                          | kW   | 0.06                                |   | 0.06                                |      |
|                                   | Running current                      |                          | A  | 0.29                                |   | 0.29                                |      |
|                                   | Starting current                     |                          | A  | 0.32                                |   | 0.32                                |      |
|                                   | External finish                      |                          | Unit : Galvanized sheets with gray heat insulation, Grille munsell 0.98Y 8.99/0.63 |                                     |   |                                     |      |
|                                   | Heat exchanger                       |                          | Plate fin coil   |                                     |   |                                     |      |
|                                   | Fan                                  |                          | Lineflow fan (direct) x 1  |                                     |   |                                     |      |
|                                   | Fan(drive) x No.                     |                          |  |                                     |   |                                     |      |
|                                   | Fan motor output                     |                          | kW   | 0.028                               |   |                                     |      |
|                                   | Airflow(Lo - Mi2- Mi1 - Hi)          |                          | m <sup>3</sup> /min(CFM)   | 7.0-8.0-9.0-10.0(247-282-318-353)   |   |                                     |      |
|                                   | External static pressure             |                          | Pa(mmAq)   | 0(direct blow)                      |   |                                     |      |
|                                   | Operation control & Thermostat       |                          | Remote controller & built-in   |                                     |   |                                     |      |
|                                   | Noise level(Lo - Mi2 - Mi1 - Hi)     |                          | dB   | 34-36-38-40                         |   |                                     |      |
|                                   | Unit drain pipe I.D.                 |                          | mm(in.)  | 26(1)                               |   |                                     |      |
| Dimensions                        |                                      | W                        | mm(in.)  |                                     | UNIT : 812(32) PANEL : 1000(39-3/8)     |                                     |      |
|                                   |                                      | D                        | mm(in.)  |                                     | UNIT : 395(15-9/16) PANEL : 470(18-1/2) |                                     |      |
|                                   |                                      | H                        | mm(in.)  |                                     | UNIT : 230(9-1/16) PANEL : 30(1-3/16)   |                                     |      |
| Weight                            |                                      | kg(lbs)                  | UNIT : 14(31) PANEL : 3.0(6.6)   |                                     |   |                                     |      |
| OUTDOOR UNIT                      | <b>Service Ref.</b>                  |                          | <b>PUH-P1.6VGAA.UK</b>   | <b>PUH-P1.6YGAA.UK</b>              | <b>PUH-P1.6VGAA.UK</b>                  | <b>PUH-P1.6YGAA.UK</b>              |      |
|                                   | Power supply (phase, cycle, voltage) |                          | Single Phase, 50Hz, 220-230-240V   | 3 phase, 50Hz, 380-400-415V(4wires) | Single Phase, 50Hz, 220-230-240V        | 3 phase, 50Hz, 380-400-415V(4wires) |      |
|                                   | Running current                      |                          | A  | 7.36                                | 2.49                                    | 7.59                                | 2.56 |
|                                   | Starting current                     |                          | A  | 36                                  | 20                                      | 36                                  | 20   |
|                                   | External finish                      |                          | Munsell 5Y 7/1   |                                     |   |                                     |      |
|                                   | Refrigerant control                  |                          | Linear Expansion Valve   |                                     |   |                                     |      |
|                                   | Compressor                           |                          | Hermetic   |                                     |   |                                     |      |
|                                   | Model                                |                          | RE277VHSMT   | RE277YFKM                           | RE277VHSMT                              | RE277YFKM                           |      |
|                                   | Motor output                         |                          | kW   | 1.3                                 |   |                                     |      |
|                                   | Starter type                         |                          | Line start   |                                     |   |                                     |      |
|                                   | Protection devices                   |                          | *1   | *2                                  | *1                                      | *2                                  |      |
|                                   | Crankcase heater                     |                          | W  | 30                                  |   |                                     |      |
|                                   | Heat exchanger                       |                          | Plate fin coil   |                                     |   |                                     |      |
|                                   | Fan                                  |                          | Propeller (direct) x 1   |                                     |   |                                     |      |
|                                   | Fan(drive) x No.                     |                          |  |                                     |   |                                     |      |
| Fan motor output                  |                                      | kW                       | 0.070  |                                     |   |                                     |      |
| Airflow                           |                                      | m <sup>3</sup> /min(CFM) | 45(1,590)  |                                     |   |                                     |      |
| Defrost method                    |                                      | Reverse cycle            |  |                                     |   |                                     |      |
| Noise level                       |                                      | Cooling                  | dB   |                                     | 47                                      |                                     |      |
|                                   |                                      | Heating                  | dB   |                                     | 49                                      |                                     |      |
| Dimensions                        |                                      | W                        | mm(in.)  |                                     | 900(35-7/16)                            |                                     |      |
|                                   |                                      | D                        | mm(in.)  |                                     | 330+20(13+3/4)                          |                                     |      |
|                                   |                                      | H                        | mm(in.)  |                                     | 650(25-5/8)                             |                                     |      |
| Weight                            |                                      | kg(lbs)                  | 54(119)  |                                     |   |                                     |      |
| REFRIGERANT PIPING                | Refrigerant                          |                          | R407C  |                                     |   |                                     |      |
|                                   | Charge                               |                          | kg(lbs)  |                                     |   |                                     |      |
|                                   | Oil (Model)                          |                          | L  |                                     |   |                                     |      |
|                                   |                                      |                          | 0.57(Ester)MEL56   |                                     |   |                                     |      |
|                                   | Pipe size O.D.                       |                          | Liquid   | mm(in.)                             |   | 9.52(3/8)                           |      |
|                                   |                                      |                          | Gas  | mm(in.)                             |   | 15.88(5/8)                          |      |
|                                   | Connection method                    |                          | Indoor side  | Flared                              |   |                                     |      |
|                                   |                                      | Outdoor side             | Flared   |                                     |   |                                     |      |
| Between the indoor & outdoor unit |                                      | Height difference        | Max. 40m   |                                     |   |                                     |      |
|                                   |                                      | Piping length            | Max. 40m   |                                     |   |                                     |      |

Notes1. Rating Conditions (ISO T1)

Cooling...Indoor : D.B. 27°C(80°F), W.B. 19°C (66°F)  
 Heating...Indoor : D.B. 20°C(68°F)  
 Refrigerant piping length (one way) : 5m (16ft)

Outdoor : D.B. 35°C(95°F), W.B. 24°C (75°F)  
 Outdoor : D.B. 7°C(45°F), W.B. 6°C (43°F)

2. Guaranteed operating range

|         |             | Indoor    |             | Outdoor               |  |
|---------|-------------|-----------|-------------|-----------------------|--|
| Cooling | Upper limit | D.B. 35°C | W.B. 22.5°C | D.B. 46°C             |  |
|         | Lower limit | D.B. 19°C | W.B. 15°C   | D.B. -5°C             |  |
| Heating | Upper limit | D.B. 28°C |             | D.B. 24°C W.B. 18°C   |  |
|         | Lower limit | D.B. 17°C |             | D.B. -11°C W.B. -12°C |  |

3. Above data based on indicated voltage

Indoor Unit Single phase 240V 50Hz  
 Outdoor Unit Single phase 240V 50Hz  
 3 phase 415V 50Hz

\*1: Inner thermostat, HP switch, Discharge thermo.

\*2: Thermal relay, Discharge thermo, HP switch, Anti-phase protector.



| Item                                 |                              | Service Ref. | PMH-P2BA <sub>2</sub>  |                                     |                                  |                                     |
|--------------------------------------|------------------------------|--------------|--|-------------------------------------|----------------------------------|-------------------------------------|
| Function                             |                              |              | Cooling  |                                     | Heating                          |                                     |
| Capacity                             |                              | Btu/h        | 18,400   |                                     | 21,450                           |                                     |
|                                      |                              | W            | 5,400  |                                     | 6,250                            |                                     |
| Total input                          |                              | kW           | 2.35   |                                     | 2.42                             |                                     |
| <b>Service Ref.</b>                  |                              |              | <b>PMH-P2BA<sub>2</sub></b>  |                                     |                                  |                                     |
| Power supply(phase, cycle, voltage)  |                              |              | SinglePhase, 50Hz, 220-230-240V  |                                     |                                  |                                     |
| INDOOR UNIT                          | Input                        | kW           | 0.06   |                                     | 0.06                             |                                     |
|                                      | Running current              | A            | 0.29   |                                     | 0.29                             |                                     |
|                                      | Starting current             | A            | 0.32   |                                     | 0.32                             |                                     |
| External finish                      |                              |              | Unit : Galvanized sheets with gray heat insulation, Grille munsell 0.98Y 8.99/0.63 |                                     |                                  |                                     |
| Heat exchanger                       |                              |              | Plate fin coil   |                                     |                                  |                                     |
| Fan                                  | Fan(drive) x No.             |              | Lineflow fan (direct) x 1  |                                     |                                  |                                     |
|                                      | Fan motor output             |              | 0.028  |                                     |                                  |                                     |
|                                      | Airflow(Lo - Mi2 - Mi1 - Hi) |              | m <sup>3</sup> /min(CFM) 8.0-9.0-10.0-11.0(282-318-353-388)                        |                                     |                                  |                                     |
|                                      | External static pressure     |              | Pa(mmAq) 0(direct blow)  |                                     |                                  |                                     |
| Operation control & Thermostat       |                              |              | Remote controller & built-in   |                                     |                                  |                                     |
| Noise level(Lo - Mi2 - Mi1 - Hi)     |                              | dB           | 36-38-40-42  |                                     |                                  |                                     |
| Unit drain pipe I.D.                 |                              | mm(in.)      | 26(1)  |                                     |                                  |                                     |
| Dimensions                           | W                            | mm(in.)      | UNIT : 812(32)   |                                     | PANEL : 1000(39-3/8)             |                                     |
|                                      | D                            | mm(in.)      | UNIT : 395(15-9/16)  |                                     | PANEL : 470(18-1/2)              |                                     |
|                                      | H                            | mm(in.)      | UNIT : 230(9-1/16)   |                                     | PANEL : 30(1-3/16)               |                                     |
| Weight                               |                              | kg(lbs)      | UNIT : 14(31)  |                                     | PANEL : 3.0(6.6)                 |                                     |
| <b>Service Ref.</b>                  |                              |              | <b>PUH-P2VGAA.UK</b>   | <b>PUH-P2YGAA.UK</b>                | <b>PUH-P2VGAA.UK</b>             | <b>PUH-P2YGAA.UK</b>                |
| Power supply (phase, cycle, voltage) |                              |              | Single Phase, 50Hz, 220-230-240V   | 3 phase, 50Hz, 380-400-415V(4wires) | Single Phase, 50Hz, 220-230-240V | 3 phase, 50Hz, 380-400-415V(4wires) |
| Running current                      | A                            |              | 10.26  | 3.70                                | 10.57                            | 3.82                                |
|                                      | A                            |              | 62   | 31                                  | 62                               | 31                                  |
| External finish                      |                              |              | Munsell 5Y 7/1   |                                     |                                  |                                     |
| Refrigerant control                  |                              |              | Linear Expansion Valve   |                                     |                                  |                                     |
| Compressor                           |                              |              | Hermetic   |                                     |                                  |                                     |
| Model                                |                              |              | NE36VMJMT  | NE36YEJM                            | NE36VMJMT                        | NE36YEJM                            |
| Motor output                         |                              | kW           | 1.6  |                                     |                                  |                                     |
| Starter type                         |                              |              | Line start   |                                     |                                  |                                     |
| Protection devices                   |                              |              | *1   | *2                                  | *1                               | *2                                  |
| Crankcase heater                     |                              | W            | 38   |                                     |                                  |                                     |
| Heat exchanger                       |                              |              | Plate fin coil   |                                     |                                  |                                     |
| Fan                                  | Fan(drive) x No.             |              | Propeller (direct) x 1   |                                     |                                  |                                     |
|                                      | Fan motor output             |              | 0.070  |                                     |                                  |                                     |
|                                      | Airflow                      |              | m <sup>3</sup> /min(CFM) 55(1,940)   |                                     |                                  |                                     |
| Defrost method                       |                              |              | Reverse cycle  |                                     |                                  |                                     |
| Noise level                          | Cooling                      | dB           | 48   |                                     |                                  |                                     |
|                                      | Heating                      | dB           | 50   |                                     |                                  |                                     |
| Dimensions                           | W                            | mm(in.)      | 900(35-7/16)   |                                     |                                  |                                     |
|                                      | D                            | mm(in.)      | 330+20(13+3/4)   |                                     |                                  |                                     |
|                                      | H                            | mm(in.)      | 855(33-5/8)  |                                     |                                  |                                     |
| Weight                               |                              | kg(lbs)      | 74(163)  |                                     |                                  |                                     |
| Refrigerant                          |                              |              | R407C  |                                     |                                  |                                     |
| Charge                               |                              | kg(lbs)      | 2.6(5.7)   |                                     |                                  |                                     |
| Oil (Model)                          |                              | L            | 1.2(Ester)MEL56  |                                     |                                  |                                     |
| Pipe size O.D.                       | Liquid                       | mm(in.)      | 9.52(3/8)  |                                     |                                  |                                     |
|                                      | Gas                          | mm(in.)      | 15.88(5/8)   |                                     |                                  |                                     |
| Connection method                    |                              | Indoor side  | Flared   |                                     |                                  |                                     |
|                                      |                              | Outdoor side | Flared   |                                     |                                  |                                     |
| Between the indoor & outdoor unit    | Height difference            |              | Max. 40m   |                                     |                                  |                                     |
|                                      | Piping length                |              | Max. 40m   |                                     |                                  |                                     |

Notes1. Rating Conditions (ISO T1)

Cooling---Indoor : D.B. 27°C(80°F), W.B. 19°C (66°F)      Outdoor : D.B. 35°C(95°F), W.B. 24°C (75°F)  
 Heating---Indoor : D.B. 20°C(68°F)      Outdoor : D.B. 7°C(45°F), W.B. 6°C (43°F)  
 Refrigerant piping length (one way) : 5m (16ft)

2. Guaranteed operating range

|         |             | Indoor    |             | Outdoor               |  |
|---------|-------------|-----------|-------------|-----------------------|--|
| Cooling | Upper limit | D.B. 35°C | W.B. 22.5°C | D.B. 46°C             |  |
|         | Lower limit | D.B. 19°C | W.B. 15°C   | D.B. -5°C             |  |
| Heating | Upper limit | D.B. 28°C |             | D.B. 24°C W.B. 18°C   |  |
|         | Lower limit | D.B. 17°C |             | D.B. -11°C W.B. -12°C |  |

3. Above data based on indicated voltage

Indoor Unit      Single phase 240V 50Hz  
 Outdoor Unit    Single phase 240V 50Hz  
                          3 phase 415V 50Hz

\*1: Inner thermostat, HP switch, Discharge thermo.

\*2: Thermal relay, Discharge thermo, HP switch, Anti-phase protector.

PMH-P1BA<sub>2</sub>, PMH-P1.6BA<sub>2</sub>, PMH-P2BA<sub>2</sub>

[LEGEND]

| SYMBOL | NAME  |
|--------|---|
| I.B    | INDOOR CONTROLLER BOARD   |
| CN2L   | CONNECTOR (LOSSNAY)   |
| CN32   | CONNECTOR (REMOTE SWITCH)   |
| CN41   | CONNECTOR (HA TERMINAL-A)   |
| FUSE   | FUSE (6.3A, 250V)   |
| LED1   | POWER SUPPLY (I.B)  |
| LED2   | POWER SUPPLY (R.B)  |
| LED3   | TRANSMISSION (INDOOR-OUTDOOR)   |
| SW1    | JUMPER WIRE (MODEL SELECTION)   |
| SW2    | JUMPER WIRE (CAPACITY CODE)   |
| SWE    | SWITCH (EMERGENCY OPERATION)  |
| T      | TRANSFORMER   |
| X1     | RELAY (DRAIN PUMP)  |
| ZNR    | VARISTOR  |
| R.B    | REMOTE CONTROLLER BOARD   |
| CN2    | CONNECTOR (PROGRAM TIMER)   |
| TB6    | TERMINAL BLOCK (REMOTE CONTROLLER TRANSMISSION LINE)                      |
| DP     | DRAIN-UP MACHINE  |
| DS     | DRAIN SENSOR  |
| MF     | FAN MOTOR   |
| MV     | VANE MOTOR  |
| TB4    | TERMINAL BLOCK (INDOOR/OUTDOOR CONNECTING LINE)                           |
| TB5    | TERMINAL BLOCK (REMOTE CONTROL TRANSMISSION LINE)                         |
| TH1    | ROOM TEMPERATURE THERMISTOR (0°C/15KΩ, 25°C/5.4KΩ DETECT)                 |
| TH2    | PIPE TEMPERATURE THERMISTOR/LIQUID (0°C/15KΩ, 25°C/5.4KΩ DETECT)          |
| TH5    | CONDENSER/EVAPORATOR TEMPERATURE THERMISTOR (0°C/15KΩ, 25°C/5.4KΩ DETECT) |

NOTES:

1. Since the outdoor side electric wiring may change be sure to check the outdoor unit electric wiring for servicing.
2. Indoor and outdoor connecting wires are made with polarities, make wiring matching terminal numbers (S1, S2, S3).
3. Symbols used in wiring diagram above are, □:Connector, ⊙:Terminal (block).

Please set the voltage using the remote controller.  
For the setting method, please refer to the indoor unit Installation Manual.

<※1>

|     | MODELS                      | Manufacture         | Service board |
|-----|-----------------------------|---------------------|---------------|
| SW1 | PMH-P1/1.6/2BA <sub>2</sub> | J11 J12 J13 J14 J15 | <br>ON OFF    |
| SW2 | PMH-P1BA <sub>2</sub>       | J21 J22 J23 J24     | <br>ON OFF    |
|     | PMH-P1.6BA <sub>2</sub>     | J21 J22 J23 J24     | <br>ON OFF    |
|     | PMH-P2BA <sub>2</sub>       | J21 J22 J23 J24     | <br>ON OFF    |

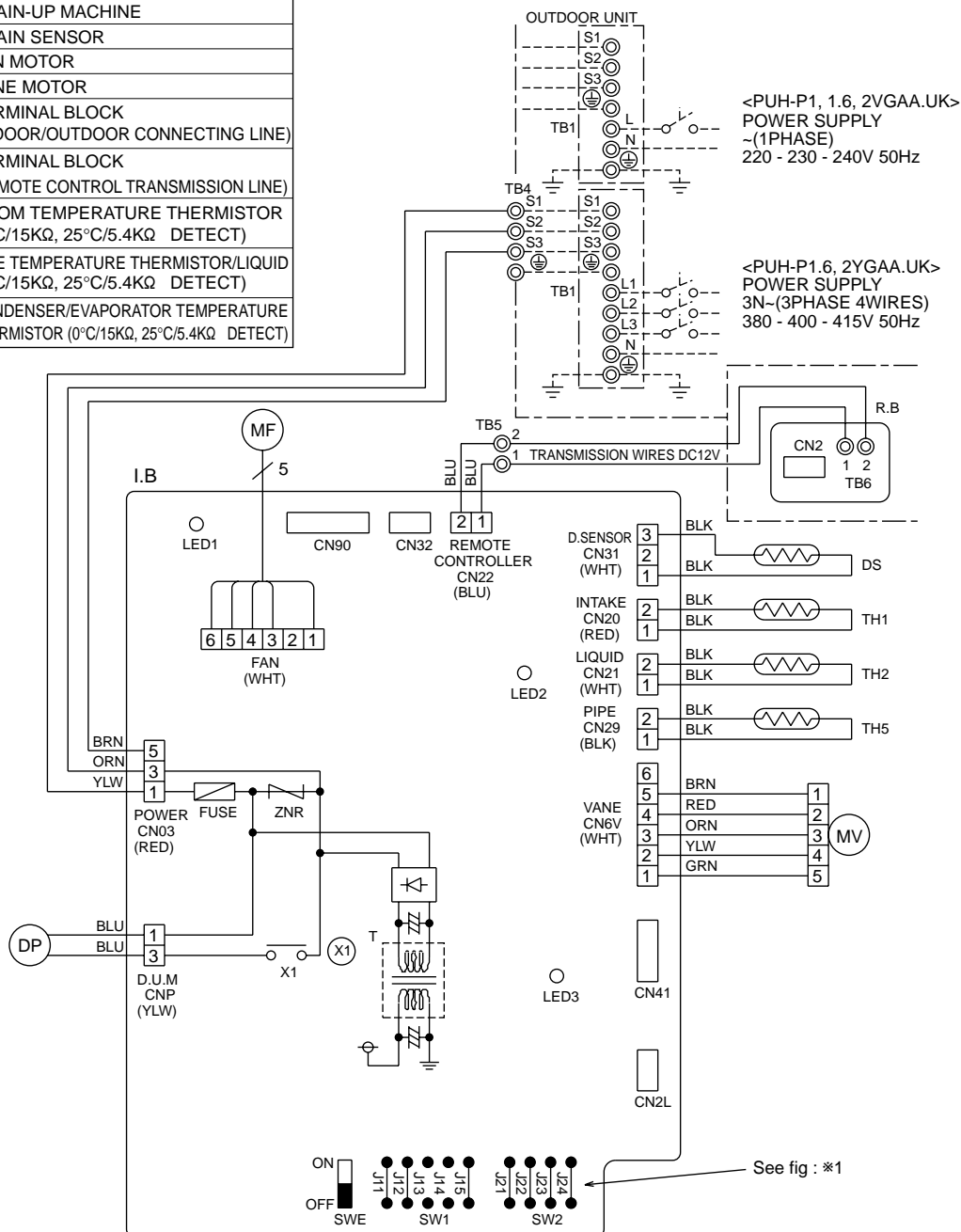

## PANEL PARTS

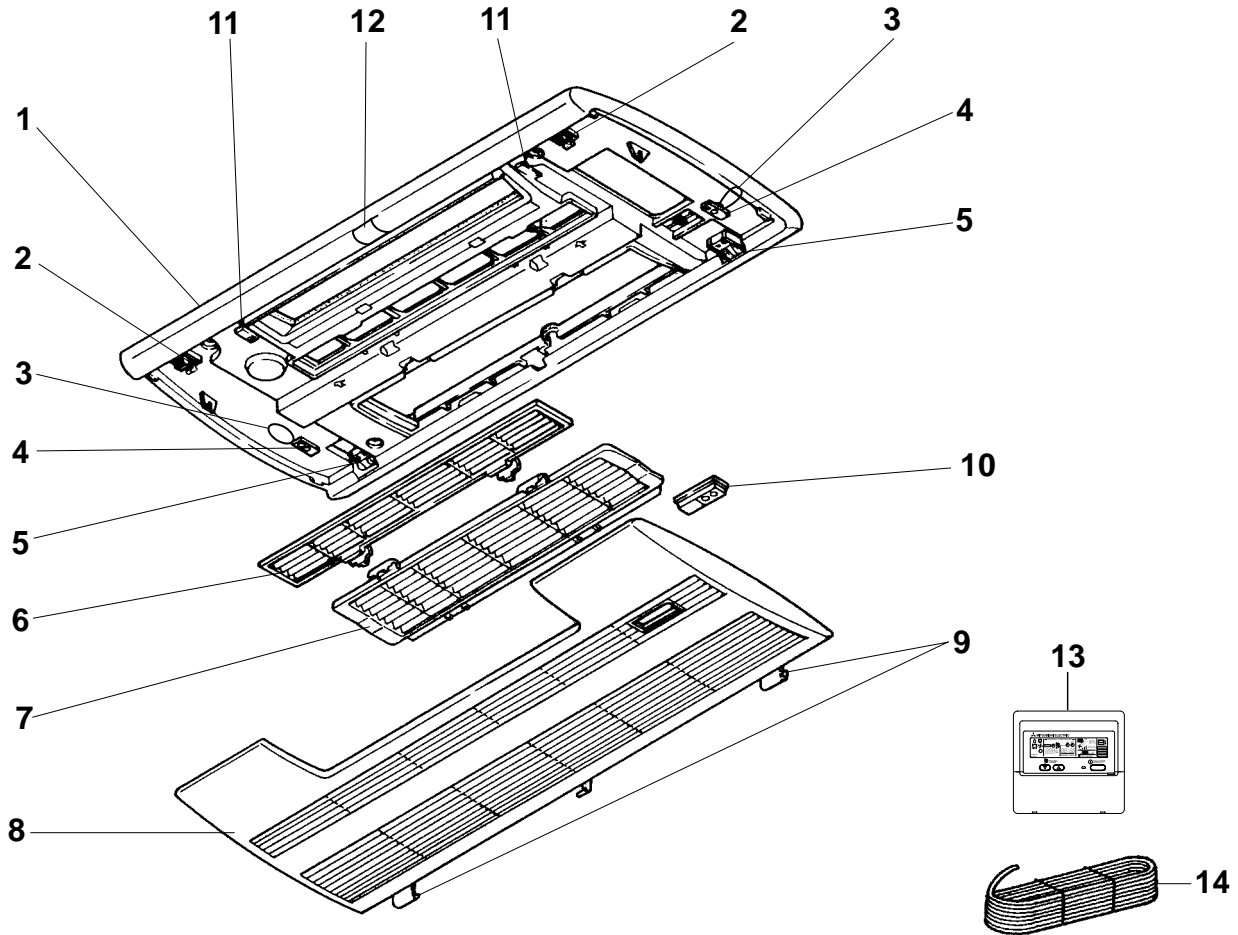
PMH-P1BA<sub>2</sub>PMH-P1.6BA<sub>2</sub>PMH-P2BA<sub>2</sub>

| No. | Part No.    | Part Name               | Specification | Q'ty/set                        | Remarks<br>(Drawing No.) | Wiring<br>Diagram<br>Symbol | Recom-<br>mended<br>Q'ty | Price |        |
|-----|-------------|-------------------------|---------------|---------------------------------|--------------------------|-----------------------------|--------------------------|-------|--------|
|     |             |                         |               | PMH-P1,1.6,2<br>BA <sub>2</sub> |                          |                             |                          | Unit  | Amount |
| 1   | T7W E11 003 | AIR OUTLET GRILLE       |               | 1                               |                          |                             |                          |       |        |
| 2   | R01 E00 055 | LATCH                   |               | 2                               |                          |                             |                          |       |        |
| 3   | —           | HANGER                  |               | 2                               | (DT88D360H03)            |                             |                          |       |        |
| 4   | R01 E00 099 | PANEL HOOK              |               | 2                               |                          |                             |                          |       |        |
| 5   | R01 E01 054 | GRILLE CATCH            |               | 2                               |                          |                             |                          |       |        |
| 6   | R01 E01 500 | LL.FILTER               |               | 1                               |                          |                             |                          |       |        |
| 7   | R01 E02 500 | LL.FILTER               |               | 1                               |                          |                             |                          |       |        |
| 8   | T7W E01 691 | INTAKE GRILLE           |               | 1                               |                          |                             |                          |       |        |
| 9   | R01 E00 054 | GRILLE CATCH            |               | 2                               |                          |                             |                          |       |        |
| 10  | R01 E00 648 | RECEIVER COVER          |               | 1                               |                          |                             |                          |       |        |
| 11  | R01 E00 044 | MAGNET                  |               | 2                               |                          |                             |                          |       |        |
| 12  | R01 E00 096 | SCREW CAP               |               | 1                               |                          |                             |                          |       |        |
| 13  | T7W E06 713 | REMOTE CONTROLLER       |               | 1                               |                          |                             |                          |       |        |
| 14  | T7W A00 305 | REMOTE CONTROLLER CABLE |               | 1                               |                          |                             |                          |       |        |



## FUNCTIONAL PARTS

PMH-P1BA<sub>2</sub>  
PMH-P1.6BA<sub>2</sub>  
PMH-P2BA<sub>2</sub>

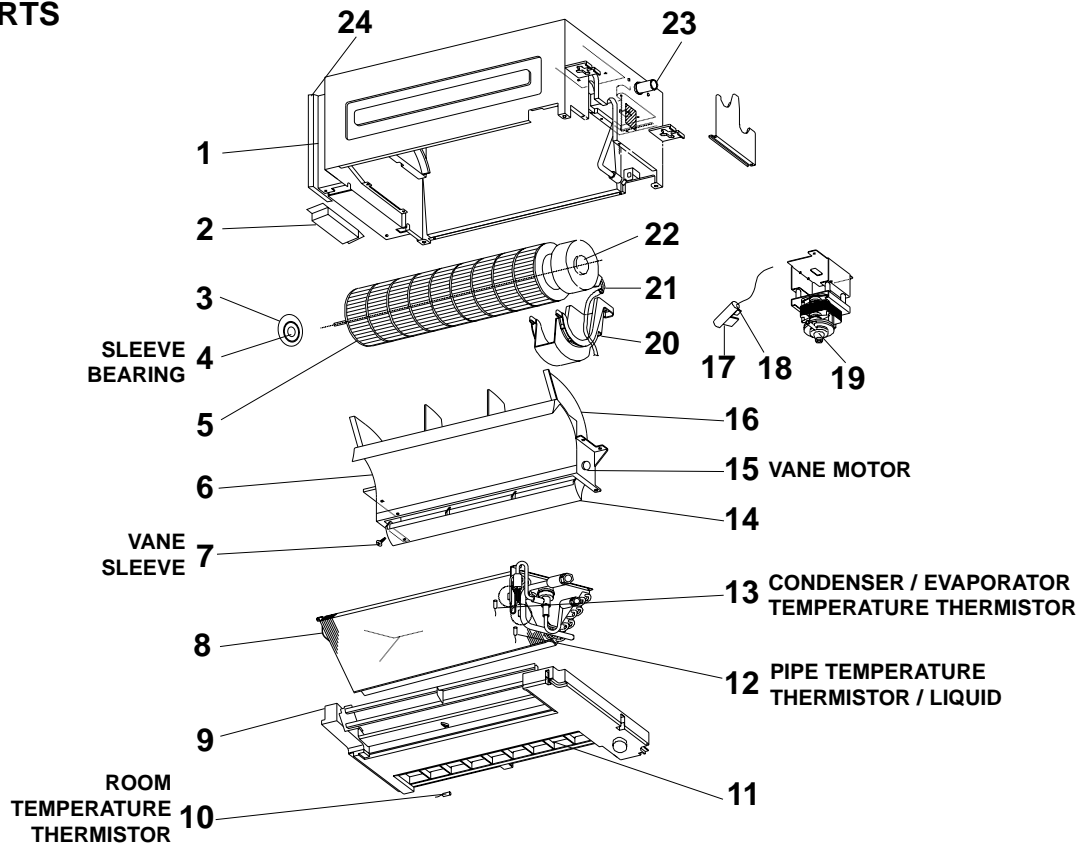

Part number that is circled is not shown in the figure.

| No. | Part No.    | Part Name                                     | Specification | Q'ty/set              |   |   | Remarks<br>(Drawing No.) | Wiring<br>Diagram<br>Symbol | Recom-<br>mended<br>Q'ty | Price |        |
|-----|-------------|---|---------------|-----------------------|---|---|--------------------------|-----------------------------|--------------------------|-------|--------|
|     |             |   |               | PMH-P-BA <sub>2</sub> |   |   |                          |                             |                          | Unit  | Amount |
| 1   | —           | CABINET                                       |               | 1                     | 1 | 1 | (DT00A478G78)            |                             |                          |       |        |
| 2   | —           | COVER   |               | 1                     | 1 | 1 | (RG02L277H02)            |                             |                          |       |        |
| 3   | R01 22A 102 | BEARING MOUNT                                 |               | 1                     | 1 | 1 |                          |                             |                          |       |        |
| 4   | R01 005 103 | SLEEVE BEARING                                |               | 1                     | 1 | 1 |                          |                             |                          |       |        |
| 5   | R01 E02 114 | LINE FLOW FAN                                 |               | 1                     | 1 | 1 |                          |                             |                          |       |        |
| 6   | R01 E00 079 | STABILIZER ASSY                               |               | 1                     | 1 | 1 |                          |                             |                          |       |        |
| 7   | R01 E00 092 | VANE SLEEVE                                   |               | 1                     | 1 | 1 |                          |                             |                          |       |        |
| 8   | T7W E69 480 | HEAT EXCHANGER                                |               | 1                     |   |   |                          |                             |                          |       |        |
|     | T7W E70 480 | HEAT EXCHANGER                                |               |                       | 1 | 1 |                          |                             |                          |       |        |
| 9   | R01 E10 529 | DRAIN PAN ASSY                                |               | 1                     | 1 | 1 |                          |                             |                          |       |        |
| 10  | R01 E00 202 | ROOM TEMPERATURE THERMISTOR                   |               | 1                     | 1 | 1 |                          | TH1                         |                          |       |        |
| 11  | R01 E00 038 | GUIDE VANE                                    |               | 1                     | 1 | 1 |                          |                             |                          |       |        |
| 12  | R01 E41 202 | PIPE TEMPERATURE THERMISTOR / LIQUID          |               | 1                     | 1 | 1 |                          | TH2                         |                          |       |        |
| 13  | R01 E44 202 | CONDENSER / EVAPORATOR TEMPERATURE THERMISTOR |               | 1                     | 1 | 1 |                          | TH5                         |                          |       |        |
| 14  | R01 E01 002 | VANE  |               | 1                     | 1 | 1 |                          |                             |                          |       |        |
| 15  | R01 E01 223 | VANE MOTOR                                    |               | 1                     | 1 | 1 |                          | MV                          |                          |       |        |
| 16  | R01 E00 110 | CASING ASSY                                   |               | 1                     | 1 | 1 |                          |                             |                          |       |        |
| 17  | R01 31K 241 | SENSOR HOLDER                                 |               | 1                     | 1 | 1 |                          |                             |                          |       |        |
| 18  | R01 E01 266 | DRAIN SENSOR                                  |               | 1                     | 1 | 1 |                          | DS                          |                          |       |        |
| 19  | T7W E02 355 | DRAIN PUMP                                    |               | 1                     | 1 | 1 |                          | DP                          |                          |       |        |
| 20  | R01 E00 130 | MOTOR SUPPORT                                 |               | 1                     | 1 | 1 |                          |                             |                          |       |        |
| 21  | R01 E03 220 | FAN MOTOR                                     |               | 1                     | 1 | 1 |                          | MF                          |                          |       |        |
| 22  | R01 E01 105 | MOTOR MOUNT                                   |               | 1                     | 1 | 1 |                          |                             |                          |       |        |
| 23  | R01 E00 527 | DRAIN PIPE                                    |               | 1                     | 1 | 1 |                          |                             |                          |       |        |
| 24  | —           | CONTROL BOX COVER                             |               | 1                     | 1 | 1 | (RG00L311G13)            |                             |                          |       |        |
| 25  | R01 E01 673 | SCREW ASSY                                    |               | 1                     | 1 | 1 |                          |                             |                          |       |        |

## ELECTRICAL PARTS

PMH-P1BA<sub>2</sub>

PMH-P1.6BA<sub>2</sub>

PMH-P2BA<sub>2</sub>

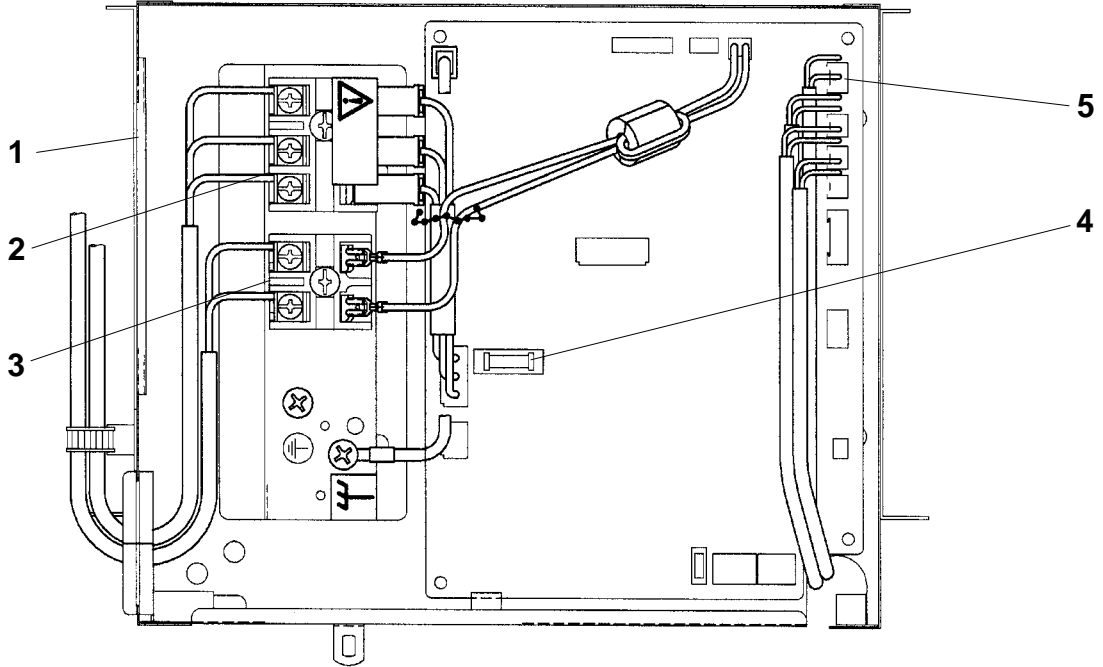

| No. | Part No.    | Part Name               | Specification   | Q'ty/set     |                 | Remarks<br>(Drawing No.) | Wiring<br>Diagram<br>Symbol | Recom-<br>mended<br>Q'ty | Price |        |
|-----|-------------|-------------------------|-----------------|--------------|-----------------|--------------------------|-----------------------------|--------------------------|-------|--------|
|     |             |                         |                 | PMH-P1,1.6,2 | BA <sub>2</sub> |                          |                             |                          | Unit  | Amount |
| 1   | —           | CONTROL BOX             |                 | 1            |                 | (RG02B337G10)            |                             |                          |       |        |
| 2   | T7W E13 716 | TERMINAL BLOCK          | 3P (S1, S2, S3) | 1            |                 |                          | TB4                         |                          |       |        |
| 3   | T7W 515 716 | TERMINAL BLOCK          | 2P (1, 2)       | 1            |                 |                          | TB5                         |                          |       |        |
| 4   | T7W 520 239 | FUSE                    | 250V 6.3A       | 1            |                 |                          | FUSE                        |                          |       |        |
| 5   | T7W E26 310 | INDOOR CONTROLLER BOARD |                 | 1            |                 |                          | I.B                         |                          |       |        |



Mr. SLIM™

 **MITSUBISHI ELECTRIC CORPORATION**  
HEAD OFFICE : MITSUBISHI DENKI BLDG., 2-2-3, MARUNOUCHI, CHIYODA-KU, TOKYO 100-8310, JAPAN