

TECHNICAL & SERVICE MANUAL

Series SEH/SE Ceiling Concealed

Indoor unit
[Model names]

SEH-1.6AR

SEH-2AR

SEH-2.5AR

SE-1.6AR

SE-2AR

SE-2.5AR

[Service Ref.]

SEH-1.6AR.TH
SEH-1.6AR₁.TH
SEH-2AR.TH
SEH-2.5AR.TH
SE-1.6AR.TH
SE-1.6AR₁.TH
SE-1.6AR.TH-T
SE-1.6AR₁.TH-T
SE-2AR.TH
SE-2AR.TH-T
SE-2.5AR.TH
SE-2.5AR.TH-T

- New specification table has been added on page 11 for the indoor unit of 60Hz power supply corresponding to multi type outdoor units.
- Please void OC281 REVISED EDITION-A.
- This manual does not cover the following outdoor units. When servicing them, please refer to the service manual No.OC282 REVISED EDITION-B and this manual in a set.
 SUH-1.6VR.TH, SUH-1.6VR2.TH,
 SUH-2VR.TH, SUH-2VR₁.TH,
 SUH-2VR₂.TH,
 SUH-2.5VR.TH,
 SU-1.6NR.TH,
 SU-2NR.TH,
 SU-2.5NR.TH,
 SU-1.6VR.TH, SU-1.6VR2.TH,
 SU-2VR.TH, SU-2VR₁.TH,
 SU-2.5VR.TH,
 SU-1.6VR.TH-T, SU-1.6VR2.TH-T,
 SU-2VR.TH-T, SU-2VR₁.TH-T,
 SU-2.5VR.TH-T

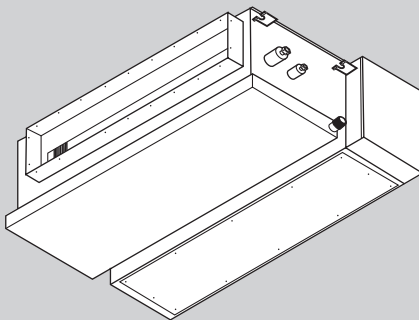
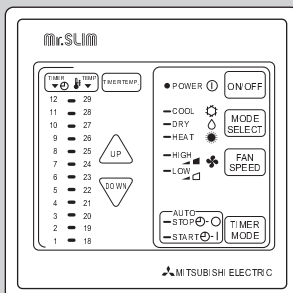
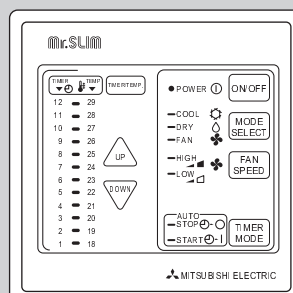
INDOOR UNIT

SEH-1.6, 2, 2.5AR.TH
SEH-1.6AR₁.TH

SE-1.6, 2, 2.5AR.TH
SE-1.6AR₁.TH
SE-1.6, 2, 2.5AR.TH-T
SE-1.6AR₁.TH-T
REMOTE CONTROLLER
CONTENTS

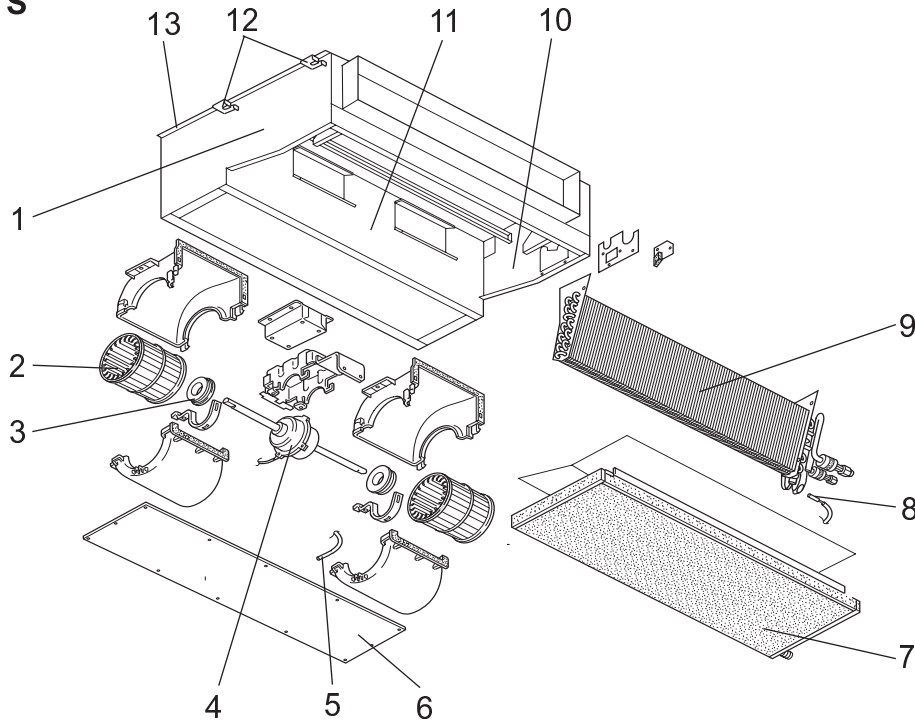
1. TECHNICAL CHANGE	2
2. PART NAMES AND FUNCTIONS	2
3. SPECIFICATIONS	5
4. OUTLINES AND DIMENSIONS	53
5. WIRING DIAGRAM	55
6. REFRIGERANT SYSTEM DIAGRAM	57
7. DATA	63
8. MICROPROCESSOR CONTROL	72
9. TROUBLESHOOTING	78
10. DISASSEMBLY PROCEDURE	87
11. PARTS LIST	90
12. OPTIONAL PARTS	Back cover

**INDOOR UNIT
STRUCTURAL PARTS
SEH-1.6AR.TH
SEH-1.6AR.1.TH
SEH-2AR.TH
SEH-2.5AR.TH**



Part number that is circled is not shown in the illustration.

No.	Parts No.	Parts name	Specification	Q'ty/set			Remarks (Drawing No.)	Wiring Diagram Symbol	Recom- mended Q'ty	Price	
				SEH-1.6	SEH-2	SEH-2.5				Unit	Amount
				AR.TH AR.1.TH	AR.TH						
1	E07 039 086	LEFT SIDE PANEL		1	1	1					
2	E07 039 500	SIROCCO FAN		2	2	2					
3	E02 179 505	FAN MOTOR RUBBER MOUNT		2	2	2	<2PCS/SET>				
4	E07 039 300	FAN MOTOR	PK6V19-EC	1				MF			
	E07 040 300	FAN MOTOR	PK6V32-EC		1			MF			
	E07 041 300	FAN MOTOR	PK6V50-EC			1		MF			
5	E07 039 308	ROOM TEMPERARURE THERMISTOR		1	1	1		RT11			
6	E07 039 000	FRONT PANEL		1	1	1					
7	E07 039 700	DRAIN PAN		1	1	1					
9	E07 039 307	INDOOR COIL THERMISTOR		1	1	1		RT12			
	E07 039 620	INDOOR HEAT EXCHANGER		1							
	E07 040 620	INDOOR HEAT EXCHANGER			1						
	E07 041 620	INDOOR HEAT EXCHANGER				1					
10	E07 051 085	RIGHT SIDE PANEL		1	1	1					
11	E07 039 293	SEPARATOR ASSY		1	1	1					
12	E07 039 809	LEFT LEG		2	2	2					
13	E07 039 290	BASE		1	1	1					
14	E07 039 808	RIGHT LEG		2	2	2					

**INDOOR UNIT
ELECTRICAL PARTS
SEH-1.6AR.TH
SEH-1.6AR_i.TH
SEH-2AR.TH
SEH-2.5AR.TH**

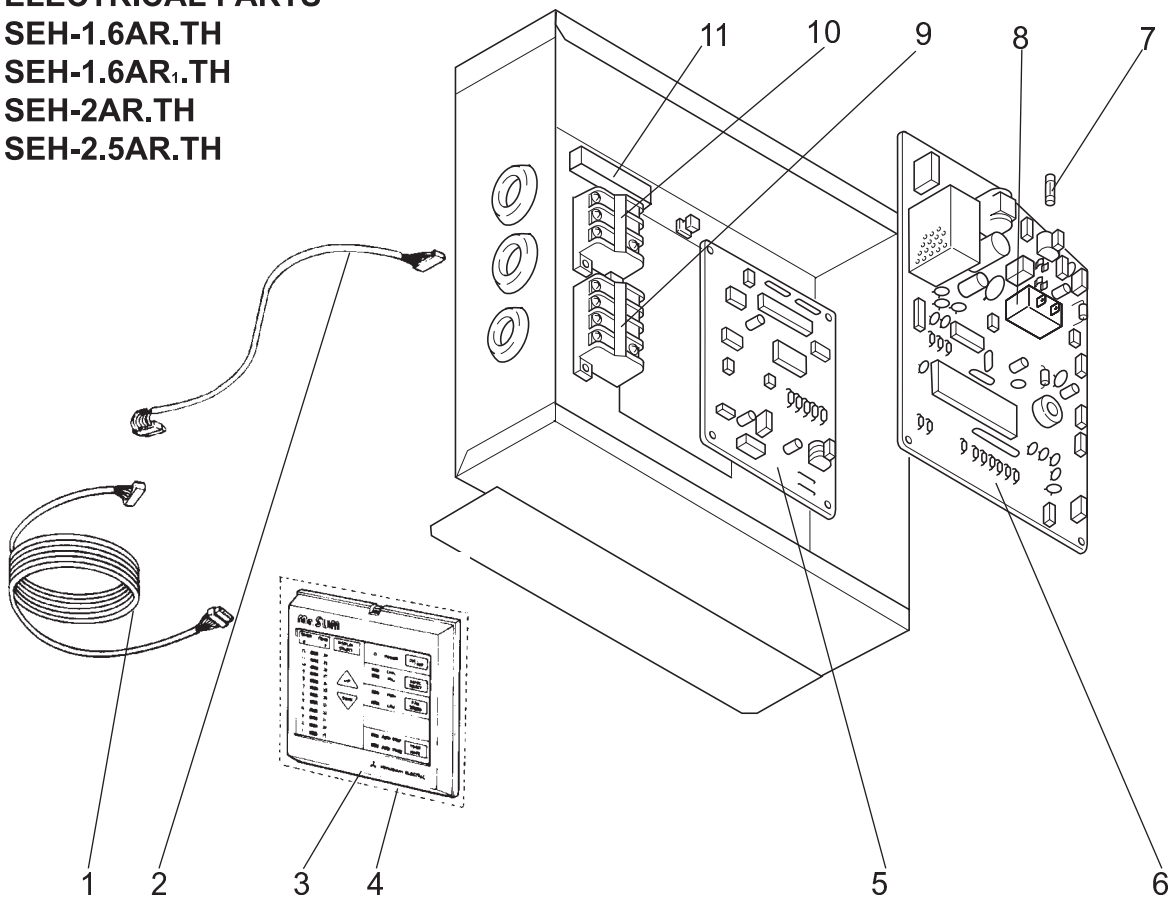

Part numbers that are circled are not shown in the illustration.

No.	Parts No.	Parts name	Specification	Q'ty/set			Remarks (Drawing No.)	Wiring Diagram Symbol	Recom- mended Q'ty	Price	
				SEH-1.6 AR.TH AR _i .TH	SEH-2 AR.TH	SEH-2.5 AR.TH				Unit	Amount
1	E07 027 089	REMOTE CONTROLLER CABLE		1	1	1					
2	E07 039 087	CABLE(FOR BOARD)		1	1	1					
3	E07 027 088	REMOTE CONTROLLER COVER		1	1	1					
4	E07 039 426	REMOTE CONTROLLER		1	1	1					
5	E07 039 454	REMOTE CONTROLLER INTERFACE P.C. BOARD		1	1	1					
6	E07 039 450	ELECTRONIC CONTROL P.C. BOARD		1							
	E07 040 450	ELECTRONIC CONTROL P.C. BOARD			1						
	E07 041 450	ELECTRONIC CONTROL P.C. BOARD				1					
7	E02 127 382	FUSE	250/3.15A	1	1	1		F11			
8	E02 138 340	COMPRESSOR CONTACTOR		1	1	1		52C			
9	E02 199 374	TERMINAL BLOCK	3,2,N,⊕	1	1	1		TB			
10	E02 367 377	TERMINAL BLOCK	L,N,⊕	1	1	1		TB			
11	E02 466 383	SURGE ABSORBER		1	1	1		DSAR			
12	E02 085 385	VARIATOR		1	1	1		NR11			
13	E07 039 449	CONTROLLER COVER		1	1	1					

**INDOOR UNIT
STRUCTURAL PARTS**

SE-1.6AR.TH
SE-1.6AR₁.TH
SE-2AR.TH
SE-2.5AR.TH
SE-1.6AR.TH-T
SE-1.6AR₁.TH-T
SE-2AR.TH-T
SE-2.5AR.TH-T

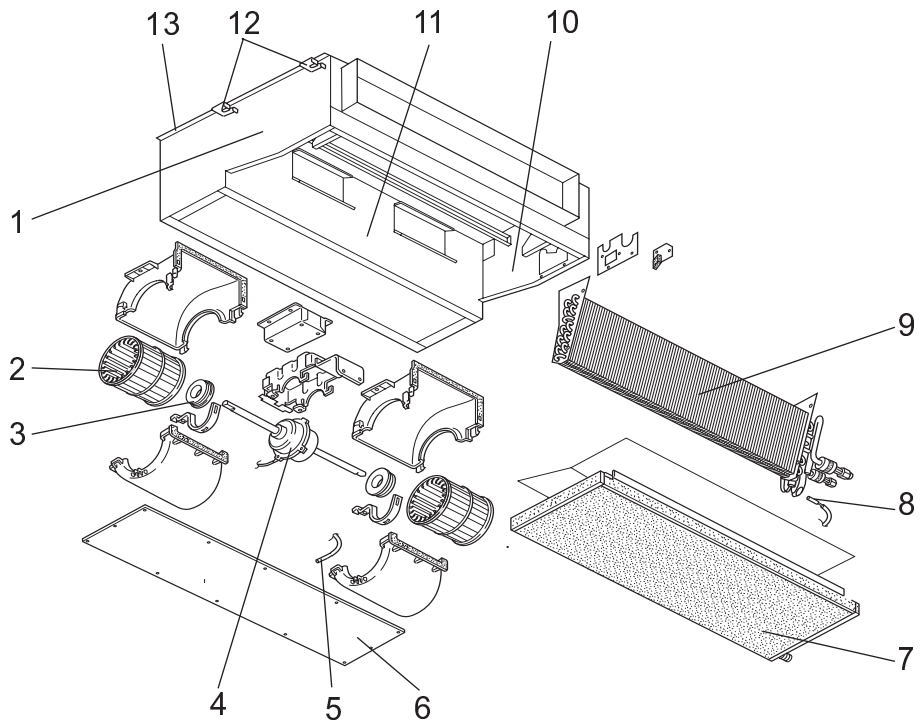

Part number that is circled is not shown in the illustration.

No.	Parts No.	Parts name	Specification	Q'ty/set			Remarks (Drawing No.)	Wiring Diagram Symbol	Recom- mended Q'ty	Price	
				SE-1.6	SE-2	SE-2.5				Unit	Amount
				AR.TH AR ₁ .TH	AR ₁ .TH-T AR ₁ .TH-T	AR.TH AR ₁ .TH-T					
1	E07 039 086	LEFT SIDE PANEL		1	1	1					
2	E07 039 500	SIROCCO FAN		2	2	2					
3	E02 179 505	FAN MOTOR RUBBER MOUNT		2	2	2	<2PCS/SET>				
4	E07 051 300	FAN MOTOR	PK6V19-ED	1				MF			
	E07 052 300	FAN MOTOR	PK6V32-ED		1			MF			
	E07 053 300	FAN MOTOR	PK6V50-ED			1		MF			
5	E07 039 308	ROOM TEMPERATURE THERMISTOR		1	1	1		RT11			
6	E07 039 000	FRONT PANEL		1	1	1					
7	E07 039 700	DRAIN PAN		1	1	1					
8	E07 039 307	INDOOR COIL THERMISTOR		1	1	1		RT12			
9	E07 039 620	INDOOR HEAT EXCHANGER		1							
	E07 040 620	INDOOR HEAT EXCHANGER			1						
	E07 041 620	INDOOR HEAT EXCHANGER				1					
10	E07 051 085	RIGHT SIDE PANEL		1	1	1					
11	E07 039 293	SEPARATOR ASSY		1	1	1					
12	E07 039 809	LEFT LEG		2	2	2					
13	E07 039 290	BASE		1	1	1					
⑭	E07 039 808	RIGHT LEG		2	2	2					

**INDOOR UNIT
ELECTRICAL PARTS
SE-1.6AR.TH
SE-1.6AR_i.TH
SE-2AR.TH
SE-2.5AR.TH
SE-1.6AR.TH-T
SE-1.6AR_i.TH-T
SE-2AR.TH-T
SE-2.5AR.TH-T**

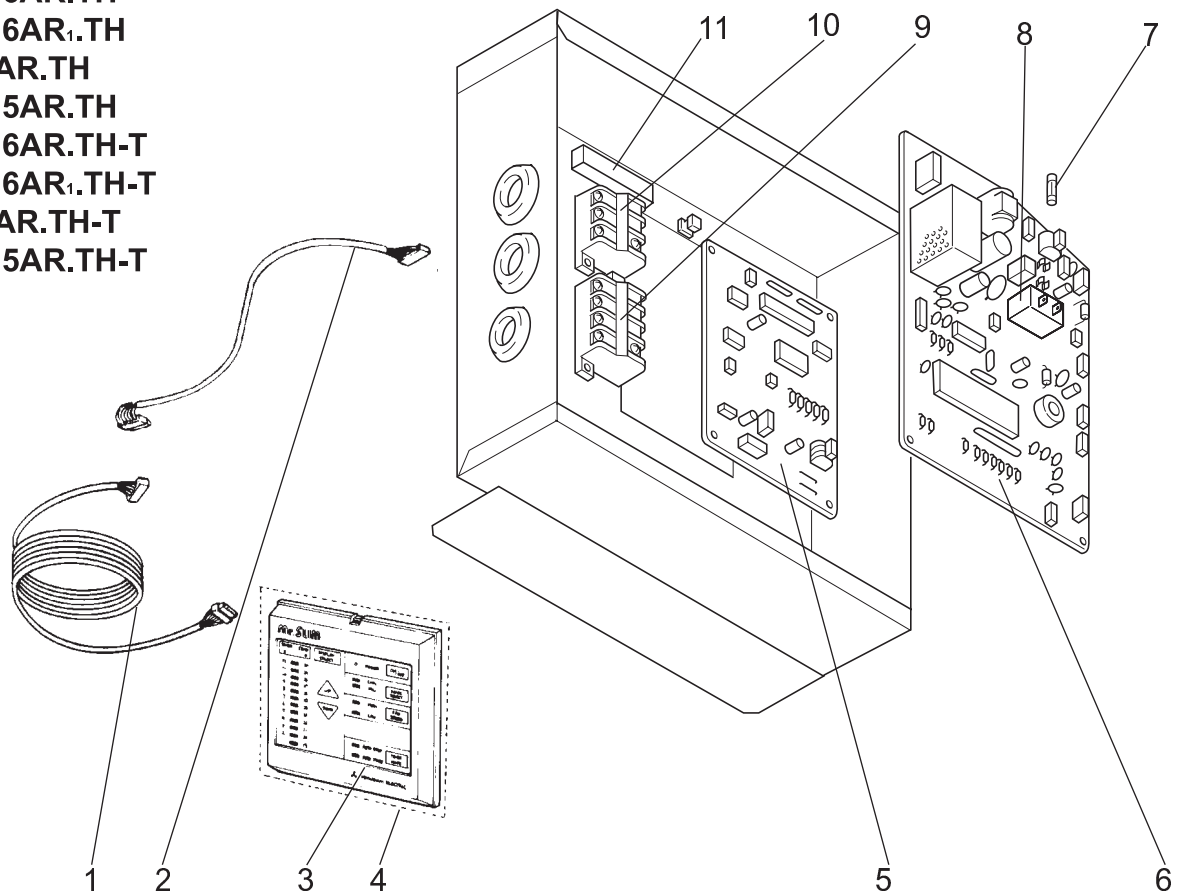

Part numbers that are circled are not shown in the illustration.

No.	Parts No.	Parts name	Specification	Q'ty/set			Remarks (Drawing No.)	Wiring Diagram Symbol	Recom- mended Q'ty	Price	
				SE-1.6 AR.TH AR _i .TH	SE-2 AR.TH AR _i .TH-T	SE-2.5 AR.TH AR _i .TH-T				Unit	Amount
1	E07 027 089	REMOTE CONTROLLER CABLE		1	1	1					
2	E07 039 087	CABLE(FOR BOARD)		1	1	1					
3	E07 027 088	REMOTE CONTROLLER COVER		1	1	1					
4	E07 027 426	REMOTE CONTROLLER		1	1	1					
5	E07 051 454	REMOTE CONTROLLER P.C. BOARD		1	1	1					
6	E07 051 450	ELECTRONIC CONTROL P.C. BOARD		1							
	E07 052 450	ELECTRONIC CONTROL P.C. BOARD			1						
	E07 053 450	ELECTRONIC CONTROL P.C. BOARD				1					
7	E02 127 382	FUSE	250/3.15A	1	1	1		F11			
8	E02 138 340	COMPRESSOR CONTACTOR		1	1	1		52C			
9	E02 229 375	TERMINAL BLOCK	3,2,N,⊕	1	1	1		TB			
10	E02 367 377	TERMINAL BLOCK	L,N,⊕	1	1	1		TB			
11	E02 466 383	SURGE ABSORBER		1	1	1		DSAR			
⑫	E02 085 385	VARISTOR		1	1	1		NR11			
⑬	E07 039 449	CONTROLLER COVER		1	1	1					

1. REFRIGERANT PIPES

The air conditioner has flared connections its indoor and outdoor sides.
Please use the optional extension pipe as follows.

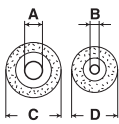
Applied unit	Models	Pipe length	Pipe size O.D.mm (in.)				Additional refrigerant charge R-22(g)	
			Cross-section	A-Gas	B-liquid	Insulation		
C	D							
SEH-1.6AR.TH SEH-1.6AR _i .TH SE-1.6AR.TH SE-1.6AR _i .TH SE-1.6AR.TH-T SE-1.6AR _i .TH-T	MAC-680PI	3m		φ12.7 (1/2)	φ6.35 (1/4)	φ27	φ21	0
	MAC-681PI	5m						150 ((45))
	MAC-682PI	7m						400 ((120))
	MAC-683PI	10m						
	MAC-684PI	15m						
SEH-2AR.TH SE-2AR.TH SE-2AR.TH-T	MAC-670PI	3m	φ15.88 (5/8)	φ31	φ27	0		
	MAC-671PI	5m				150 ((45))		
	MAC-672PI	7m				400 ((120))		
	MAC-673PI	10m						
SEH-2.5AR.TH SE-2.5AR.TH SE-2.5AR.TH-T	MAC-860PI	3m	φ9.52 (3/8)	φ31	φ27	0		
	MAC-861PI	5m				195 ((45))		
	MAC-862PI	7m				520 ((120))		
	MAC-863PI	10m						
	MAC-864PI	15m						

The values in double parentheses show the quantities of additional refrigerant charge for SE- • AR.TH and SE- • AR.TH-T.

2. REMOTE CONTROLLER EXTENSION CABLE

When installing the remote controller at a distance from the air conditioner, use the designated extension cable with connector.

Part No.	PAC-905EC	PAC-906EC	PAC-918EC	PAC-919EC
Length	12m	20m	30m	50m

3. AIR FILTER

Applied unit	Models
SEH-1.6AR.TH, SEH-1.6AR _i .TH SEH-2AR.TH SEH-2.5AR.TH SE-1.6AR.TH, SE-1.6AR _i .TH SE-2AR.TH SE-2.5AR.TH SE-1.6AR.TH-T, SE-1.6AR _i .TH-T SE-2AR.TH-T SE-2.5AR.TH-T	PAC - 1000 FT

 **MITSUBISHI ELECTRIC CORPORATION**

HEAD OFFICE : MITSUBISHI DENKI BLDG., 2-2-3, MARUNOUCHI, CHIYODA-KU, TOKYO 100-8310, JAPAN