

Revision C:

- Parts numbers of thermistors have been corrected.

Please void OB287 REVISED EDITION-B.

OUTDOOR UNIT

No. OB287
REVISED EDITION-C

SERVICE MANUAL

Models

MXZ-24UV - **E1**

MXZ-24UV - **E2**

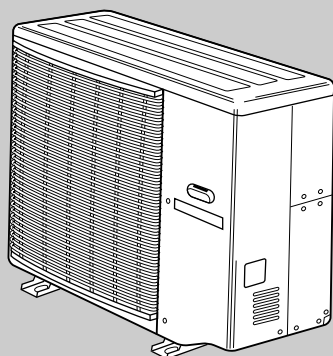

CONTENTS

1. TECHNICAL CHANGES	2
2. PART NAMES AND FUNCTIONS	3
3. INDOOR/OUTDOOR CORRESPONDENCE TABLE	4
4. INDOOR UNITS COMBINATION	5
5. SPECIFICATION	7
6. NOISE CRITERIA CURVES	8
7. OUTLINES AND DIMENSIONS	9
8. WIRING DIAGRAM	10
9. REFRIGERANT SYSTEM DIAGRAM	11
10. PERFORMANCE CURVES	12
11. MICROPROCESSOR CONTROL	18
12. TROUBLESHOOTING	24
13. DISASSEMBLY INSTRUCTIONS	36
14. PARTS LIST	39
15. OPTIONAL PARTS	42

This manual describes technical data of the outdoor unit.
For the indoor unit, refer to the service manuals No. OB229, OB227, OB252, OB212, OB239 and OC165.

14-1. OUTDOOR UNIT FUNCTIONAL PARTS

MXZ-24UV -E1

MXZ-24UV -E2

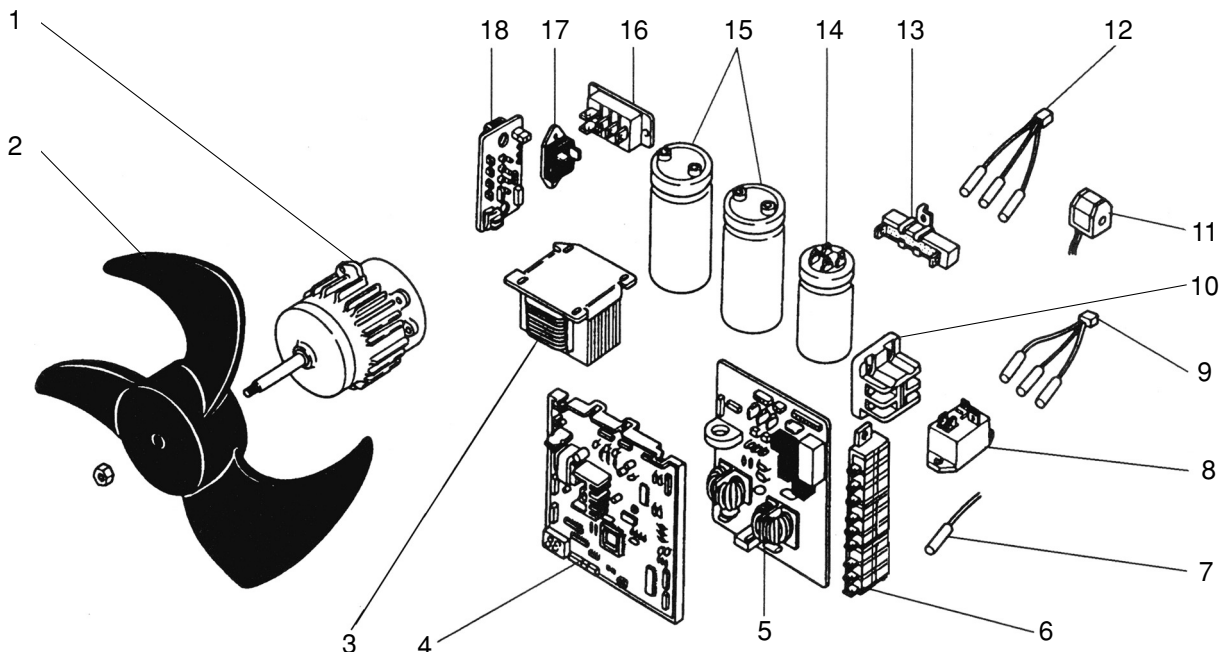

Part numbers that are circled are not shown in the illustration.

No.	Parts No.	Parts Name	Symbol in Wiring Diagram	Q'ty / unit		Remarks
				MXZ-24UV-E1	MXZ-24UV-E2	
1	T2W E40 301	OUTDOOR FAN MOTOR	MF61	1	1	RA6V60 - □□
2	M21 17A 501	PROPELLER FAN		1	1	
3	M21 17E 337	REACTOR	L	1	1	
4	T2W E89 451	ELECTRONIC CONTROL P.C. BOARD		1	1	
5	T2W E79 424	NOISE FILTER P.C. BOARD		1		
	T2W G01 424	NOISE FILTER P.C. BOARD			1	
6	T2W E58 376	TERMINAL BLOCK	TB2, 3, 4	3	3	
7	M21 42A 308	FIN TEMPERATURE THERMISTOR	RT65	1	1	
8	M21 42A 340	RELAY	X64	1	1	
9	M21 AS2 308	THERMISTOR SET	RT61, 62, 63	1	1	EVAPORATION DISCHARGE, DEFROST
10	T2W E65 375	TERMINAL BLOCK	TB1	1	1	
11	T2W E70 398	R. V. COIL	21S4	1	1	
12	T2W E88 307	GAS PIPE TEMPERATURE THERMISTOR	RT66,67,68	1	1	A,B,C
13	M21 17A 362	RESISTOR	R	1		10Ω
	T2W G01 362	RESISTOR	R		1	20Ω
14	T2W E40 357	POWER FACTOR CAPACITOR	C61	1	1	220μF 400V
15	T2W E40 356	SMOOTHING CAPACITOR	C62,C63	2	2	2500μF 400V
16	M21 17A 443	DIODE MODULE	DS61	1	1	
17	M21 17A 447	DIODE STACK	DS62	1	1	
18	T2W E40 452	I.P.M P.C. BOARD		1	1	
①9	T2W E40 441	RELAY P.C. BOARD		1	1	
②0	T2W E66 382	FUSE	F801,F911	2	2	1A
②1	T2W E89 313	FUSE&VARISTOR	F912,NR63		1	3.15A
②2	M21 370 378	TERMINAL BLOCK	TB5	1		

14-2. OUTDOOR UNIT STRUCTURAL PARTS

MXZ-24UV -**E1**

MXZ-24UV -**E2**

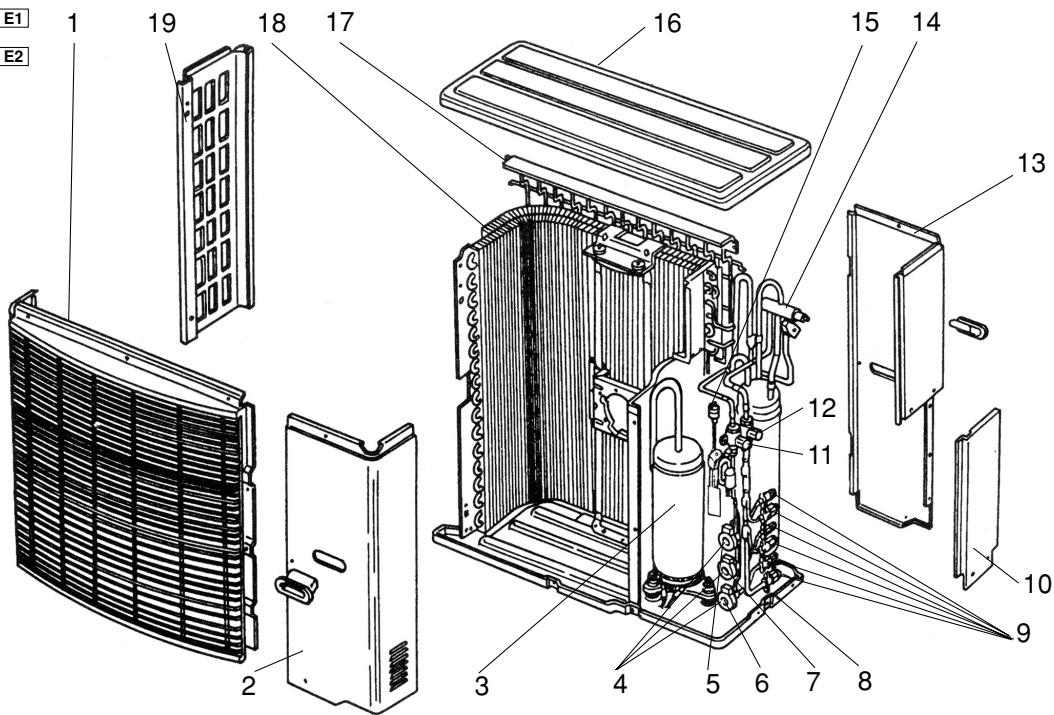

Part numbers that are circled are not shown in the illustration.

No.	Parts No.	Parts Name	Symbol in Wiring Diagram	Q'ty / unit		Remarks
				MXZ-24UV- E1	MXZ-24UV- E2	
1	M21 AS2 232	FRONT PANEL		1		
2	M21 17A 245	SERVICE PANEL		1		
3	T92 500 800	COMPRESSOR	MC	1		THV247FBA
4	M21 90V 646	EXPANSION VALVE		3		
5	T2W E70 653	EXPANSION VALVE COIL	LEV C	1		C room
	T2W E95 653	LEV COIL		1		
	T2W E95 655	EXPANSION VALVE		1		
6	T2W E70 651	EXPANSION VALVE COIL	LEV A	1		A room
	T2W E95 651	LEV COIL		1		
	T2W E95 655	EXPANSION VALVE		1		
7	T2W E70 652	EXPANSION VALVE COIL	LEV B	1		B room
	T2W E95 652	LEV COIL		1		
	T2W E95 655	EXPANSION VALVE		1		
8	T2W E79 290	BASE ASSEMBLY		1		
9	M21 42E 644	UNION		1		1/2,3/8,1/4 SET
10	T2W E40 247	PIPE COVER		1		
11	M21 AN8 667	BALL VALVE 3/8		1		
12	M21 HG1 667	BALL VALVE 5/8		1		
13	T2W E70 248	REAR PANEL		1		
14	M21 48A 961	4-WAY VALVE		1		
15	T2W E79 646	HIGH PRESSURE SWITCH	63H1	1		2.75MPa(28kg/cm ²)
16	M21 17A 297	TOP PANEL		1		
17	T2W E40 523	REAR GUARD		1		
18	M21 42E 630	HEAT EXCHANGER		1		
19	M21 17A 249	SIDE PANEL		1		
20	T2W E40 646	HIGH PRESSURE SWITCH	63H2	1		3.43MPa(35kg/cm ²)
21	M21 986 936	CAPILLARY TUBE		3		φ4.0×φ2.4×400
22	M21 LV0 936	CAPILLARY TUBE SET		3		φ3.0×φ2.0×200
23	T2W E59 936	CAPILLARY TUBE		1		φ2.5×φ0.6×1000
24	T2W E70 936	CAPILLARY TUBE		1		φ2.0×φ0.6×750

When servicing, cut the tube to the proper length as shown in the REFRIGERANT SYSTEM DIAGRAM.
See page 11.



14-3. ACCESSORY PARTS

MXZ-24UV - **E1**

MXZ-24UV - **E2**

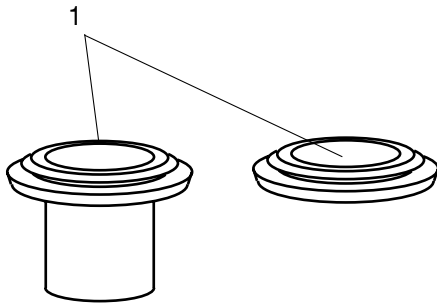

No.	Parts No.	Parts Name	Symbol in Wiring Diagram	Q'ty / unit	Remarks
				MXZ-24UV - E1 MXZ-24UV - E2	
1	T2W E59 704	DRAIN SOCKET ASSEMBLY		1	DRAIN SOCKET ×1 DRAIN CAP ×2

15-1. DIFFERENT-DIAMETER PIPE

MXZ-24UV	Model name	Connected pipes diameter (mm)
For different-diameter pipes	MAC-454JP	$\phi 9.52$ — $\phi 12.7$ (3/8) (1/2)
	MAC-455JP	$\phi 12.7$ — $\phi 9.52$ (1/2) (3/8)
	MAC-456JP	$\phi 12.7$ — $\phi 15.88$ (1/2) (5/8)

15-2. OUTLET GUIDE

Changes air discharge direction.

Applied unit	Model name	Model code
MXZ-24UV	MAC-855SG	51H-855

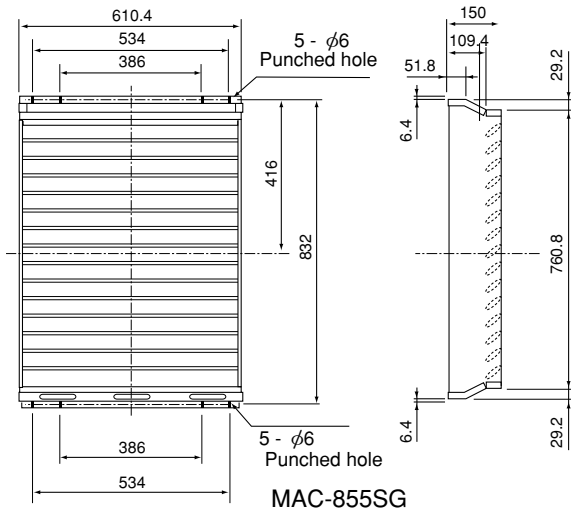



HEAD OFFICE: TOKYO BLDG., 2-7-3, MARUNOUCHI, CHIYODA-KU, TOKYO 100-8310, JAPAN

© Copyright 2001 MITSUBISHI ELECTRIC ENGINEERING CO.,LTD

Distributed in Jun. 2010. No.OB287 REVISED EDITION-C 6

Distributed in Jun. 2006. No.OB287 REVISED EDITION-B 7

Distributed in Jan. 2003. No.OB287 REVISED EDITION-A 7

Distributed in Oct. 2001. No.OB287 248

Made in Japan

New publication, effective Jun. 2010
Specifications subject to change without notice.