

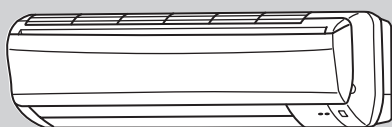

# SERVICE MANUAL

## Wireless type Models

<b>MSC-A07YV</b>	■ <b>E1</b> (WH)
<b>MSC-A09YV</b>	■ <b>E1</b> (WH)
<b>MSC-A12YV</b>	■ <b>E1</b> (WH)



Indication of model name

**MSC-A07YV** - **E1**  
**MSC-A09YV** - **E1**  
**MSC-A12YV** - **E1**



## CONTENTS

1. TECHNICAL CHANGES .....	3
2. PART NAMES AND FUNCTIONS .....	3
3. SPECIFICATION .....	5
4. NOISE CRITERIA CURVES .....	6
5. OUTLINES AND DIMENSIONS .....	7
6. WIRING DIAGRAM .....	8
7. REFRIGERANT SYSTEM DIAGRAM .....	8
8. MICROPROCESSOR CONTROL .....	9
9. SERVICE FUNCTIONS .....	17
10. TROUBLESHOOTING .....	19
11. DISASSEMBLY INSTRUCTIONS .....	26
12. PARTS LIST .....	28

### NOTE:

- This manual describes technical data of indoor units.
- As for outdoor units MU-A07/A09/A12YV -**E1**, refer to the service manual OB330.
- As for outdoor units MUH-A07/A09/A12YV -**E1**, refer to the service manual OB331.
- As for outdoor units MUX-A10/A19/A20/A25/A26WV -**E1**, refer to the service manual OB307 REVISED EDITION-A.
- As for outdoor units MUX-A22WV -**E1**, refer to the service manual OB318.
- As for outdoor units MXZ-A18/A26/A32WV -**E1**, refer to the service manual OB319.



## &lt;"Terminal with lock mechanism" Detaching points&gt;

In case of terminal with lock mechanism, detach the terminal as shown below.  
There are two types ( Refer to (1) and (2) ) of the terminal with lock mechanism.  
The terminal with no lock mechanism can be removed by pulling it out.  
Check the shape of the terminal and work.

(1) Slide the sleeve and check if there is a locking lever or not.

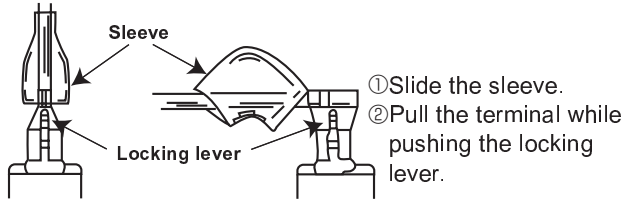

(2) The terminal with this connector is a terminal with lock mechanism

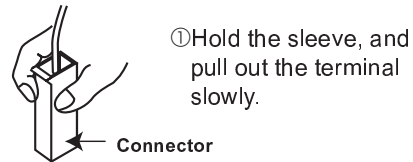

**MSC-A07YV -E1 MSC-A09YV -E1 MSC-A12YV -E1**  
**INDOOR UNIT**

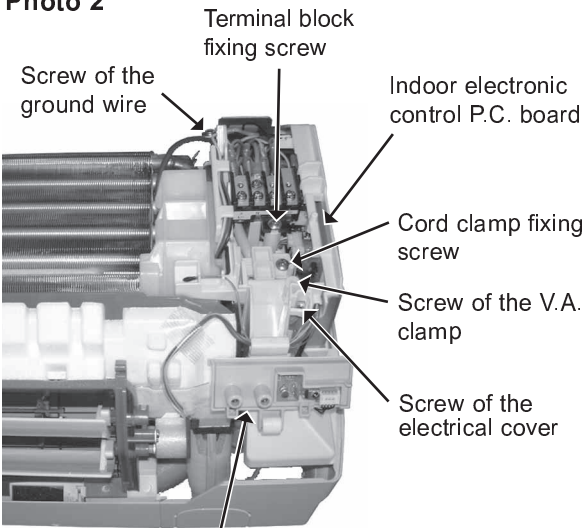
OPERATING PROCEDURE	PHOTOS
<p><b>1. Removing the front panel</b></p> <p>(1) Remove the screw caps of the front panel. Remove the screws.</p> <p>(2) Pull the panel down to your side slightly and unhook the catches at the top.</p>	<p><b>Photo 1</b></p>  <p>Screws of the front panel</p>
<p><b>2. Removing the electronic control P.C. board and the power monitor, receiver P.C. board</b></p> <p><b>NOTE :</b> In case of removing only indoor electronic control P.C. board, work (3) is not necessary.</p> <p>(1) Remove the front panel. (Refer to 1.)</p> <p>(2) Remove the power monitor, receiver P.C. board holder from the bottom of electrical box.</p> <p>(3) Open the power monitor, receiver P.C. board holder and remove the power monitor, receiver P.C. board.</p> <p>(4) Remove the screw of the electrical cover and the electrical cover.</p> <p>(5) Remove the screw of the V.A. clamp and the V.A. clamp.</p> <p>(6) Remove the screw of the cord clamp and the cord clamp.</p> <p>(7) Remove the screw of the terminal block.</p> <p>(8) Remove the screw of the ground wire.</p> <p>(9) Pull out indoor electronic control P.C. board slightly.</p> <p>(10) Disconnect all (except CN101) the connectors on the electronic control P.C. board.</p> <p>(11) Remove the electronic control P.C. board.</p> <p>(12) Disconnect the connector of power monitor, receiver P.C. board (CN101) on the electronic control P.C. board.</p>	<p><b>Photo 2</b></p>  <p>Terminal block fixing screw</p> <p>Screw of the ground wire</p> <p>Indoor electronic control P.C. board</p> <p>Cord clamp fixing screw</p> <p>Screw of the V.A. clamp</p> <p>Screw of the electrical cover</p> <p>Power monitor, receiver P.C. board holder</p>

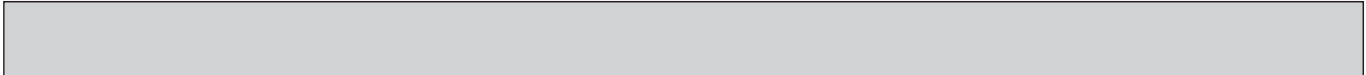

**OPERATING PROCEDURE**

**3. Removing the electrical box**

- (1) Remove the front panel. (Refer to 1.)
- (2) Remove the electrical cover. (Refer to 2.)
- (3) Remove the V.A. clamp. (Refer to 2.)
- (4) Remove the cord clamp. (Refer to 2.)
- (5) Remove the terminal block. (Refer to 2.)
- (6) Remove the screw of ground wire. (Refer to 2.)
- (7) Disconnect the connector of the indoor coil thermistor (CN112), the fan motor connector (CN211 and CN121) and the vane motor connector (CN151) on the electronic control P.C. board.
- (8) Remove the fan motor lead wire and indoor coil thermistor from the electrical box.
- (9) Remove the lead wire of vane motor from the bottom of electrical box.
- (10) Remove the screw fixing the electrical box, remove the electrical box.

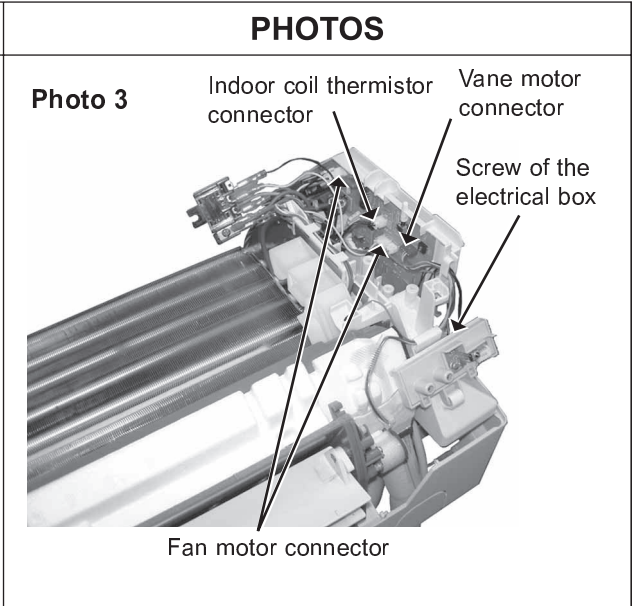

**4. Removing the nozzle assembly and the vane motor**

- (1) Remove the front panel. (Refer to 1.)
- (2) Remove the electrical box. (Refer to 3.)
- (3) Pull out the drain hose from the nozzle assembly, remove the nozzle assembly.
- (4) Remove the screws of the vane motor, disconnect the vane motor connector.
- (5) Remove the vane motor.

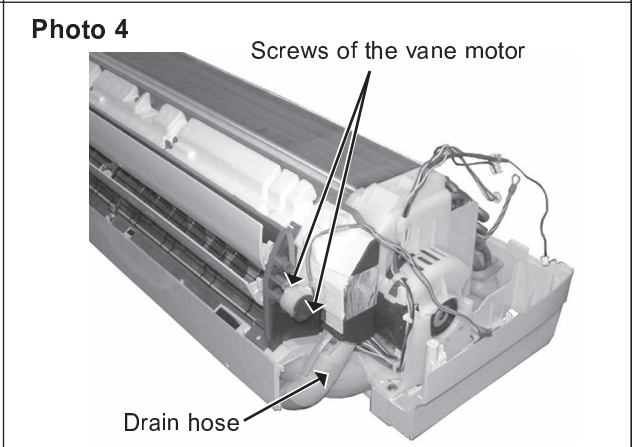

**5. Removing the indoor fan motor and the line flow fan**

- (1) Remove the front panel. (Refer to 1.)
- (2) Remove the electrical box. (Refer to 3.)
- (3) Pull out the drain hose from the nozzle assembly, remove the nozzle assembly. (Refer to 4.)
- (4) Remove the screw of the lead cover and lead cover.
- (5) Release the hooks to open the motor band slightly.
- (6) Loosen the hexagon socket set screw from the line flow fan.
- (7) Remove the screws fixing the motor bed, remove the fan motor with motor band and the motor bed.
- (8) Remove the screws fixing the left side of the heat exchanger.
- (9) Lift the left side of the heat exchanger.
- (10) Remove the line flow fan.

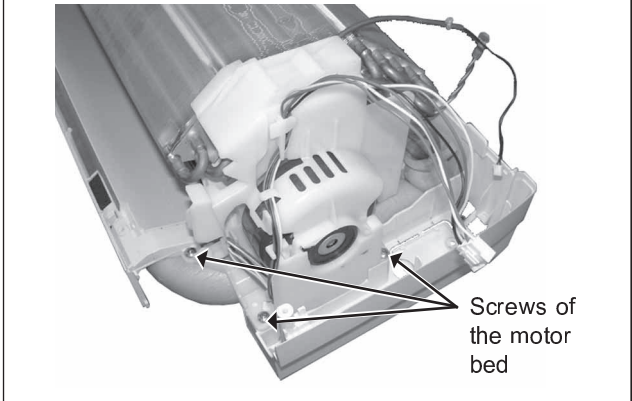
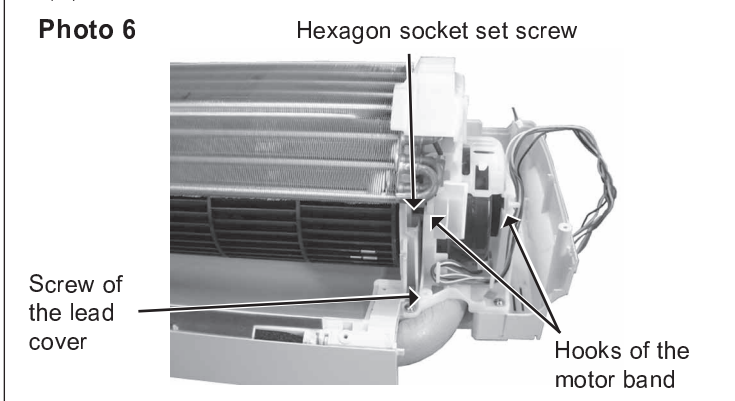
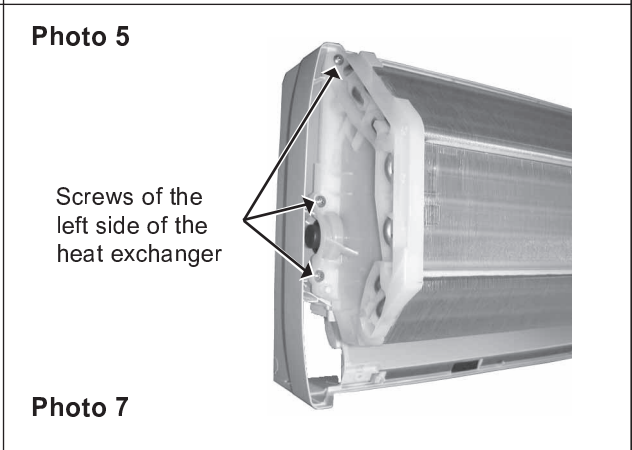

MSC-A07YV -E1 (WH)  
 MSC-A09YV -E1 (WH)  
 MSC-A12YV -E1 (WH)

12-1. INDOOR UNIT STRUCTURAL PARTS

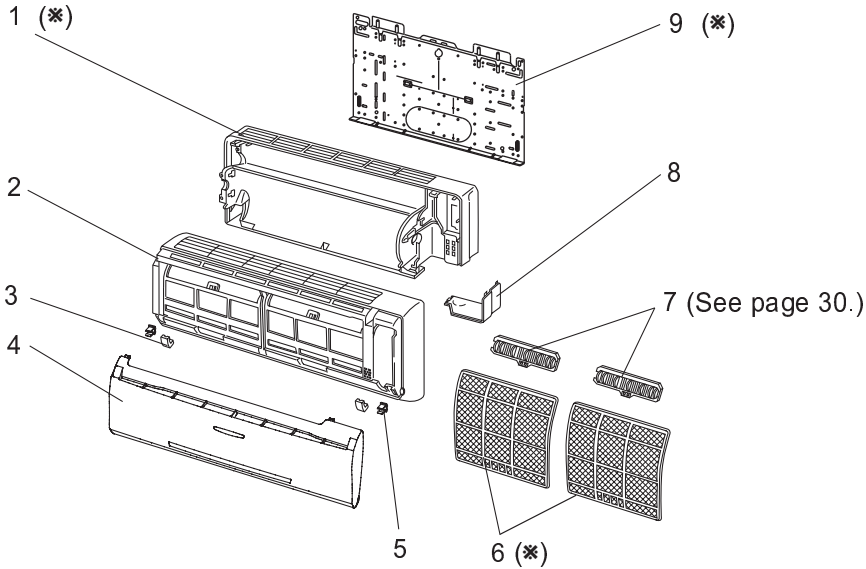

12-2. ACCESSORY AND REMOTE CONTROLLER

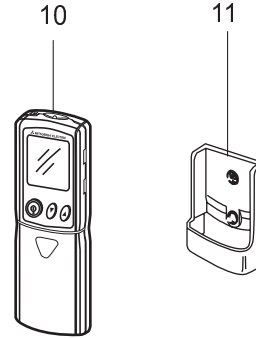

(\*) These figures show about MSC-A12YV.

12-1. INDOOR UNIT STRUCTURAL PARTS

No.	Part No.	Part Name	Symbol in Wiring Diagram	Q'ty/unit			Remarks
				MSC-A07YV- E1 (WH)	MSC-A09YV- E1 (WH)	MSC-A12YV- E1 (WH)	
1	E02 749 234	BOX(WH)		1	1		
	E02 751 234	BOX(WH)				1	
2	E02 829 000	PANEL ASSEMBLY(WH)		1	1	1	Including No.3,4,5
3	E02 749 067	SCREW CAP(WH)		2	2	2	2PCS/SET
4	E02 829 010	FRONT PANEL(WH)		1	1	1	
5	E02 408 142	CATCH		2	2	2	2PCS/SET
6	E02 763 100	CATECHIN AIR FILTER		2	2		
	E02 764 100	CATECHIN AIR FILTER				2	
7		AIR CLEANING FILTER		2	2	2	MAC-1300FT
8	E02 749 975	CORNER BOX (RIGHT)		1	1	1	
9	E02 408 970	INSTALLATION PLATE		1	1		
	E02 751 970	INSTALLATION PLATE				1	

12-2. ACCESSORY AND REMOTE CONTROLLER

10	E02 749 426	REMOTE CONTROLLER		1	1	1	
11	E02 527 083	REMOTE CONTROLLER HOLDER		1	1	1	

MSC-A07YV -E1 (WH) MSC-A09YV -E1 (WH) MSC-A12YV -E1 (WH)

12-3. INDOOR UNIT ELECTRICAL PARTS AND FUNCTIONAL PARTS

12-4. INDOOR UNIT HEAT EXCHANGER

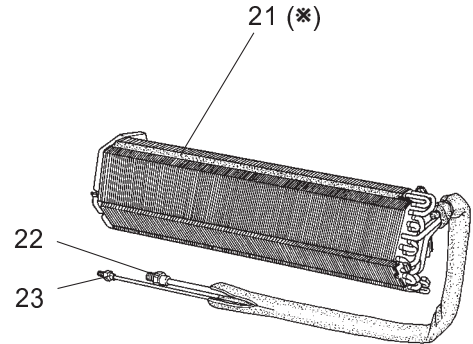
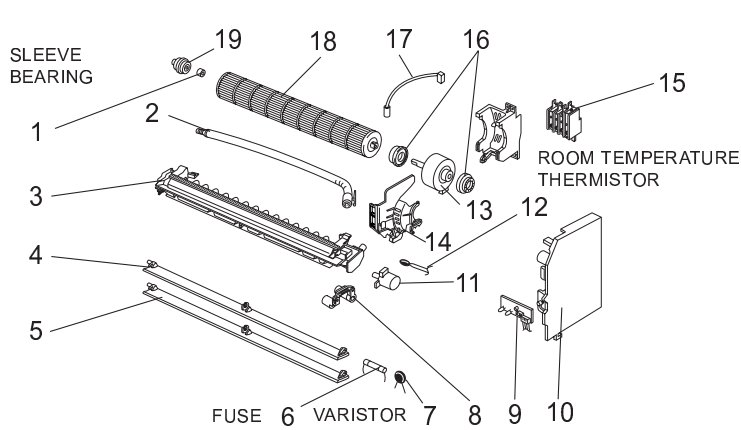

(\* ) This figure shows about MSC-A12YV.

12-3. INDOOR UNIT ELECTRICAL PARTS AND FUNCTIONAL PARTS

Part number that is circled is not shown in the illustration.

No.	Part No.	Part Name	Symbol in Wiring Diagram	Q'ty/unit			Remarks
				MSC-A07YV- E1 (WH)	MSC-A09YV- E1 (WH)	MSC-A12YV- E1 (WH)	
1	E02 001 504	SLEEVE BEARING		1	1	1	
2	E02 661 702	DRAIN HOSE		1	1	1	
3	E02 749 235	NOZZLE ASSEMBLY(WH)		1	1	1	
4	E02 749 040	VANE UPPER (WH)		1	1	1	
5	E02 749 041	VANE LOWER (WH)		1	1	1	
6	E02 127 382	FUSE	F11	1	1	1	3.15A
7	E02 829 385	VARISTOR	NR11	1	1	1	
8	E02 763 034	VANE CRANK SET		1	1	1	
9	E02 749 468	POWER MONITOR, RECEIVER P.C. BOARD		1	1	1	
10	E02 829 452	ELECTRONIC CONTROL P.C.BOARD		1			AUTO RESTART
	E02 830 452	ELECTRONIC CONTROL P.C.BOARD			1		AUTO RESTART
	E02 831 452	ELECTRONIC CONTROL P.C.BOARD				1	AUTO RESTART
11	E02 749 303	VANE MOTOR	MV	1	1	1	
12	E02 151 308	ROOM TEMPERATURE THERMISTOR	RT11	1	1	1	
13	E02 749 300	INDOOR FAN MOTOR	MF	1	1		RC4V19-□□
	E02 751 300	INDOOR FAN MOTOR	MF			1	RC4V19-□□
14	E02 749 333	MOTOR BAND		1	1	1	
15	E02 691 375	TERMINAL BLOCK	TB	1	1	1	
16	E02 665 505	FAN MOTOR RUBBER MOUNT		2	2		2PCS/SET
	E02 151 505	FAN MOTOR RUBBER MOUNT				2	2PCS/SET
17	E02 749 307	INDOOR COIL THERMISTOR	RT12	1	1	1	
18	E02 749 302	LINE FLOW FAN		1	1	1	
19	E02 408 509	BEARING MOUNT		1	1		
	E02 751 509	BEARING MOUNT				1	
20	E02 749 385	VARISTOR	NR12	1	1	1	

12-4. INDOOR UNIT HEAT EXCHANGER

21	E02 749 620	INDOOR HEAT EXCHANGER		1	1		
	E02 751 620	INDOOR HEAT EXCHANGER				1	
22	E02 151 666	UNION(GAS)		1	1		φ9.52
	E02 155 666	UNION(GAS)				1	φ12.7
23	E02 151 667	UNION(LIQUID)		1	1	1	φ6.35

## 12-5. AIR CLEANING FILTER

- AIR CLEANING FILTER removes fine dust of 0.01 micron from air by means of static electricity.
- Normal life of AIR CLEANING FILTER is 4 months. However, when it becomes dirty, replace it as soon as possible.
- Clogged AIR CLEANING FILTER may reduce the air conditioner capacity or cause frost on the air outlet.
- DO NOT reuse AIR CLEANING FILTER even if it is washed.
- DO NOT remove or attach AIR CLEANING FILTER during unit operation.

Model	Part No.
MSC-A07YV- <input type="checkbox"/> E1	MAC-1300FT
MSC-A09YV- <input type="checkbox"/> E1	
MSC-A12YV- <input type="checkbox"/> E1	

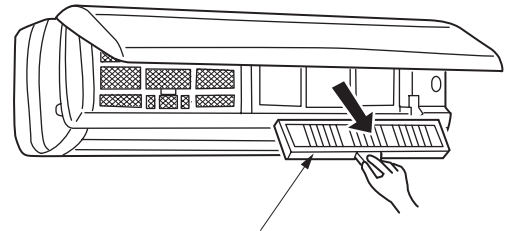

**Air cleaning filter  
(White bellows type)**





HEAD OFFICE: MITSUBISHI DENKI BLDG.,2-2-3, MARUNOUCHI, CHIYODA-KU, TOKYO100-8310, JAPAN