

Revision A:

- MUZ-A12YV-E1 and MUZ-A12YVH-E1 can be connected to MCFZ-A12WV-E1.
- Some mistakes were corrected.

Please void OB328.

SERVICE MANUAL

**No. OB328
REVISED EDITION-A**

Wireless type Models

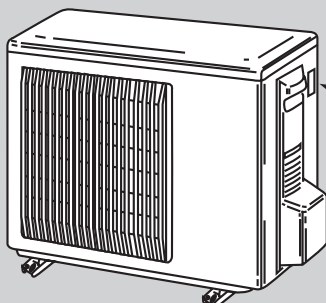
MUZ-A09YV - E1
MUZ-A12YV - E1
MUZ-A09YVH - E1
MUZ-A12YVH - E1

 Indication of
model name

MUZ-A09YV - E1
MUZ-A12YV - E1
MUZ-A09YVH - E1
MUZ-A12YVH - E1

CONTENTS

1. TECHNICAL CHANGES	2
2. PART NAMES AND FUNCTIONS	5
3. SPECIFICATION	5
4. NOISE CRITERIA CURVES	7
5. OUTLINES AND DIMENSIONS	8
6. WIRING DIAGRAM	9
7. REFRIGERANT SYSTEM DIAGRAM	11
8. PERFORMANCE CURVES	12
9. ACTUATOR CONTROL	21
10. SERVICE FUNCTIONS	22
11. TROUBLESHOOTING	22
12. DISASSEMBLY INSTRUCTIONS	34
13. PARTS LIST	38

NOTE:

This service manual describes technical data of the outdoor units.

 •As for indoor units MSZ-A09YV-E1 and MSZ-A12YV-E1, refer to the service manual OB327.

 •As for indoor unit MCFZ-A12WV-E1, refer to the service manual OB344.



<"Terminal with lock mechanism" Detaching points>

In case of terminal with lock mechanism, detach the terminal as shown below.
 There are two types (Refer to (1) and (2)) of the terminal with lock mechanism.
 The terminal with no lock mechanism can be removed by pulling it out.
 Check the shape of the terminal and work.

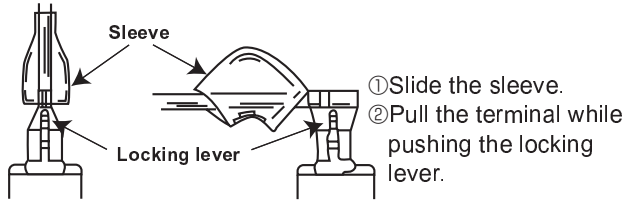
(1) Slide the sleeve and check if there is a locking lever or not.

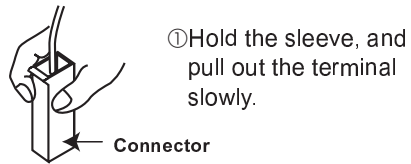

(2) The terminal with this connector is a terminal with lock mechanism



MUZ-A09YV -[E1] MUZ-A12YV -[E1]
MUZ-A09YVH -[E1] MUZ-A12YVH -[E1]
OUTDOOR UNIT

OPERATING PROCEDURE	PHOTOS
<p>1. Removing the cabinet.</p> <p>(1) Remove the screws fixing the top panel. (Photo 1) (2) Remove the top panel. (Photo 1) (3) Remove the screw fixing the service panel. (Photo 2) (4) Pull down the service panel and remove it. (Photo 2) (5) Remove the screws fixing the cabinet. (6) Remove the cabinet. (7) Disconnect the indoor/outdoor connecting wire. (8) Remove the screws fixing the back panel. (9) Remove the back panel.</p> <p>Photo 2</p>	<p>Photo 1</p>

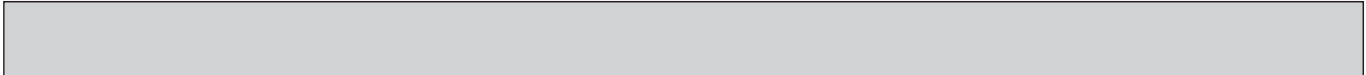

OPERATING PROCEDURE

2. Removing the inverter assembly, inverter P.C. board and power P.C. board

- (1) Remove the top panel, cabinet and service panel. (Refer to 1.)
- (2) Disconnect the indoor/outdoor connecting wire and remove the back panel. (Refer to 1.)
- (3) Disconnect the ground wire, the lead wire to the reactor and the following connectors;
 - <Power P.C. board>
 - CN721 (4-way valve)
 - CN722 (Defrost heater) MUZ-A09/A12YVH-E1
 - CN771 (Fan motor)
 - <Inverter P.C. board>
 - CN641 (Defrost thermistor and discharge temperature thermistor)
 - CN643 (Ambient temperature thermistor)
 - CN724 (LEV)
- (4) Remove the compressor connector (CN61).
- (5) Remove the screws fixing the relay panel. (Photo 3)
- (6) Remove the inverter assembly. (Photo 3)
- (7) Disconnect all connectors and lead wires on the inverter P.C. board. (Photo 4)
- (8) Remove the inverter P.C. board from the inverter assembly.
- (9) Remove the screw fixing the power P.C. board. (Photo 4)
- (10) Disconnect all connectors and lead wires on the power P.C. board.
- (11) Remove the power P.C. board from the inverter assembly.

3. Removing R.V. coil

- (1) Remove the top panel, cabinet and service panel. (Refer to 1.)
- (2) Disconnect the indoor/outdoor connecting wire and remove the back panel. (Refer to 1.)
- (3) Remove the inverter assembly. (Refer to 2.)
- (4) Remove the R.V. coil. (Photo 5)

PHOTOS

Photo 3

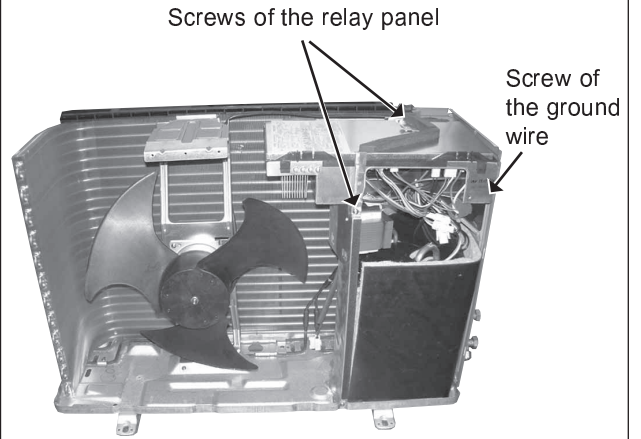
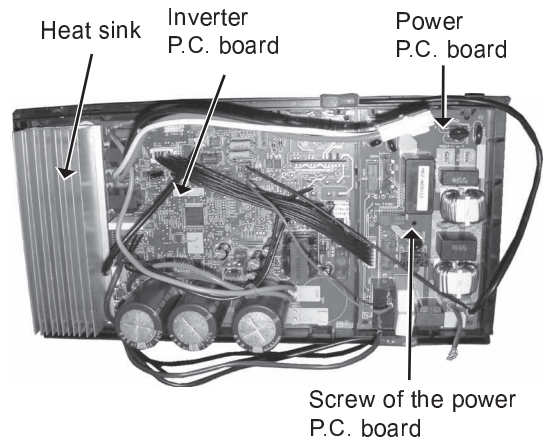

Photo 4



OPERATING PROCEDURE

4. Removing the defrost thermistor and discharge temperature thermistor

- (1) Remove the top panel, cabinet and service panel.
(Refer to 1.)
- (2) Disconnect the indoor/outdoor connecting wire and remove the back panel. (Refer to 1.)
- (3) Remove the inverter assembly. (Refer to 2.)
- (4) Pull out the defrost thermistor from its holder. (Photo 6)
- (5) Pull out the discharge temperature thermistor from its holder. (Photo 5)

PHOTOS

Photo 5

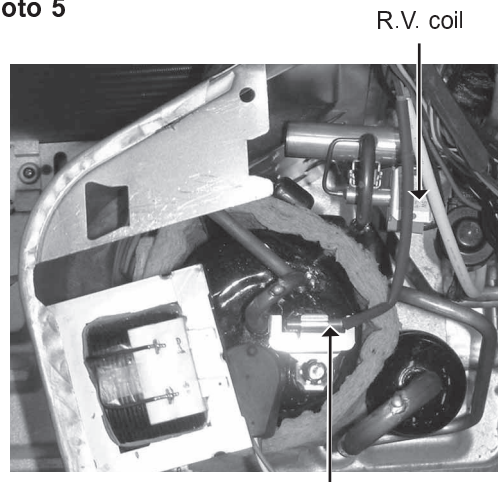

Discharge temperature thermistor

Photo 6

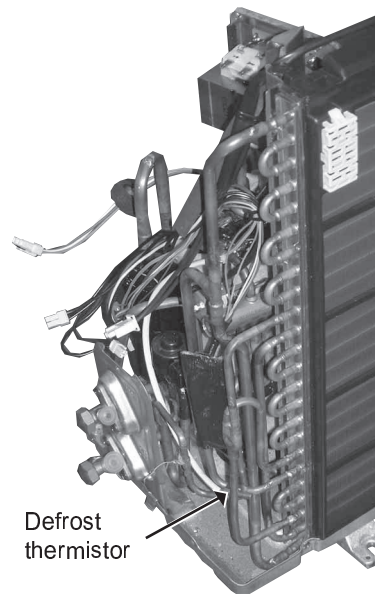

Defrost thermistor

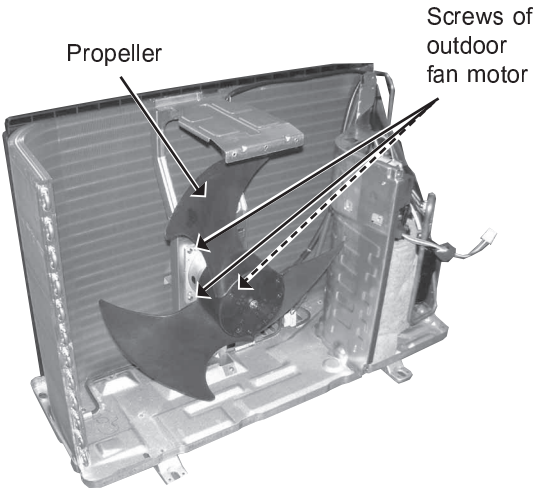
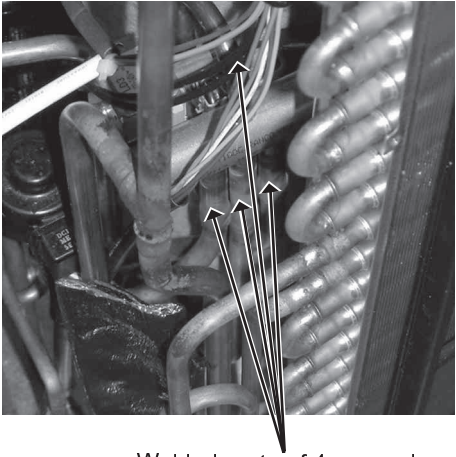

OPERATING PROCEDURE	PHOTOS
<p>5. Removing outdoor fan motor</p> <ol style="list-style-type: none">(1) Remove the top panel, cabinet and service panel. (Refer to 1.)(2) Disconnect the indoor/outdoor connecting wire and remove the back panel. (Refer to 1.)(3) Remove the inverter assembly. (Refer to 2.)(4) Remove the propeller.(5) Remove the screws fixing the fan motor. (Photo 7)(6) Remove the fan motor. (Photo 7)	<p>Photo 7</p>  <p>Propeller</p> <p>Screws of outdoor fan motor</p>
<p>6. Removing the compressor and 4-way valve</p> <ol style="list-style-type: none">(1) Remove the top panel, cabinet and service panel. (Refer to 1.)(2) Disconnect the indoor/outdoor connecting wire and remove the back panel. (Refer to 1.)(3) Remove the inverter assembly. (Refer to 2.)(4) Recover gas from the refrigerant circuit.(5) Detach the welded part of the suction and the discharge pipe connected with compressor.(6) Remove the nuts of compressor legs.(7) Remove the compressor.(8) Detach the welded part of pipes connected with 4-way valve. (Photo 8) <p>NOTE</p> <ul style="list-style-type: none">● Before using a burner, reclaim gas from the pipes until the pressure gauge shows 0 kg/cm² (0MPa).● Use the burner under the condition that gas can be recovered even when the inner pressure rises by heat.	<p>Photo 8</p>  <p>Welded parts of 4-way valve</p>

MUZ-A09YV -E1 MUZ-A12YV -E1
 MUZ-A09YVH -E1 MUZ-A12YVH -E1

13-1. OUTDOOR UNIT STRUCTURAL PARTS AND FUNCTIONAL PARTS

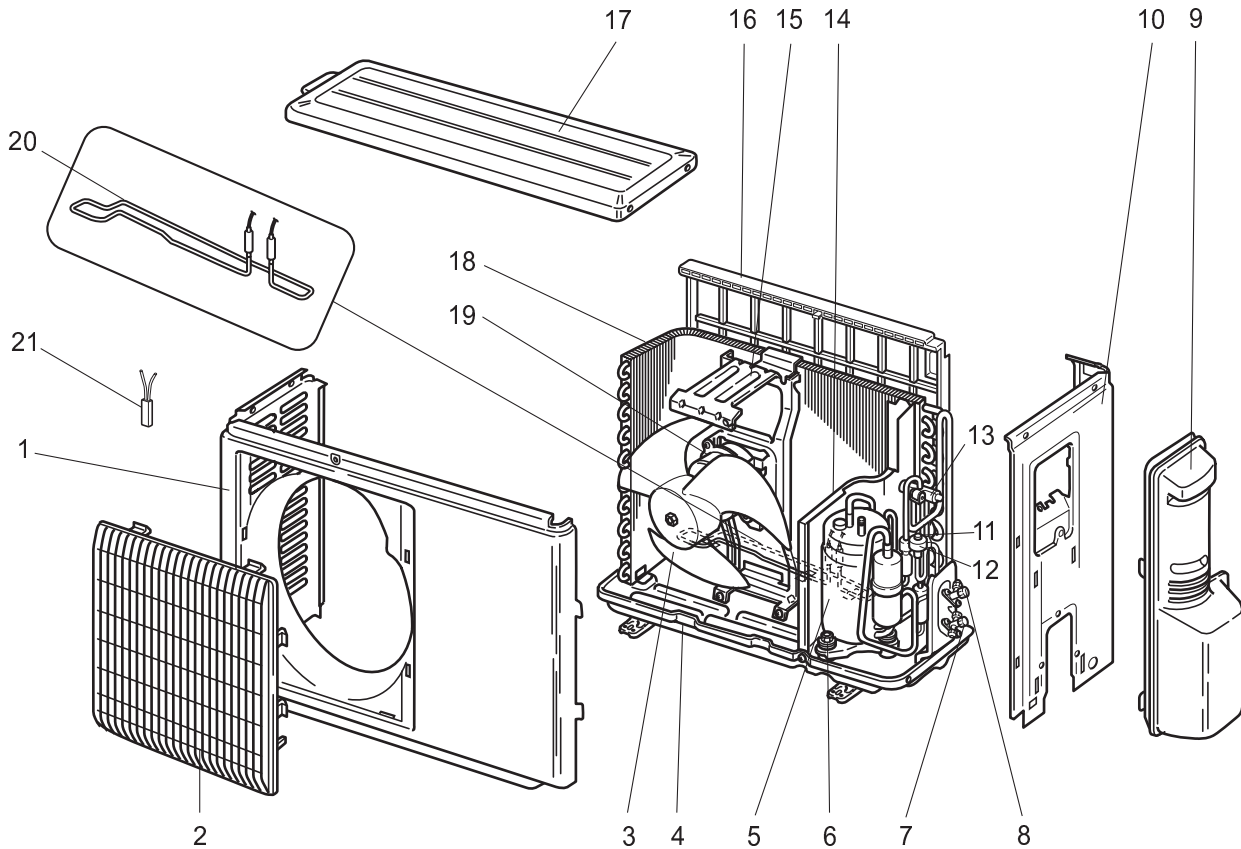

Part number that is circled is not shown in the illustration.

No.	Part No.	Part Name	Symbol in Wiring Diagram	Q'ty/unit				Remarks
				MUZ-A09YV-E1	MUZ-A09YVH-E1	MUZ-A12YV-E1	MUZ-A12YVH-E1	
1	E02 838 232	CABINET		1	1	1	1	
2	E02 838 521	GRILLE		1	1	1	1	
3	E02 838 501	PROPELLER		1	1	1	1	
4	E02 838 290	BASE		1		1		
	E02 840 290	BASE			1		1	
5	E02 838 900	COMPRESSOR	MC	1	1			KNB073FBVH
	E02 839 900	COMPRESSOR	MC			1	1	KNB092FAAH
6	E02 065 506	COMPRESSOR RUBBER SET		3	3	3	3	3RUBBERS/SET
7	E02 838 661	STOP VALVE (GAS)		1	1	1	1	φ9.52
8	E02 838 662	STOP VALVE (LIQUID)		1	1	1	1	φ6.35
9	E02 838 245	SERVICE PANEL		1	1	1	1	
10	E02 838 233	BACK PANEL		1	1	1	1	
11	E02 838 640	EXPANSION VALVE		1	1	1	1	
12	E02 838 493	EXPANSION VALVE COIL	LEV	1	1	1	1	
13	E02 838 961	4-WAY VALVE		1	1	1	1	
	E02 838 293	SEPARATOR		1		1		
14	E02 838 293	SEPARATOR		1				
	E02 840 293	SEPARATOR			1		1	
15	E02 838 515	MOTOR SUPPORT		1	1	1	1	
16	E02 838 523	CONDENSER NET		1	1	1	1	
17	E02 838 297	TOP PANEL		1	1	1	1	
18	E02 838 630	OUTDOOR HEAT EXCHANGER		1	1			
	E02 839 630	OUTDOOR HEAT EXCHANGER				1	1	
19	E02 838 301	OUTDOOR FAN MOTOR	MF	1	1	1	1	RA6V21-□□
20	E02 840 526	DEFROST HEATER	H		1		1	
21	E02 840 381	HEATER PROTECTOR	26H		1		1	
22	E02 282 937	CAPILLARY TUBE		1	1	1	1	φ3.0×φ2.0×200

MUZ-A09YV -[E1] MUZ-A12YV -[E1]
 MUZ-A09YVH -[E1] MUZ-A12YVH -[E1]

13-2. OUTDOOR UNIT ELECTRICAL PARTS

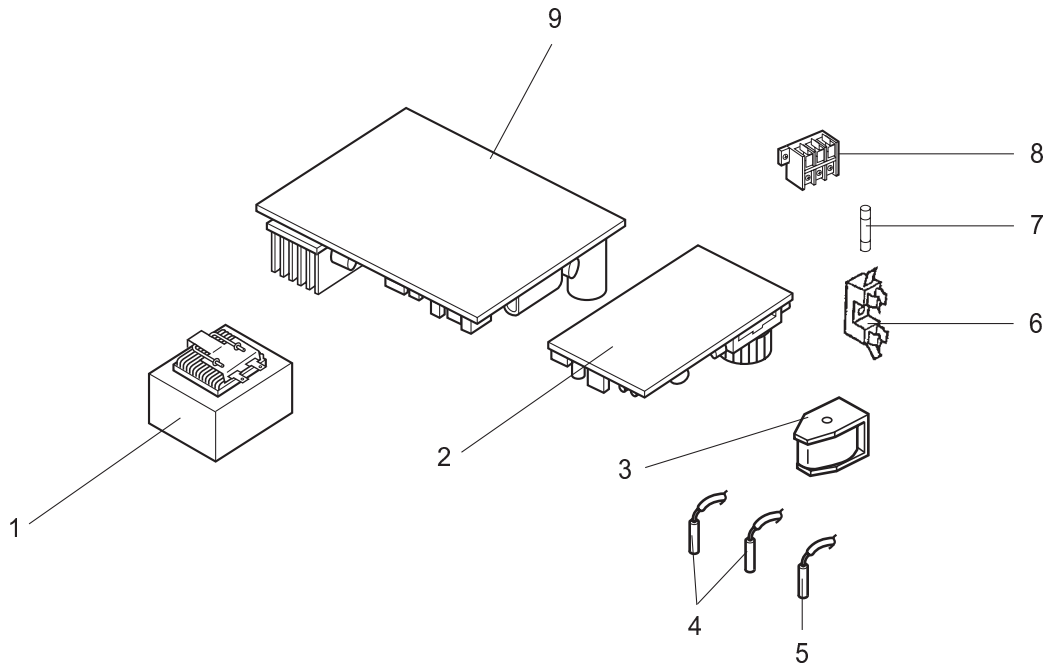

No.	Part No.	Part Name	Symbol in Wiring Diagram	Q'ty/unit				Remarks
				MUZ-A09YV-[E1]	MUZ-A09YVH-[E1]	MUZ-A12YV-[E1]	MUZ-A12YVH-[E1]	
1	E02 838 337	REACTOR	L61	1	1	1	1	
2	E02 838 444	POWER P.C. BOARD		1		1		
	E02 840 444	POWER P.C. BOARD			1		1	
3	E02 838 490	R.V. COIL	21S4	1	1	1	1	
4	E02 838 306	THERMISTOR SET	RT61,RT62	1	1	1	1	DEFROST, DISCHARGE
5	E02 838 308	AMBIENT TEMPERATURE THERMISTOR	RT65	1	1	1	1	
6	E02 735 241	FUSE HOLDER		1	1	1	1	
7	E02 735 382	FUSE	F61	1	1	1	1	250V/20A
8	E02 838 374	TERMINAL BLOCK	TB	1	1	1	1	3P
9	E02 838 451	INVERTER P.C. BOARD		1	1			Including heat sink and RT64
	E02 839 451	INVERTER P.C. BOARD				1	1	Including heat sink and RT64

MUZ-A09YV -E1

MUZ-A12YV -E1

13-3. DRAIN SOCKET

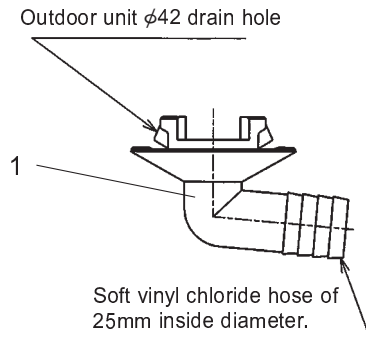

No.	Parts No.	Parts Name	Symbol in Wiring Diagram	Q'ty/unit		Remarks
				MUZ-A09YV- E1	MUZ-A12YV- E1	
1	E02 838 704	DRAIN SOCKET		1	1	

 **MITSUBISHI ELECTRIC CORPORATION**

HEAD OFFICE: MITSUBISHI DENKI BLDG., 2-2-3, MARUNOUCHI, CHIYODA-KU, TOKYO100-8310, JAPAN

© Copyright 2004 MITSUBISHI ELECTRIC ENGINEERING CO.,LTD

Distributed in Apr. 2004. No. OB328 REVISED EDITION-A 6

Distributed in Jan. 2004. No. OB328 6

Made in Japan

New publication, effective Apr. 2004

Specifications subject to change without notice.