

Revision E:

•MUZ-GA35VA(H) -E3 has been added.

Please void OB379 REVISED EDITION-D.

OUTDOOR UNIT SERVICE MANUAL



**No. OB379
REVISED EDITION-E**

Wireless type Models

MUZ-GA25VA	-E1
MUZ-GA25VA	-E2
MUZ-GA25VA	-E3
MUZ-GA25VA	-E4
MUZ-GA35VA	-E1
MUZ-GA35VA	-E2
MUZ-GA35VA	-E3
MUZ-GA25VAH	-E1
MUZ-GA25VAH	-E2
MUZ-GA25VAH	-E3
MUZ-GA25VAH	-E4
MUZ-GA35VAH	-E1
MUZ-GA35VAH	-E2
MUZ-GA35VAH	-E3

Indoor unit service manual
MSZ-GA•VA Series (OB378)
MSZ-CB•VA Series (OB441)

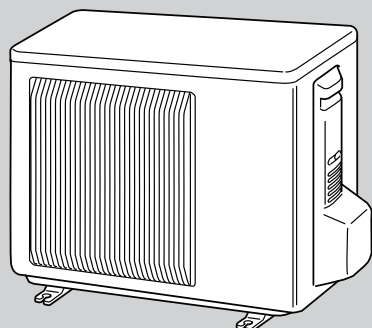

CONTENTS

1. TECHNICAL CHANGES	2
2. PART NAMES AND FUNCTIONS	7
3. SPECIFICATION	8
4. NOISE CRITERIA CURVES	10
5. OUTLINES AND DIMENSIONS	11
6. WIRING DIAGRAM	12
7. REFRIGERANT SYSTEM DIAGRAM	20
8. PERFORMANCE CURVES	23
9. ACTUATOR CONTROL	31
10. SERVICE FUNCTIONS	32
11. TROUBLESHOOTING	32
12. DISASSEMBLY INSTRUCTIONS	53
13. PARTS LIST	56
14. RoHS PARTS LIST	60

NOTE:

RoHS compliant products have <G> mark on the spec name plate.
For servicing of RoHS compliant products, refer to the RoHS Parts List.



13

PARTS LIST (non-RoHS compliant)

MUZ-GA25VA MUZ-GA35VA
MUZ-GA25VAH MUZ-GA35VAH

13-1. OUTDOOR UNIT STRUCTURAL PARTS AND FUNCTIONAL PARTS

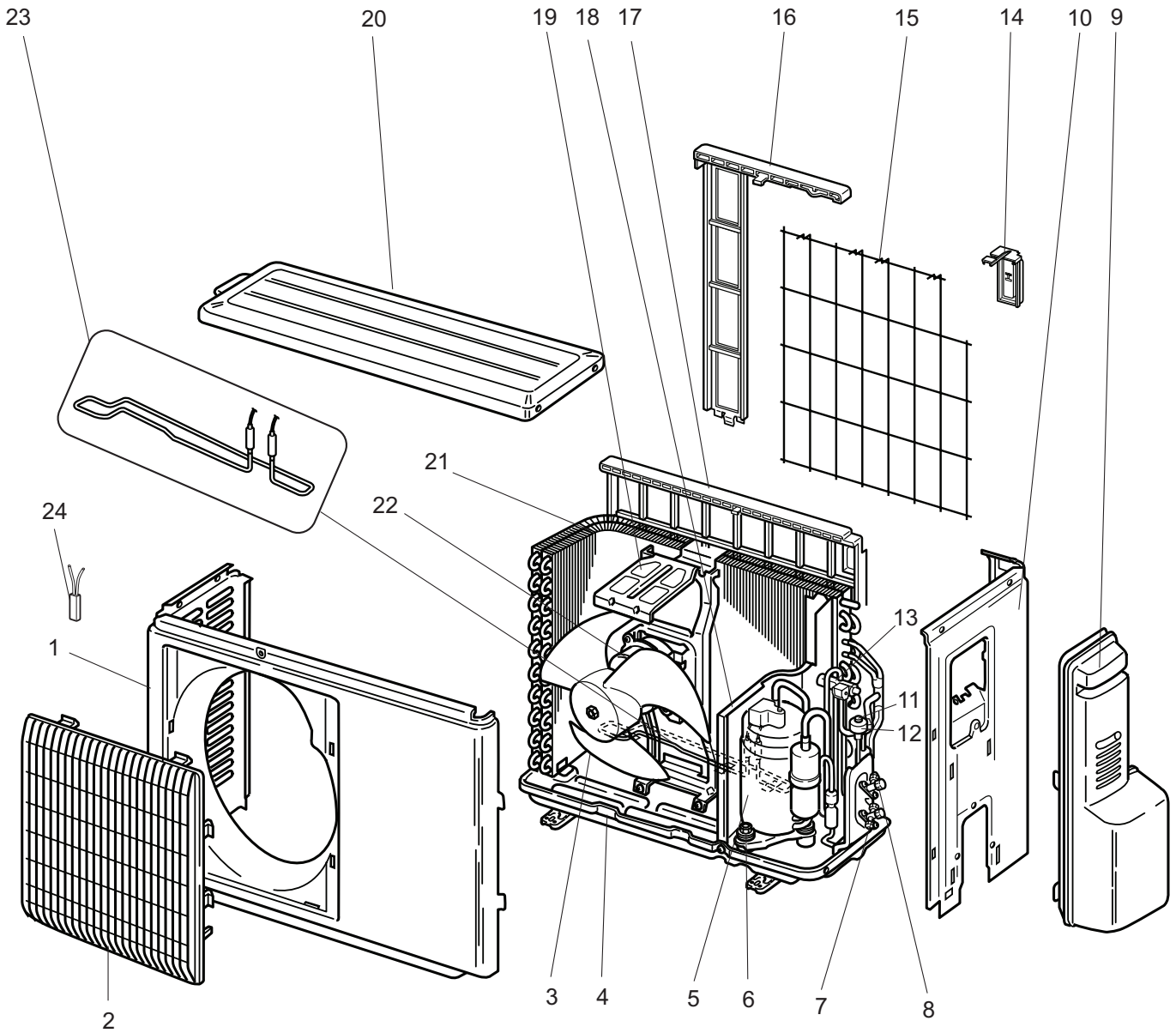

PARTS LIST (non-RoHS compliant)

MUZ-GA25VA MUZ-GA35VA
MUZ-GA25VAH MUZ-GA35VAH

13-1. OUTDOOR UNIT STRUCTURAL PARTS AND FUNCTIONAL PARTS

Part numbers that are circled are not shown in the illustration.

No.	Part No.	Part Name	Symbol in Wiring Diagram	Q'ty/unit								Remarks	
				MUZ- GA25VA-		MUZ- GA25VAH-		MUZ- GA35VA-		MUZ- GA35VAH-			
				E1	E2	E1	E2	E1	E2	E1	E2		
1	E02 927 232	CABINET		1	1	1	1	1	1	1	1	1	
2	E02 927 521	GRILLE		1	1	1	1	1	1	1	1	1	
3	E02 931 501	PROPELLER		1	1	1	1						
	E02 927 501	PROPELLER						1	1	1	1		
4	E02 927 290	BASE		1	1			1	1				
	E02 928 290	BASE				1	1				1	1	
5	E02 928 900	COMPRESSOR	MC	1	1	1	1						KNB065FDTH
	E02 927 900	COMPRESSOR	MC					1	1	1	1		KNB073FDVH
6	E02 065 506	COMPRESSOR RUBBER SET		3	3	3	3	3	3	3	3	3	3RUBBERS/SET
7	E02 927 661	STOP VALVE (GAS)		1	1	1	1	1	1	1	1	1	φ9.52
8	E02 927 662	STOP VALVE (LIQUID)		1	1	1	1	1	1	1	1	1	φ6.35
9	E02 927 245	SERVICE PANEL		1	1	1	1	1	1	1	1	1	
10	E02 927 233	BACK PANEL		1	1	1	1	1	1	1	1	1	
11	E02 927 640	EXPANSION VALVE						1	1	1	1		
12	E02 927 493	EXPANSION VALVE COIL	LEV					1	1	1	1		
13	E02 927 961	4-WAY VALVE						1	1	1	1		
	E02 931 961	4-WAY VALVE		1	1	1	1						
14	E02 928 079	THERMO HOLDER				1	1				1	1	
15	E02 928 525	CONDENSER WIRE NET				1	1				1	1	
16	E02 928 523	CONDENSER NET				1	1				1	1	
17	E02 838 523	CONDENSER NET		1	1			1	1				
18	E02 927 293	SEPARATOR		1	1			1	1				
	E02 928 293	SEPARATOR				1	1				1	1	
19	E02 899 515	MOTOR SUPPORT		1	1	1	1						
	E02 927 515	MOTOR SUPPORT						1	1	1	1		
20	E02 927 297	TOP PANEL		1	1	1	1	1	1	1	1	1	
21	E02 927 630	OUTDOOR HEAT EXCHANGER		1	1	1	1	1	1	1	1	1	
22	E02 931 301	OUTDOOR FAN MOTOR	MF	1	1	1	1						RA6V21-□□
	E02 927 301	OUTDOOR FAN MOTOR	MF					1	1	1	1		RC0J50-□□
23	E02 840 526	DEFROST HEATER	H			1	1				1	1	
24	E02 840 381	HEATER PROTECTOR	26H			1	1				1	1	
25	E02 927 937	CAPILLARY TUBE						1	1	1	1		φ3.0×φ2.0×240
	E02 096 936	CAPILLARY TUBE		1	1	1	1						φ3.0×φ1.4×800
	E02 156 936	CAPILLARY TUBE		1	1	1	1						φ3.0×φ1.4×500
26	E02 096 642	CHECK VALVE		1	1	1	1						
27	E02 932 490	SOLENOID VALVE COIL	21R1	1	1	1	1						
28	E02 931 492	SOLENOID VALVE		1	1	1	1						

PARTS LIST (non-RoHS compliant)

MUZ-GA25VA MUZ-GA35VA
 MUZ-GA25VAH MUZ-GA35VAH

13-2. OUTDOOR UNIT ELECTRICAL PARTS

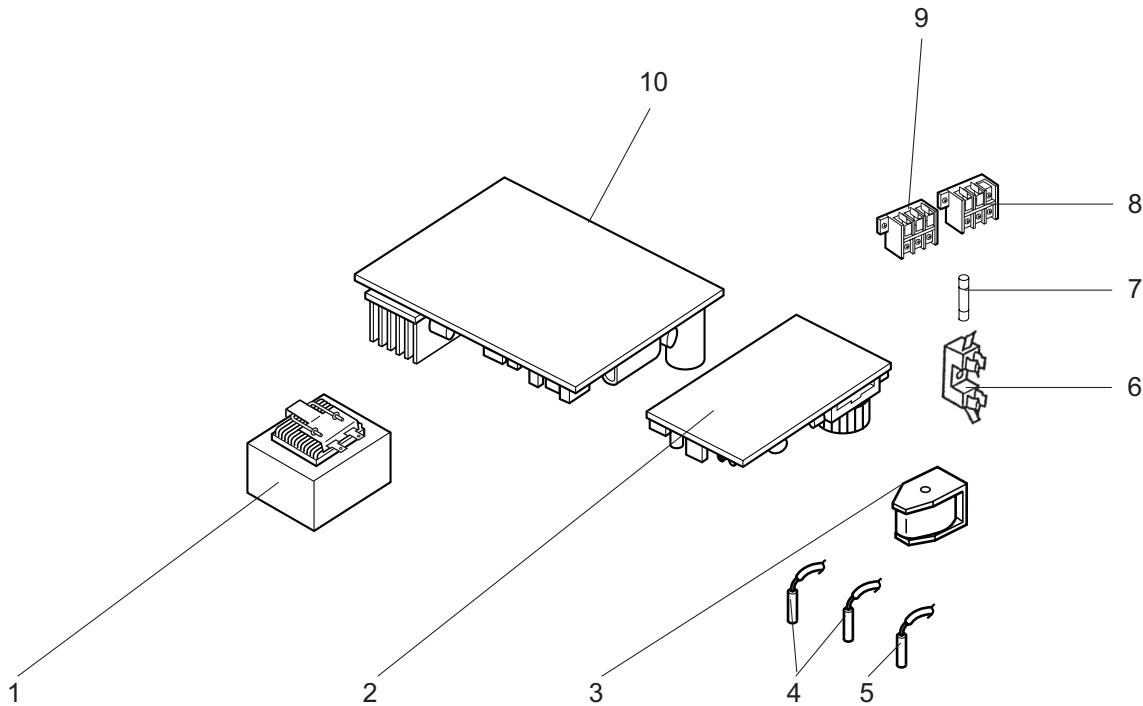

Part numbers that are circled are not shown in the illustration.

No.	Part No.	Part Name	Symbol in Wiring Diagram	Q'ty/unit								Remarks
				MUZ-GA25VA-		MUZ-GA25VAH-		MUZ-GA35VA-		MUZ-GA35VAH-		
				E1	E2	E1	E2	E1	E2	E1	E2	
1	E02 838 337	REACTOR	L61	1	1	1	1	1	1	1	1	
2	E02 927 444	POWER P.C. BOARD						1	1			
	E02 931 444	POWER P.C. BOARD								1	1	
	E02 928 444	POWER P.C. BOARD		1	1							
	E02 932 444	POWER P.C. BOARD				1	1					
3	E02 927 490	R.V. COIL	21S4					1	1	1	1	
	E02 928 490	R.V. COIL	21S4	1	1	1	1					
4	E02 927 306	THERMISTOR SET	RT61,RT62	1	1	1	1	1	1	1	1	DEFROST, DISCHARGE
5	E02 927 308	AMBIENT TEMPERATURE THERMISTOR	RT65	1	1	1	1	1	1	1	1	
6	E02 735 241	FUSE HOLDER		1	1	1	1	1	1	1	1	
7	E02 735 382	FUSE	F61	1	1	1	1	1	1	1	1	T20AL250V
8	E02 573 375	TERMINAL BLOCK	TB1	1	1	1	1	1	1	1	1	3P
9	E02 927 374	TERMINAL BLOCK	TB2	1	1	1	1	1	1	1	1	3P
10	E02 928 451	INVERTER P.C. BOARD		1								Including heat sink and RT64
	E02 932 451	INVERTER P.C. BOARD				1	1					Including heat sink and RT64
	E02 B40 451	INVERTER P.C. BOARD						1	1			Including heat sink and RT64
	E02 B41 451	INVERTER P.C. BOARD								1	1	Including heat sink and RT64
	E02 A77 451	INVERTER P.C. BOARD			1							Including heat sink and RT64
⑪	E02 127 382	FUSE	F71,F801,F901	1	1	1	1	1	1	1	1	T3.15AL250V
⑫	E02 661 385	VARISTOR	NR62,NR63,NR64	1	1	1	1	1	1	1	1	
⑬	E02 927 385	VARISTOR		1	1	1	1	1	1	1	1	

PARTS LIST (non-RoHS compliant)

MUZ-GA25VA MUZ-GA35VA 13-3. DRAIN SOCKET

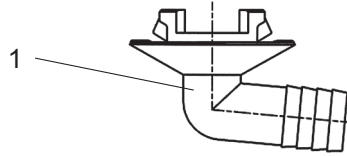

No.	Parts No.	Parts Name	Symbol in Wiring Diagram	Q'ty/unit				Remarks
				MUZ-GA25VA- E1	MUZ-GA25VA- E2	MUZ-GA35VA- E1	MUZ-GA35VA- E2	
1	E02 838 704	DRAIN SOCKET		1	1	1	1	

MUZ-GA25VA -E1 MUZ-GA35VA -E1 MUZ-GA25VAH -E1 MUZ-GA35VAH -E1 13-4. QUICK CLEAN KIT

●You can clean the surface of the heat exchanger and line flow fan if you attach QUICK CLEAN KIT to your vacuum cleaner.

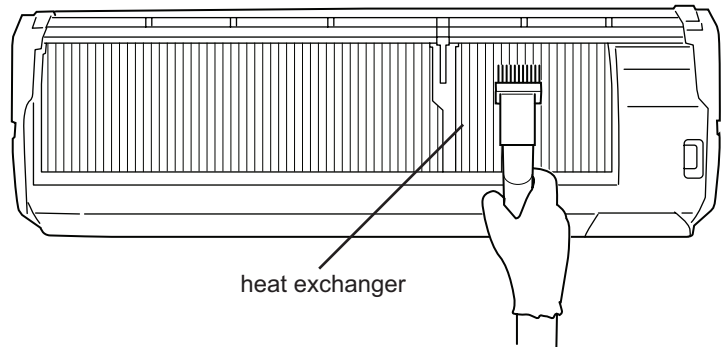
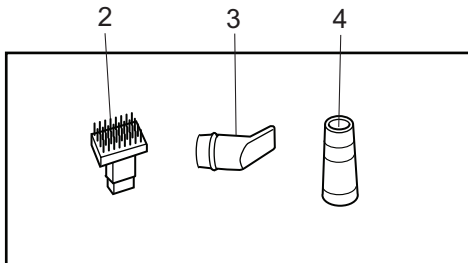

No.	Parts No.	Parts Name	Symbol in Wiring Diagram	Q'ty/unit				Remarks
				MUZ-GA25VA- E1	MUZ-GA25VAH- E1	MUZ-GA35VA- E1	MUZ-GA35VAH- E1	
2	E02 927 113	BRUSH		1	1	1	1	
3	E02 927 115	NOZZLE		1	1	1	1	
4	E02 927 112	UNIVERSAL ADAPTER		1	1	1	1	

NOTE : Quick clean kit has been removed from E2 model.

MUZ-GA25VA MUZ-GA35VA
 MUZ-GA25VAH MUZ-GA35VAH

14-1. OUTDOOR UNIT STRUCTURAL PARTS AND FUNCTIONAL PARTS

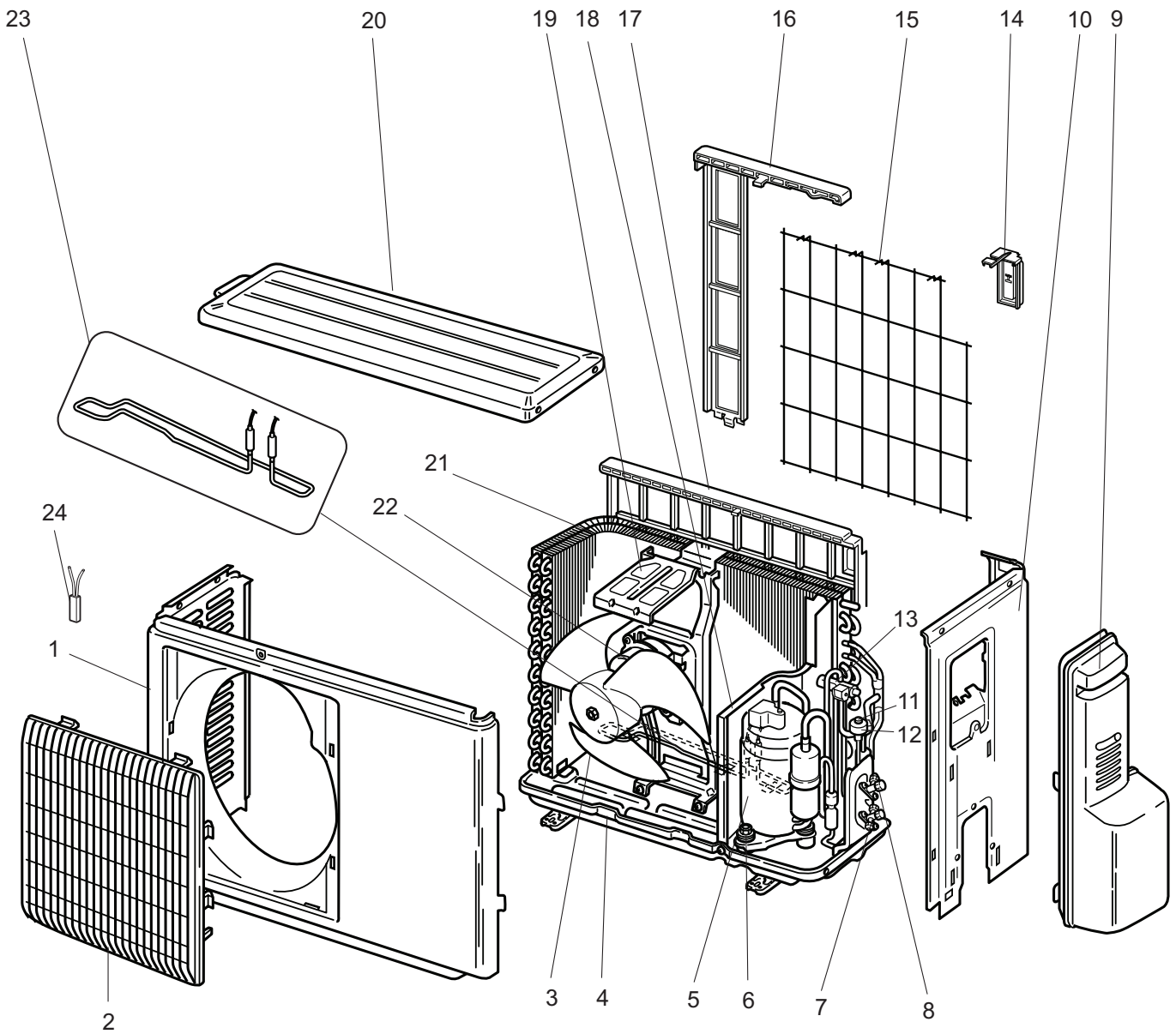

RoHS PARTS LIST (RoHS compliant)

MUZ-GA25VA MUZ-GA35VA
 MUZ-GA25VAH MUZ-GA35VAH

14-1. OUTDOOR UNIT STRUCTURAL PARTS AND FUNCTIONAL PARTS

Part numbers that are circled are not shown in the illustration.

No.	RoHS	Part No.	Part Name	Symbol in Wiring Diagram	Q'ty/unit												Remarks
					MUZ- GA25VA-			MUZ- GA25VAH-			MUZ- GA35VA-		MUZ- GA35VAH-				
					E2	E3	E4	E2	E3	E4	E2	E3	E2	E3			
1	G	E12 927 232	CABINET		1	1	1	1	1	1	1	1	1	1			
2	G	E12 927 521	GRILLE		1	1	1	1	1	1	1	1	1	1			
3	G	E12 931 501	PROPELLER		1	1	1	1	1	1							
	G	E12 927 501	PROPELLER								1	1	1	1			
4	G	E12 927 290	BASE		1	1	1				1	1					
	G	E12 928 290	BASE					1	1	1				1	1		
5	G	E12 928 900	COMPRESSOR	MC	1	1	1	1	1	1					KNB065FDTH		
	G	E12 927 900	COMPRESSOR	MC							1			1	KNB073FDVH		
	G	E12 B93 900	COMPRESSOR	MC								1		1	KNB073FGDH		
6	G	E12 065 506	COMPRESSOR RUBBER SET		3	3	3	3	3	3	3	3	3	3	3RUBBERS/SET		
7	G	E12 927 661	STOP VALVE (GAS)		1	1	1	1	1	1	1	1	1	1	φ9.52		
8	G	E12 927 662	STOP VALVE (LIQUID)		1	1	1	1	1	1	1	1	1	1	φ6.35		
9	G	E12 927 245	SERVICE PANEL		1	1	1	1	1	1	1	1	1	1			
10	G	E12 927 233	BACK PANEL		1	1	1	1	1	1	1	1	1	1			
11	G	E12 927 640	EXPANSION VALVE								1	1	1	1			
12	G	E12 927 493	EXPANSION VALVE COIL	LEV							1	1	1	1			
13	G	E12 927 961	4-WAY VALVE								1	1	1	1			
	G	E12 931 961	4-WAY VALVE		1	1	1	1	1	1							
14	G	E12 928 079	THERMO HOLDER					1	1	1				1	1		
15	G	E12 928 525	CONDENSER WIRE NET					1	1	1				1	1		
16	G	E12 928 523	CONDENSER NET					1	1	1				1	1		
17	G	E12 838 523	CONDENSER NET		1	1	1				1	1					
18	G	E12 927 293	SEPARATOR		1	1	1				1	1					
	G	E12 928 293	SEPARATOR					1	1	1				1	1		
19	G	E12 899 515	MOTOR SUPPORT		1	1	1	1	1	1							
	G	E12 927 515	MOTOR SUPPORT								1	1	1	1			
20	G	E12 927 297	TOP PANEL		1	1	1	1	1	1	1	1	1	1			
21	G	E12 927 630	OUTDOOR HEAT EXCHANGER		1	1	1	1	1	1	1			1			
	G	E12 B83 630	OUTDOOR HEAT EXCHANGER									1			1		
22	G	E12 931 301	OUTDOOR FAN MOTOR	MF	1	1	1	1	1	1					RA6V21-□□		
	G	E12 927 301	OUTDOOR FAN MOTOR	MF							1	1	1	1	RC0J50-□□		
23	G	E12 840 526	DEFROST HEATER	H				1	1	1				1	1		
24	G	E12 840 381	HEATER PROTECTOR	26H				1	1	1				1	1		
25	G	E12 927 937	CAPILLARY TUBE								1	1	1	1	φ3.0×φ2.0×240		
	G	E12 096 936	CAPILLARY TUBE		1	1	1	1	1	1					φ3.0×φ1.4×800		
	G	E12 156 936	CAPILLARY TUBE		1	1		1	1						φ3.0×φ1.4×500		
	G	E12 642 936	CAPILLARY TUBE			1	1		1	1					φ3.0×φ1.4×400		
26	G	E12 096 642	CHECK VALVE		1	1		1	1								
	G	E12 B45 642	CHECK VALVE			1	1		1	1							
27	G	E12 932 490	SOLENOID VALVE COIL	21R1	1	1		1	1								
28	G	E12 931 492	SOLENOID VALVE		1	1		1	1								

RoHS PARTS LIST (RoHS compliant)

MUZ-GA25VA MUZ-GA35VA
 MUZ-GA25VAH MUZ-GA35VAH

14-2. OUTDOOR UNIT ELECTRICAL PARTS

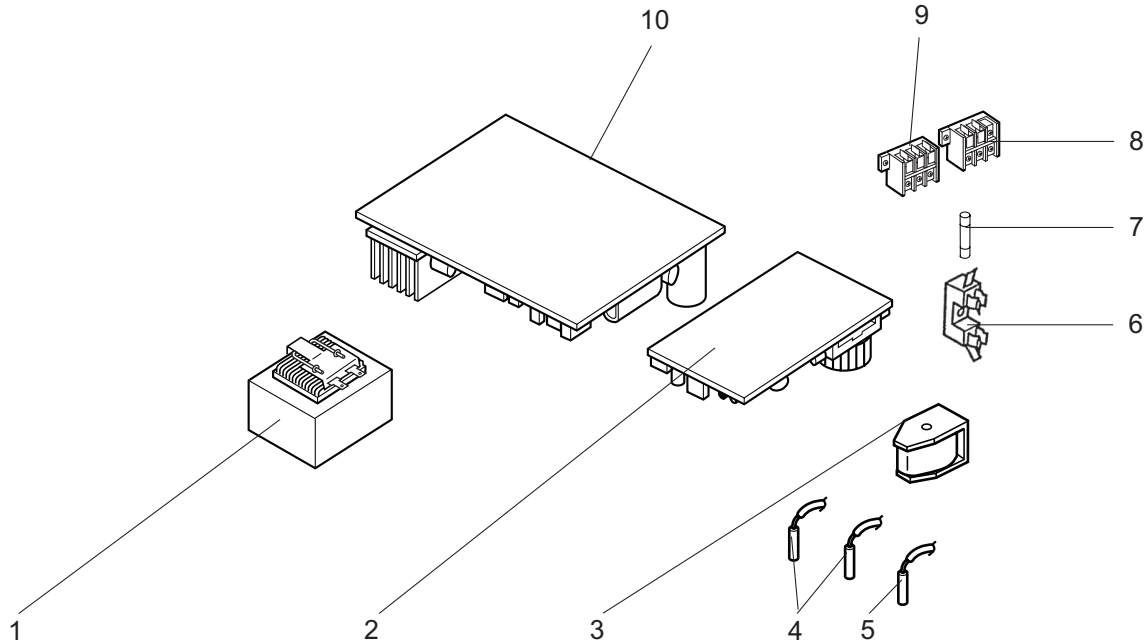

Part numbers that are circled are not shown in the illustration.

No.	RoHS	Part No.	Part Name	Symbol in Wiring Diagram	Q'ty/unit												Remarks
					MUZ-GA25VA-			MUZ-GA25VAH-			MUZ-GA35VA-		MUZ-GA35VAH-				
					E2	E3	E4	E2	E3	E4	E2	E3	E2	E3			
1	G	E12 838 337	REACTOR	L61	1	1	1	1	1	1	1	1	1	1	1		
2	G	E12 927 444	POWER P.C. BOARD									1					
	G	E12 931 444	POWER P.C. BOARD											1			
	G	E12 928 444	POWER P.C. BOARD		1	1											
	G	E12 C01 444	POWER P.C. BOARD				1										
	G	E12 932 444	POWER P.C. BOARD					1	1								
	G	E12 C02 444	POWER P.C. BOARD							1							
	G	E12 B83 444	POWER P.C. BOARD									1					
	G	E12 B85 444	POWER P.C. BOARD												1		
3	G	E12 927 490	R.V. COIL	21S4							1	1	1	1			
	G	E12 928 490	R.V. COIL	21S4	1	1	1	1	1	1							
4	G	E12 927 306	THERMISTOR SET	RT61,RT62	1	1	1	1	1	1	1		1			DEFROST, DISCHARGE	
	G	E12 B83 306	THERMISTOR SET	RT61,RT62									1		1	DEFROST, DISCHARGE	
5	G	E12 927 308	AMBIENT TEMPERATURE THERMISTOR	RT65	1	1	1	1	1	1	1	1	1	1	1		
6	G	E12 735 241	FUSE HOLDER		1	1	1	1	1	1	1	1	1	1	1		
7	G	E12 735 382	FUSE	F61	1	1	1	1	1	1	1	1	1	1	1	T20AL250V	
8	G	E12 573 375	TERMINAL BLOCK	TB1	1	1	1	1	1	1	1	1	1	1	1	3P	
9	G	E12 927 374	TERMINAL BLOCK	TB2	1	1	1	1	1	1	1	1	1	1	1	3P	
10	G	E12 A77 451	INVERTER P.C. BOARD		1	1	1									Including heat sink and RT64	
	G	E12 A79 451	INVERTER P.C. BOARD					1	1	1						Including heat sink and RT64	
	G	E12 B40 451	INVERTER P.C. BOARD								1					Including heat sink and RT64	
	G	E12 B41 451	INVERTER P.C. BOARD										1			Including heat sink and RT64	
	G	E12 C59 451	INVERTER P.C. BOARD									1				Including heat sink and RT64	
	G	E12 C99 451	INVERTER P.C. BOARD												1	Including heat sink and RT64	
(11)	G	E12 127 382	FUSE	F71,F801,F901	1	1	1	1	1	1	1	1	1	1	1	T3.15AL250V	
(12)	G	E12 661 385	VARISTOR	NR62,NR63,NR64	1	1	1	1	1	1	1	1	1	1	1		
13	G	E12 927 385	VARISTOR		1	1	1	1	1	1	1	1	1	1	1		

RoHS PARTS LIST (RoHS compliant)

MUZ-GA25VA MUZ-GA35VA
14-3. DRAIN SOCKET

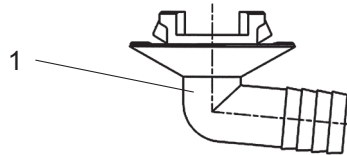

No.	RoHS	Parts No.	Parts Name	Symbol in Wiring Diagram	Q'ty/unit					Remarks
					MUZ-GA25VA-			MUZ-GA35VA-		
					E2	E3	E4	E2	E3	
1	G	E12 838 704	DRAIN SOCKET		1	1	1	1	1	



HEAD OFFICE: TOKYO BLDG., 2-7-3, MARUNOUCHI, CHIYODA-KU, TOKYO 100-8310, JAPAN

© Copyright 2005 MITSUBISHI ELECTRIC ENGINEERING CO.,LTD

Distributed in Jun. 2007. No. OB379 REVISED EDITION-E 6

Distributed in May 2007. No. OB379 REVISED EDITION-D 6

Distributed in Feb. 2007. No. OB379 REVISED EDITION-C 6

Distributed in May 2006. No. OB379 REVISED EDITION-B 6

Distributed in Jan. 2006. No. OB379 REVISED EDITION-A 6

Distributed in Jan. 2005. No. OB379 6

Made in Japan

New publication, effective Jun. 2007

Specifications subject to change without notice.