

July 2006

 No. OC313
 REVISED EDITION-B

TECHNICAL & SERVICE MANUAL

Series PLFY Ceiling Cassettes

R410A / R407C / R22
**Indoor unit
[Model names]**

 PLFY-P32VAM-E

 PLFY-P40VAM-E

 PLFY-P50VAM-E

 PLFY-P63VAM-E

 PLFY-P80VAM-E

 PLFY-P100VAM-E

 PLFY-P125VAM-E

[Service Ref.]
**PLFY-P32VAM-E.UK
 PLFY-P40VAM-E.UK
 PLFY-P50VAM-E.UK
 PLFY-P63VAM-E.UK
 PLFY-P80VAM-E.UK
 PLFY-P100VAM-E.UK
 PLFY-P125VAM-E.UK**
Revision:

- RoHS PARTS LIST is added.
- Some descriptions have been modified.

- Please void OC313 REVISED EDITION-A.

Note:

- This manual does not cover outdoor units. When servicing them, please refer to the outdoor unit's service manual.
- RoHS compliant products have <G> mark on the spec name plate.
- For servicing of RoHS compliant products, refer to the RoHS Parts List.

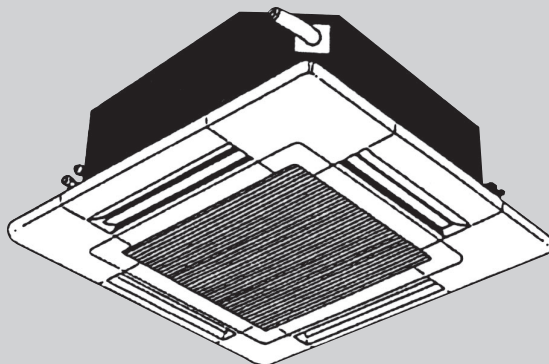

INDOOR UNIT

CONTENTS

1. SAFETY PRECAUTION.....	2
2. PART NAMES AND FUNCTIONS	6
3. SPECIFICATIONS.....	8
4. 4-WAY AIR FLOW SYSTEM	11
5. OUTLINES AND DIMENSIONS.....	14
6. WIRING DIAGRAM	15
7. REFRIGERANT SYSTEM DIAGRAM	16
8. TROUBLE SHOOTING	17
9. DISASSEMBLY PROCEDURE	24
10. PARTS LIST.....	27
11. RoHS PARTS LIST	32
12. OPTIONAL PARTS	37

PLFY-P32/40/50/63/80/100/125VAM-E.UK

Be careful on removing heavy parts.

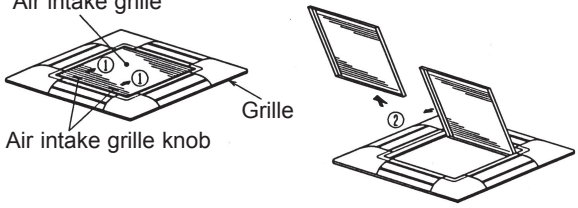
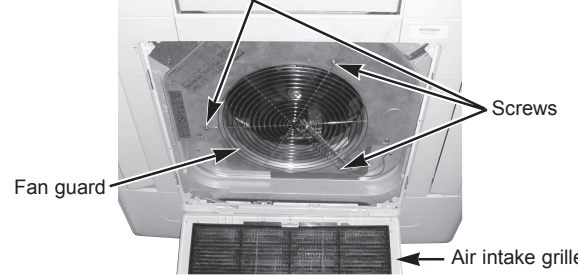
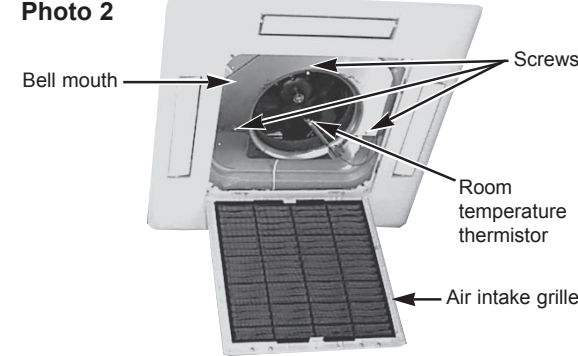
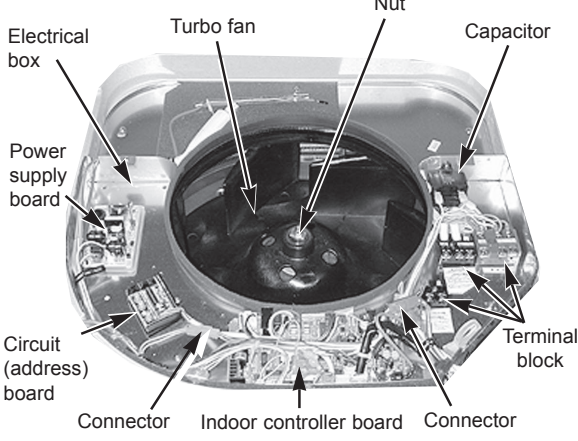
OPERATING PROCEDURE	PHOTOS&ILLUSTRATIONS
<p>1. Removing the air intake grille</p> <p>(1) Slide the knob of air intake grille to the direction of the arrow ① to open the air intake grille.</p> <p>(2) Remove the string hook from the panel to prevent the grille from dropping.</p> <p>(3) Slide the shaft in the hinge to the direction of the arrow ② and remove the air intake grille.</p>	<p>Figure 1</p> 
<p>2. Removing the fan guard</p> <p>(1) Open the air intake grille.</p> <p>(2) Remove the 3 screws of fan guard.</p>	<p>Photo 1</p> 
<p>3. Removing the room temperature thermistor</p> <p>(1) Remove the fan guard. (See photo 1)</p> <p>(2) Remove the screw (X1) in the room temperature thermistor holder to remove the holder and the room temperature thermistor.</p> <p>(3) Remove the 1 screw from the bell mouth, and unscrew the another 2 screws (fixed to the oval hole which has different diameter) to remove the bell mouth.</p> <p>(4) Hold the holder claw, and remove the room temperature thermistor and holder.</p> <p>(5) Disconnect the connector (red) in the indoor control board.</p>	<p>Photo 2</p> 
<p>4. Removing the electrical box</p> <p>(1) Remove the fan guard. (See photo 1)</p> <p>(2) Remove the lead wire of the vane motor from the clamp, and disconnect the white connector (10P).</p> <p>(3) Remove the room temperature thermistor with the holder.</p> <p>(4) Remove the bell mouth. (See photo 2)</p> <p>(5) Disconnect the relay connector in the electrical box.</p> <p>Red (3P) for fan motor power supply White (2P) for pipe temperature detection / liquid thermistor Black (2P) for pipe temperature detection / gas thermistor Blue (2P) for drain pump White (3P) for drain sensor</p> <p>(6) Remove the 3 screws from the electrical box, loosen another 2 screws to remove the box.</p> <p><Electrical parts in the electrical box></p> <p>Indoor controller board power supply board Terminal block (Power supply) Terminal block (Transmission) Terminal block (MA remote controller) Capacitor Circuit(address) board</p>	<p>Photo 3</p> 

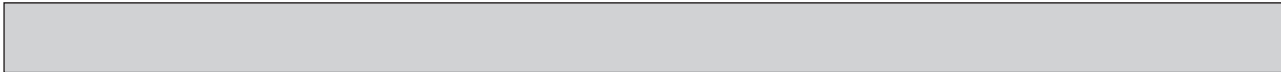

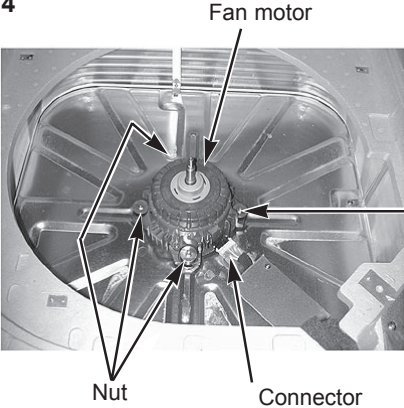
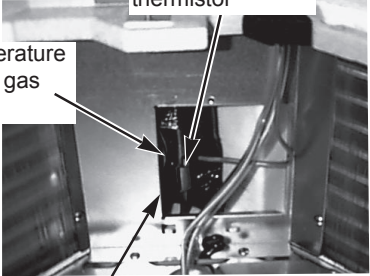
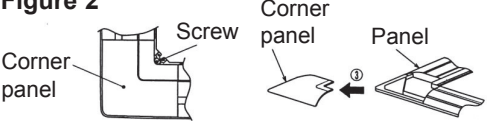
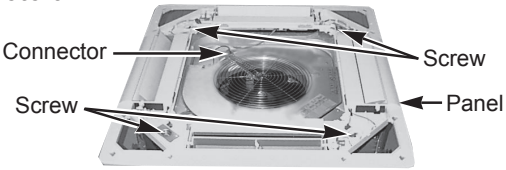
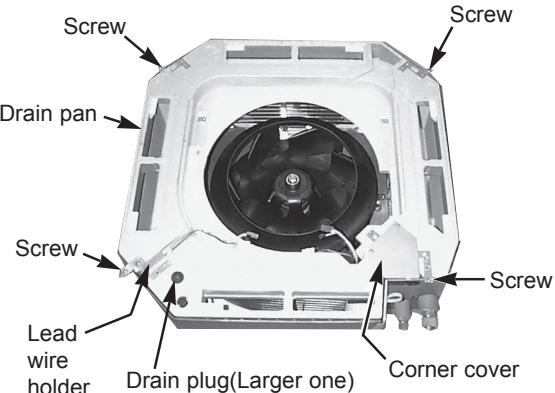
OPERATING PROCEDURE	PHOTOS&ILLUSTRATIONS
<p>5. Removing the fan motor</p> <ol style="list-style-type: none"> (1) Remove the fan guard.(See photo 1) (2) Remove the bell mouth.(See photo 2) (3) Remove the electrical box.(See photo 3) (4) Remove the turbo fan nut, washer and radiation cap(P100, P125). (5) Pull out the turbo fan. (6) Disconnect the connector of the fan motor lead wire. (7) Remove the 4 nuts of the fan motor. 	<p>Photo 4</p>  <p>Fan motor</p> <p>Nut</p> <p>Nut</p> <p>Connector</p>
<p>6. Removing the pipe temperature detection / liquid thermistor and the pipe temperature detection / gas thermistor</p> <ol style="list-style-type: none"> (1) Remove the fan guard.(See photo 1) (2) Remove the bell mouth.(See photo 2) (3) Remove the electrical box.(See photo 3) (4) Remove the turbo fan. (5) Remove the screw of the service panel. (6) Remove the service panel. (7) Remove the pipe temperature detection / liquid thermistor and the pipe temperature detection / gas thermistor which are inserted into the holder installed to the thin copper pipe. (8) Disconnect the each 2-pin white(liquid) and black(gas) connector. 	<p>Photo 5</p>  <p>Pipe temperature detection / liquid thermistor</p> <p>Pipe temperature detection / gas thermistor</p> <p>Service entrance</p>
<p>7. Removing the panel</p> <p>(1) Remove the air intake grille.(See figure 1)</p> <p>Corner panel (See figure 2)</p> <ol style="list-style-type: none"> (1) Remove the screw of the corner. (2) Slide the corner panel to the direction of the arrow ③, and remove the corner panel. <p>Panel (See photo 6)</p> <ol style="list-style-type: none"> (1) Disconnect the connector that connects with the unit. (2) Remove the 2 screws from the panel and loose another 2 screws, which fixed to the oval hole, have different diameter. (3) Rotate the panel a little to remove the panel. (Slide the panel so that the screw comes to a large diameter of the oval hole, which has two different diameters.) 	<p>Figure 2</p>  <p>Corner panel</p> <p>Screw</p> <p>Panel</p> <p>Photo 6</p>  <p>Connector</p> <p>Screw</p> <p>Screw</p> <p>Panel</p>
<p>8. Removing the drain pan</p> <ol style="list-style-type: none"> (1) Remove the panel. (See photo 6) (2) Remove the drain plug (Larger one), drain the remaining water in the drain pan. (3) Remove the corner cover. (2 screws) (4) Remove the bell mouth. (See photo 2) (5) Remove the electrical box. (See photo 3) (6) Remove the lead wire holder. (1 screw) (7) Remove the 4 screws and pull out the drain pan. <p>* Pull out the left and right of the pan gradually. Be careful not to crack or damage the pan.</p>	<p>Photo 7</p>  <p>Screw</p> <p>Screw</p> <p>Drain pan</p> <p>Screw</p> <p>Screw</p> <p>Lead wire holder</p> <p>Drain plug(Larger one)</p> <p>Corner cover</p>

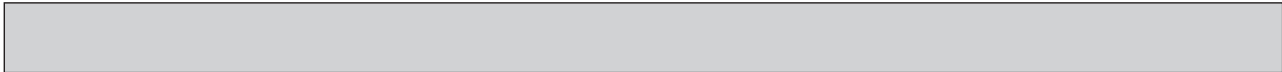

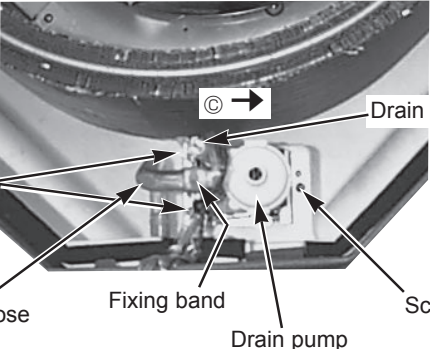
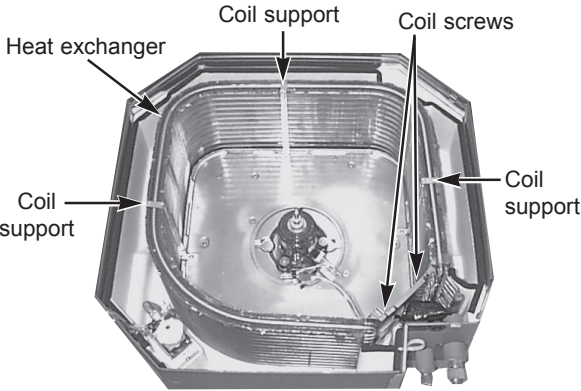
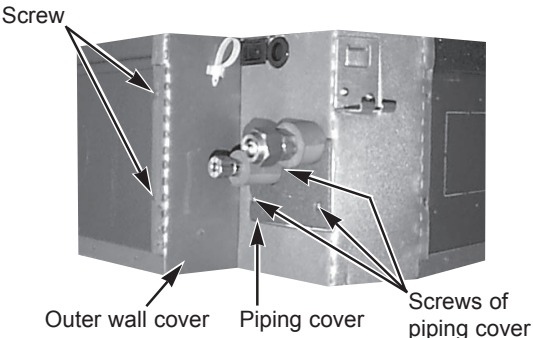
OPERATING PROCEDURE	PHOTOS&ILLUSTRATIONS
<p>9. Removing the drain pump and drain sensor</p> <ol style="list-style-type: none">(1) Remove the panel. (See photo 6)(2) Remove the fan guard. (See photo 1)(3) Remove the bell mouth. (See photo 2)(4) Remove the electrical box. (See photo 3)(5) Remove the drain pan. (See photo 7)(6) Cut the drain hose band with scissors and pull out the drain hose from the drain pump.(7) Loosen the screw ① (2 screws) and remove the screw ② (1 screw). Slide the drain pump in the direction of the arrow ③ and remove it.(8) Remove the drain sensor with its holder from the drain pump.	<p>Photo 8</p> 
<p>10. Removing the heat exchanger</p> <ol style="list-style-type: none">(1) Remove the panel. (See photo 6)(2) Remove the fan guard. (See photo 1)(3) Remove the bell mouth. (See photo 2)(4) Remove the electrical box. (See photo 3)(5) Remove the drain pan. (See photo 7)(6) Remove the turbo fan. (See photo 4)(7) Remove the 3 screws of the piping cover, and pull out piping cover.(8) Remove the 4 screws of the outer wall cover, and pull out the outer wall cover.(9) Remove the screw of the coil support.(10) Remove the 2 screws of the coil.(11) Pull out the heat exchanger.	<p>Photo 9</p>  <p>Photo 10</p> 

PANEL PARTS

PLFY-P32VAM-E.UK

PLFY-P40VAM-E.UK

PLFY-P50VAM-E.UK

PLFY-P63VAM-E.UK

PLFY-P80VAM-E.UK

PLFY-P100VAM-E.UK

PLFY-P125VAM-E.UK

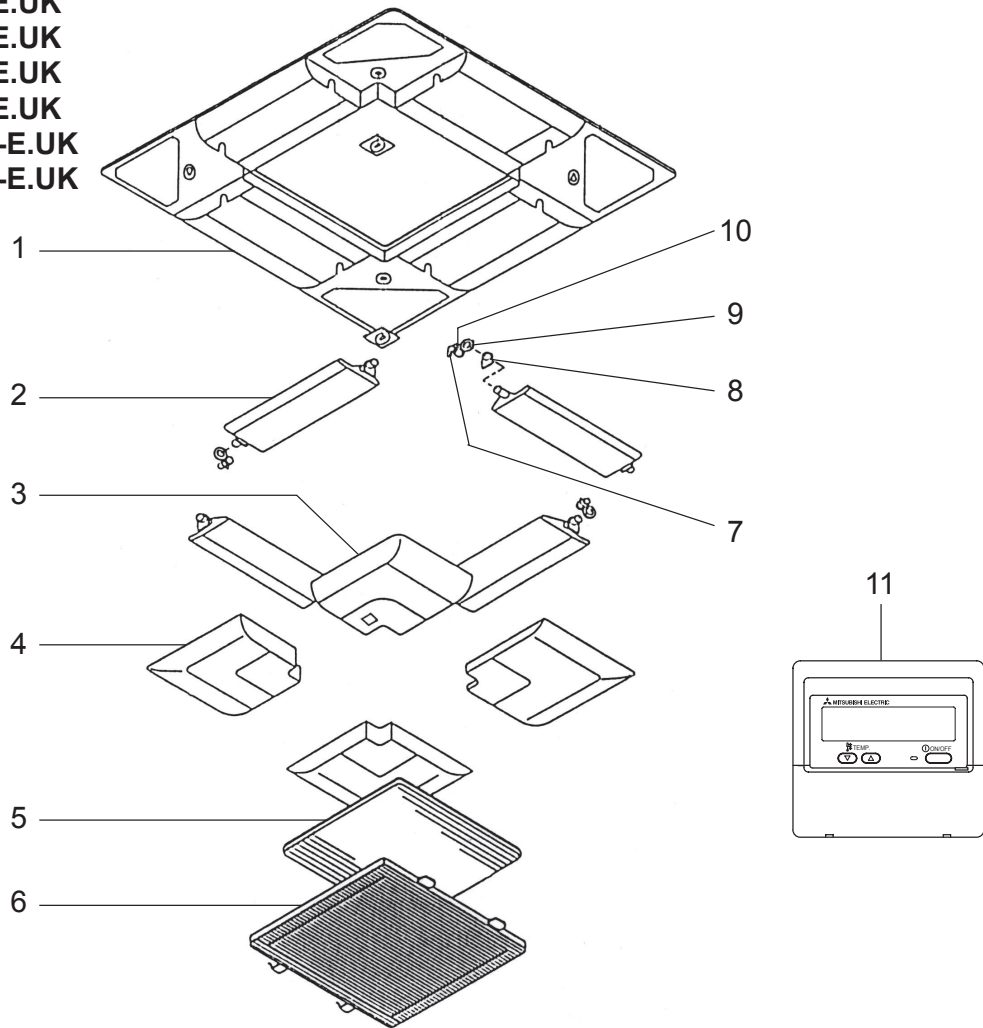

Part number that is circled is not shown in the figure.

No.	Part No.	Part Name	Specification	Q'ty/set	Remarks (Drawing No.)	Wiring Diagram Symbol	Recom- mended Q'ty	Price	
				PLFY- P32, P40, P50, P63 P80, P100, P125 VAM-E.UK				Unit	Amount
1	S70 E10 003	AIR OUTLET GRILLE		1	Including H2				
2	S70 E00 002	AUTO VANE		4					
3	S70 E01 638	CORNER PANEL		1					
4	S70 E00 638	CORNER PANEL		3					
5	S70 E00 500	L.L FILTER		1					
6	S70 E00 691	GRILLE ASSY		1					
7	S70 E00 223	VANE MOTOR		4		MV			
8	S70 E00 063	VANE BUSH		8					
9	S70 E00 040	GEAR (VANE)		4					
10	S70 E01 040	GEAR (MOTOR)		4					
11	S70 KW1 713	REMOTE CONTROLLER	PAR-21MAA	1					
⑫	S70 E01 673	SCREW ASSY		1					

FUNCTIONAL PARTS
PLFY-P32VAM-E.UK
PLFY-P40VAM-E.UK
PLFY-P50VAM-E.UK
PLFY-P63VAM-E.UK

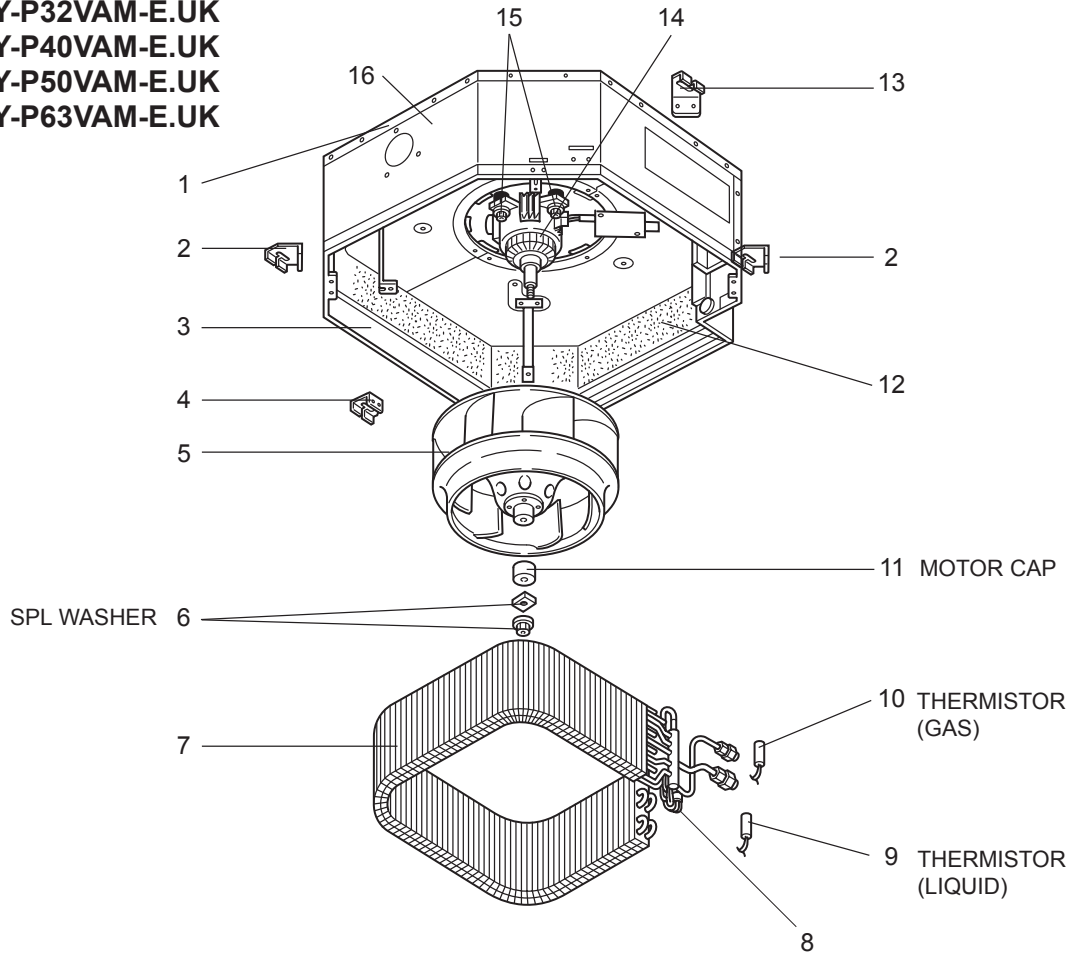

No.	Parts No.	Parts Name	Specification	Q'ty / set				Remarks (Drawing No.)	Wiring Diagram Symbol	Recom- mended Q'ty	Price	
				32	40	50	63				Unit	Amount
1	S70 003 687	BASE DWG		1	1	1	1					
2	S70 E01 130	LEG		2	2	2	2					
3	S70 005 688	DRUM 1 ASSY		1	1	1	1					
4	S70 E00 130	LEG		1	1	1	1					
5	S70 E00 114	TURBO FAN		1	1	1	1					
6	S70 08K 097	SPL WASHER		1	1	1	1					
7	S70 E60 480	HEAT EXCHANGER		1								
	S70 E61 480	HEAT EXCHANGER			1							
	S70 E62 480	HEAT EXCHANGER				1						
	S70 E63 480	HEAT EXCHANGER					1					
8	S70 E60 401	LINEAR EXPANSION VALVE		1	1	1	1	LEV				
9	S70 17J 202	THERMISTOR (LIQUID)		1	1	1	1	TH22				
10	S70 79N 202	THERMISTOR (GAS)		1	1	1	1	TH23				
11	S70 E50 129	MOTOR CAP		1	1	1	1					
12	S70 E00 659	INNER COVER ASSY		1	1	1	1					
13	S70 E02 130	LEG		1	1	1	1					
14	S70 E06 762	FAN MOTOR	D17B6P70MS	1	1	1	1	MF				
15	S70 A41 105	MOTOR MOUNT		4	4	4	4					
16	S70 006 688	DRUM 2 ASSY		1	1	1	1					

FUNCTIONAL PARTS

PLFY-P80VAM-E.UK
 PLYF-P100VAM-E.UK
 PLYF-P125VAM-E.UK

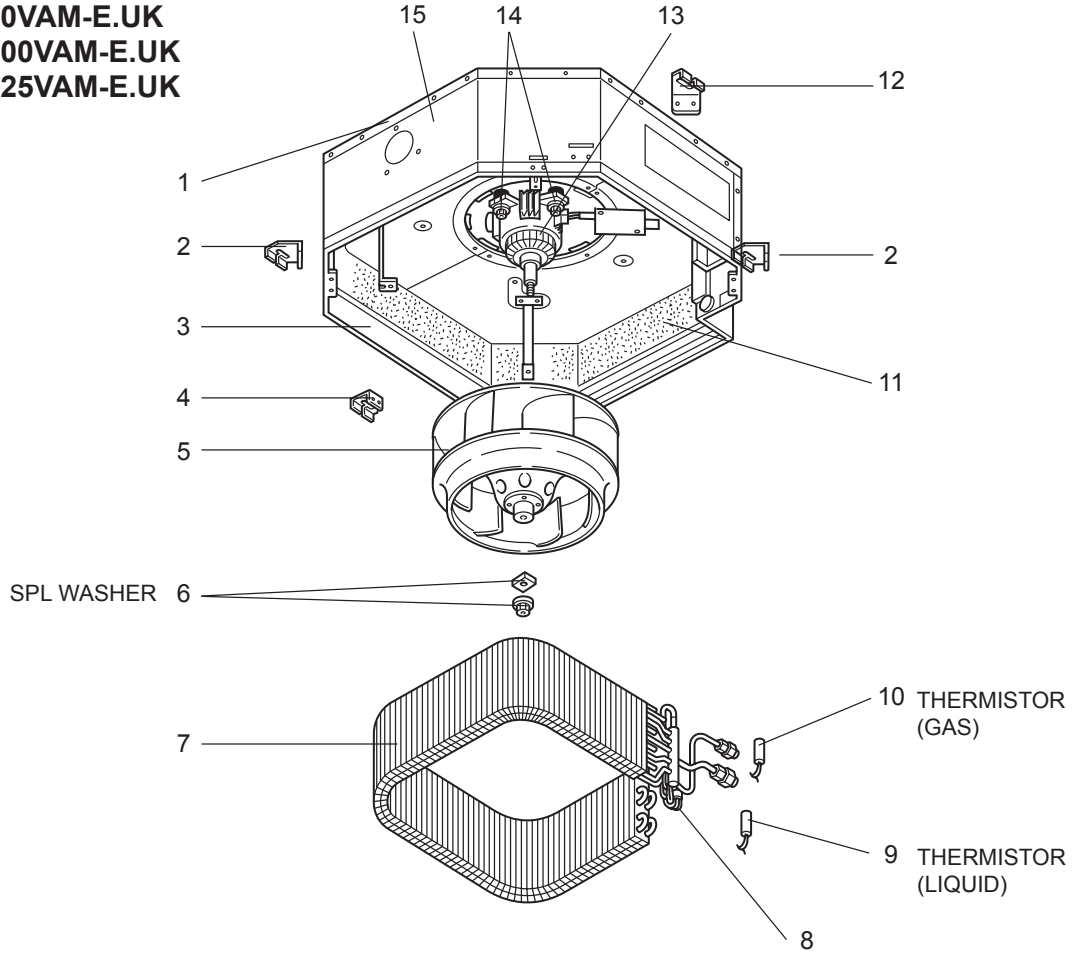

No.	Parts No.	Parts Name	Specification	Q'ty / set			Remarks (Drawing No.)	Wiring Diagram Symbol	Recom-mended Q'ty	Price	
				PLFY-P-VAM-E.UK						Unit	Amount
				80	100	125					
1	S70 003 687	BASE DWG		1	1	1					
2	S70 E01 130	LEG		2	2	2					
3	S70 005 688	DRUM 1 ASSY		1							
	S70 007 688	DRUM 1 ASSY			1	1					
4	S70 E00 130	LEG		1	1	1					
5	S70 E00 114	TURBO FAN		1							
	S70 E01 114	TURBO FAN			1	1					
6	S70 08K 097	SPL WASHER		1	1	1					
7	S70 E64 480	HEAT EXCHANGER		1							
	S70 E65 480	HEAT EXCHANGER			1	1					
8	S70 E70 401	LINEAR EXPANSION VALVE		1	1	1		LEV			
9	S70 17J 202	THERMISTOR (LIQUID)		1	1	1		TH22			
10	S70 79N 202	THERMISTOR (GAS)		1	1	1		TH23			
11	S70 E00 659	INNER COVER ASSY		1							
	S70 E02 659	INNER COVER ASSY			1	1					
12	S70 E02 130	LEG		1	1	1					
13	S70 E06 762	FAN MOTOR	D17B6P70MS	1				MF			
	S70 E07 762	FAN MOTOR	D176P120MS		1	1		MF			
14	S70 A41 105	MOTOR MOUNT		4	4	4					
15	S70 006 688	DRUM 2 ASSY		1							
	S70 008 688	DRUM 2 ASSY			1	1					

FUNCTIONAL PARTS
PLFY-P32VAM-E.UK
PLFY-P40VAM-E.UK
PLFY-P50VAM-E.UK
PLFY-P63VAM-E.UK

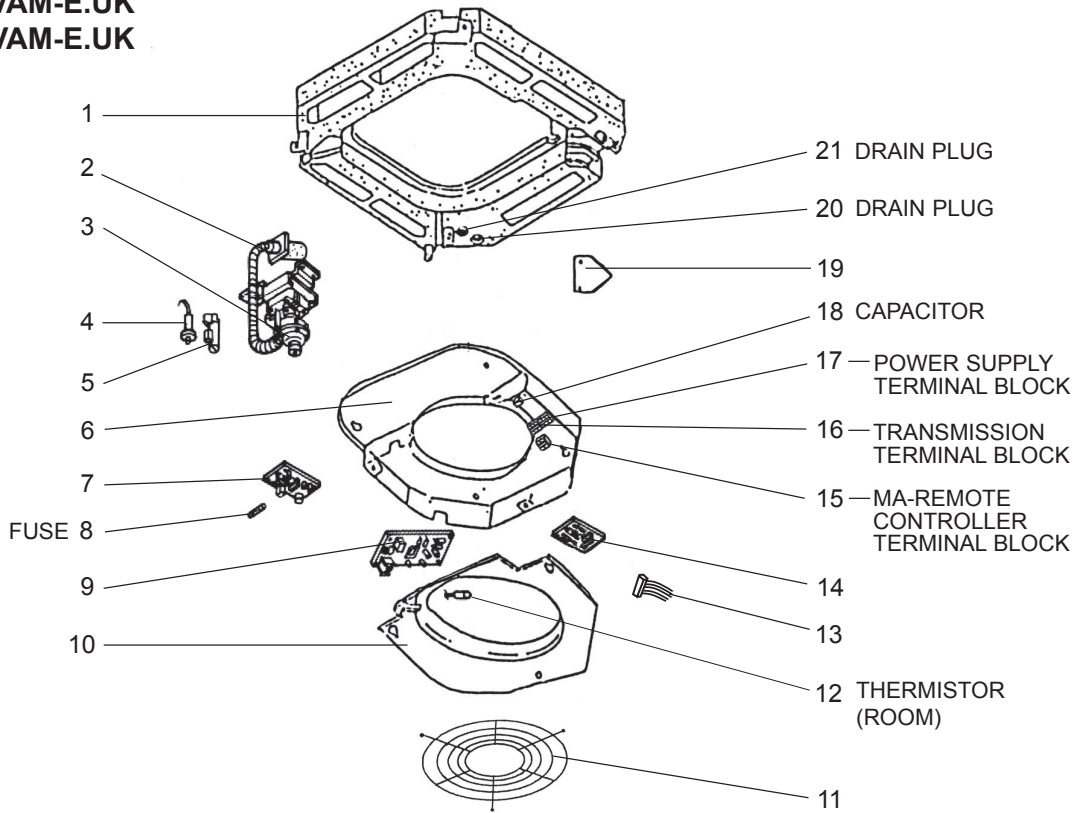

No.	Parts No.	Parts Name	Specification	Q'ty / set		Remarks (Drawing No.)	Wiring Diagram Symbol	Recommended Q'ty	Price	
				PLFY-P-VAM-E.UK	32, 40, 50, 63				Unit	Amount
1	S70 E02 529	DRAIN PAN		1						
2	S70 A41 523	DRAIN SOCKET		1						
3	S70 E01 355	DRAIN PUMP		1		DP				
4	S70 E00 266	DRAIN SENSOR		1		DS				
5	S70 31K 241	DRAIN SENSOR HOLDER		1						
6	S70 E00 503	CONTROL BOX		1						
7	S70 E02 313	POWER BOARD		1		P.B				
8	S70 520 239	FUSE	6.3A 250V	1		FUSE				
9	S70 E35 310	INDOOR CONTROLLER BOARD		1		I.B *				
10	S70 003 503	CONTROL COVER ASSY		1						
11	S70 E10 675	FAN GUARD		1						
12	S70 E00 202	THERMISTOR (ROOM)		1		TH21				
13	S70 E00 304	ADDRESS CABLE		1						
14	S70 B02 294	ADDRESS BOARD		1		A.B				
15	S70 512 716	MA-REMOTE CONTROLLER TERMINAL BLOCK	2P(1, 2)	1		TB15				
16	S70 B02 716	TRANSMISSION TERMINAL BLOCK	3P(M1, M2, S)	1		TB5				
17	S70 521 716	POWER SUPPLY TERMINAL BLOCK	3P(L, N, ⊕)	1		TB2				
18	S70 576 255	FAN MOTOR CAPACITOR	3.0μF 440V	1		C				
19	S70 001 663	CORNER COVER		1						
20	S70 A48 524	DRAIN PLUG		1						
21	S70 A41 524	DRAIN PLUG		1						

※ The part name of symbol "I.B" is "SPCB".

FUNCTIONAL PARTS
PLFY-P80VAM-E.UK
PLFY-P100VAM-E.UK
PLFY-P125VAM-E.UK

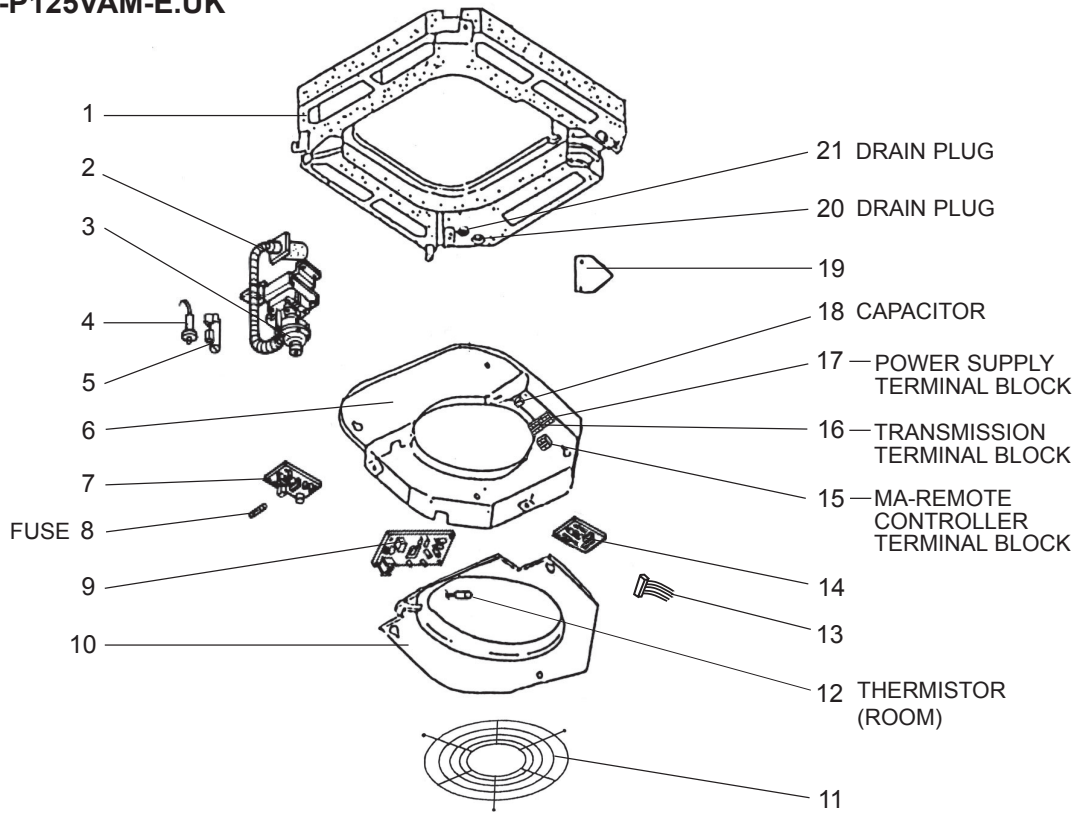

No.	Parts No.	Parts Name	Specification	Q'ty / set		Remarks (Drawing No.)	Wiring Diagram Symbol	Recommended Q'ty	Price	
				PLFY-P-VAM-E.UK					Unit	Amount
				80	100, 125					
1	S70 E02 529	DRAIN PAN		1						
	S70 E01 529	DRAIN PAN			1					
2	S70 A41 523	DRAIN SOCKET		1	1					
3	S70 E01 355	DRAIN PUMP		1	1		DP			
4	S70 E00 266	DRAIN SENSOR		1	1		DS			
5	S70 31K 241	DRAIN SENSOR HOLDER		1	1					
6	S70 E00 503	CONTROL BOX		1	1					
7	S70 E02 313	POWER BOARD		1	1		P.B			
8	S70 520 239	FUSE	6.3A 250V	1	1		FUSE			
9	S70 E35 310	INDOOR CONTROLLER BOARD		1	1		I.B ※			
10	S70 003 503	CONTROL COVER ASSY		1	1					
11	S70 E10 675	FAN GUARD		1	1					
12	S70 E00 202	THERMISTOR (ROOM)		1	1		TH21			
13	S70 E00 304	ADDRESS CABLE		1	1					
14	S70 B02 294	ADDRESS BOARD		1	1					
15	S70 512 716	MA-REMOTE CONTROLLER TERMINAL BLOCK	2P(1, 2)	1	1		A.B			
16	S70 B02 716	TRANSMISSION TERMINAL BLOCK	3P(M1, M2, S)	1	1		TB5			
17	S70 521 716	POWER SPPLY TERMINAL BLOCK	3P(L, N, ⊕)	1	1		TB2			
18	S70 17T 255	FAN MOTOR CAPACITOR	3.5 μ F 440V	1			C			
	S70 E02 255	FAN MOTOR CAPACITOR	7.0 μ F 440V		1		C			
19	S70 001 663	CORNER COVER		1	1					
20	S70 A48 524	DRAIN PLUG		1	1					
21	S70 A41 524	DRAIN PLUG		1	1					

※ The part name of symbol "I.B" is "SPCB".

PANEL PARTS

PLFY-P32VAM-E.UK

PLFY-P40VAM-E.UK

PLFY-P50VAM-E.UK

PLFY-P63VAM-E.UK

PLFY-P80VAM-E.UK

PLFY-P100VAM-E.UK

PLFY-P125VAM-E.UK

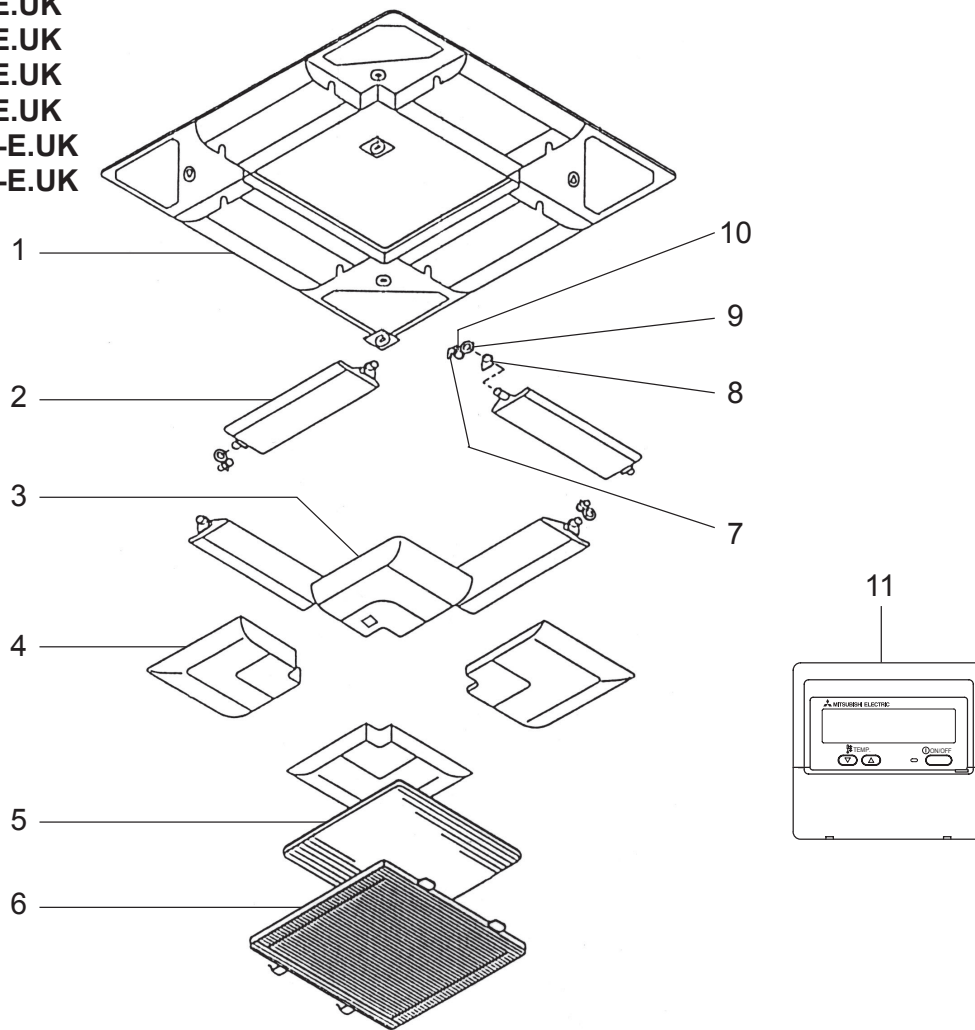

Part number that is circled is not shown in the figure.

No.	RoHS	Part No.	Part Name	Specification	Q'ty/set	Remarks (Drawing No.)	Wiring Diagram Symbol	Recom- mended Q'ty	Price	
					PLFY- P32, P40, P50, P63 P80, P100, P125 VAM-E.UK				Unit	Amount
1	G	S70 E10 003	AIR OUTLET GRILLE		1	Including H2				
2	G	S70 E00 002	AUTO VANE		4					
3	G	S70 E01 638	CORNER PANEL		1					
4	G	S70 E00 638	CORNER PANEL		3					
5	G	S70 E00 500	L.L FILTER		1					
6	G	S70 E00 691	GRILLE ASSY		1					
7	G	S70 E00 223	VANE MOTOR		4		MV			
8	G	S70 E00 063	VANE BUSH		8					
9	G	S70 E00 040	GEAR (VANE)		4					
10	G	S70 E01 040	GEAR (MOTOR)		4					
11	G	S70 KW1 713	REMOTE CONTROLLER	PAR-21MAA	1					
⑫	G	S70 E01 673	SCREW ASSY		1					

FUNCTIONAL PARTS

PLFY-P32VAM-E.UK

PLFY-P40VAM-E.UK

PLFY-P50VAM-E.UK

PLFY-P63VAM-E.UK

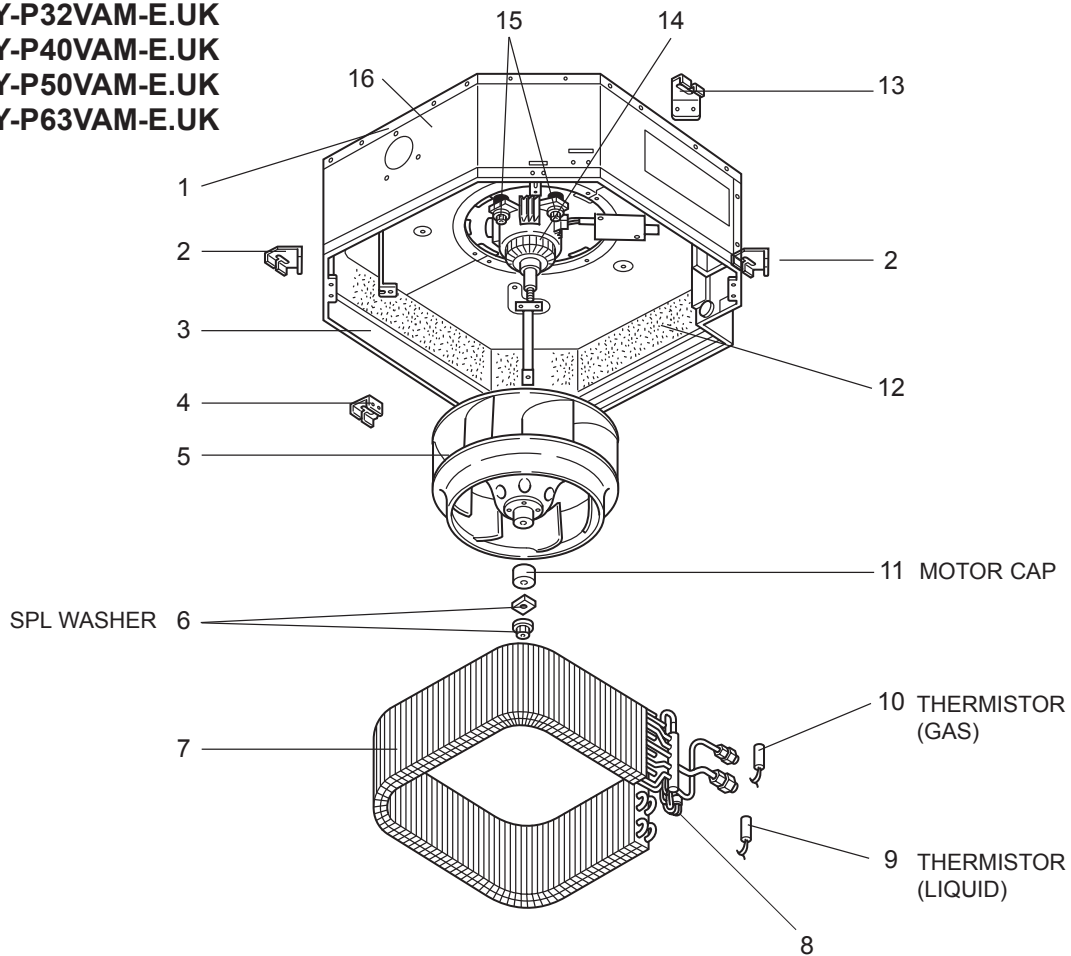

No.	RoHS	Parts No.	Parts Name	Specification	Q'ty / set				Remarks (Drawing No.)	Wiring Diagram Symbol	Recom- mended Q'ty	Price	
					PLFY-P-VAM-E.UK							Unit	Amount
					32	40	50	63					
1	G	S70 003 687	BASE DWG		1	1	1	1					
2	G	S70 E01 130	LEG		2	2	2	2					
3	G	S70 005 688	DRUM 1 ASSY		1	1	1	1					
4	G	S70 E00 130	LEG		1	1	1	1					
5	G	S70 E00 114G	TURBO FAN		1	1	1	1					
6	G	S70 08K 097	SPL WASHER		1	1	1	1					
7	G	S70 E60 480G	HEAT EXCHANGER		1								
	G	S70 E61 480G	HEAT EXCHANGER			1							
	G	S70 E62 480G	HEAT EXCHANGER				1						
	G	S70 E63 480G	HEAT EXCHANGER					1					
8	G	S70 E60 401	LINEAR EXPANSION VALVE		1	1	1	1	LEV				
9	G	S70 17J 202	THERMISTOR (LIQUID)		1	1	1	1	TH22				
10	G	S70 79N 202	THERMISTOR (GAS)		1	1	1	1	TH23				
11	G	S70 E50 129	MOTOR CAP		1	1	1	1					
12	G	S70 E00 659	INNER COVER ASSY		1	1	1	1					
13	G	S70 E02 130	LEG		1	1	1	1					
14	G	S70 E06 762	FAN MOTOR	D17B6P70MS	1	1	1	1	MF				
15	G	S70 A41 105	MOTOR MOUNT		4	4	4	4					
16	G	S70 006 688	DRUM 2 ASSY		1	1	1	1					

FUNCTIONAL PARTS

PLFY-P80VAM-E.UK
 PLYF-P100VAM-E.UK
 PLYF-P125VAM-E.UK

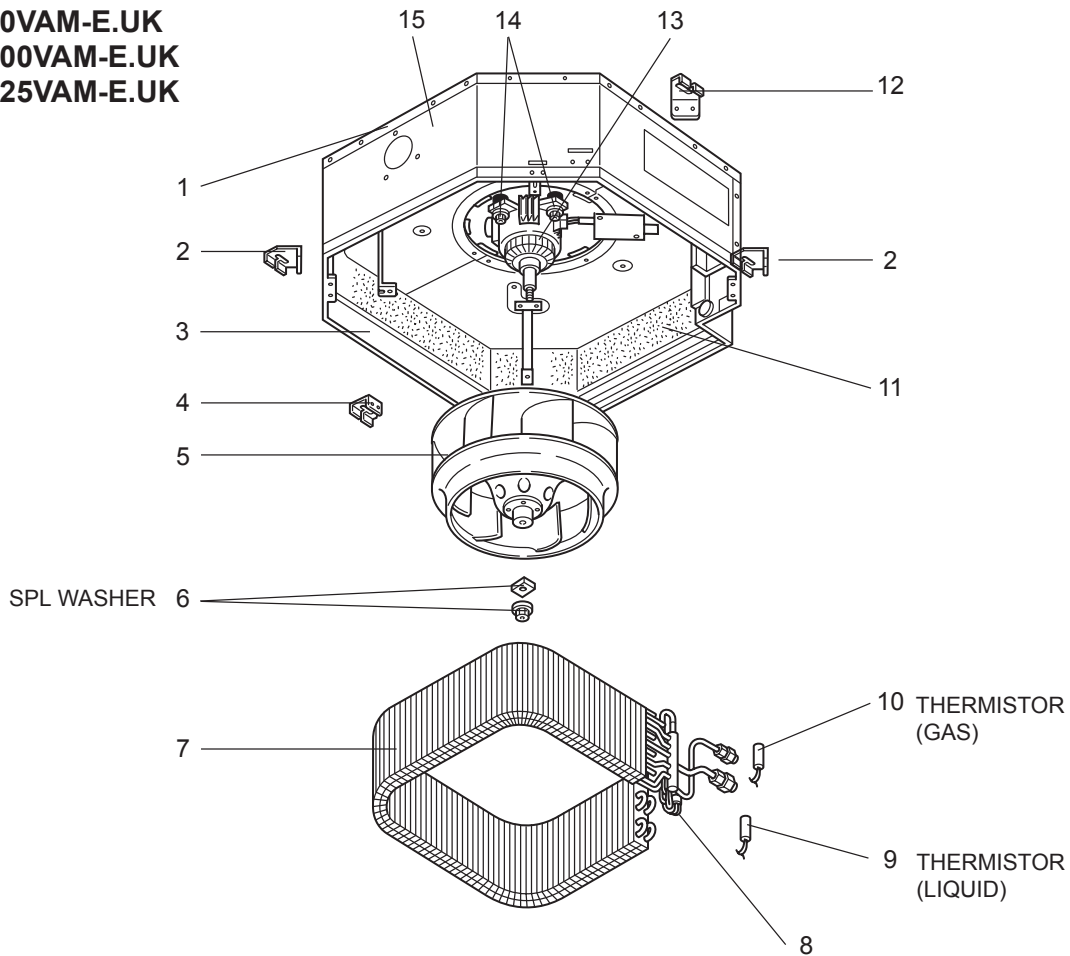

No.	RoHS	Parts No.	Parts Name	Specification	Q'ty / set			Remarks (Drawing No.)	Wiring Diagram Symbol	Recommended Q'ty	Price	
					80	100	125				Unit	Amount
1	G	S70 003 687	BASE DWG		1	1	1					
2	G	S70 E01 130	LEG		2	2	2					
3	G	S70 005 688	DRUM 1 ASSY		1							
	G	S70 007 688	DRUM 1 ASSY			1	1					
4	G	S70 E00 130	LEG		1	1	1					
5	G	S70 E00 114G	TURBO FAN		1							
	G	S70 E01 114G	TURBO FAN			1	1					
6	G	S70 08K 097	SPL WASHER		1	1	1					
7	G	S70 E64 480G	HEAT EXCHANGER		1							
	G	S70 E65 480G	HEAT EXCHANGER			1	1					
8	G	S70 E70 401	LINEAR EXPANSION VALVE		1	1	1		LEV			
9	G	S70 17J 202	THERMISTOR (LIQUID)		1	1	1		TH22			
10	G	S70 79N 202	THERMISTOR (GAS)		1	1	1		TH23			
11	G	S70 E00 659	INNER COVER ASSY		1							
	G	S70 E02 659	INNER COVER ASSY			1	1					
12	G	S70 E02 130	LEG		1	1	1					
13	G	S70 E06 762	FAN MOTOR	D17B6P70MS	1				MF			
	G	S70 E07 762	FAN MOTOR	D176P120MS		1	1		MF			
14	G	S70 A41 105	MOTOR MOUNT		4	4	4					
15	G	S70 006 688	DRUM 2 ASSY		1							
	G	S70 008 688	DRUM 2 ASSY			1	1					

FUNCTIONAL PARTS
PLFY-P32VAM-E.UK
PLFY-P40VAM-E.UK
PLFY-P50VAM-E.UK
PLFY-P63VAM-E.UK

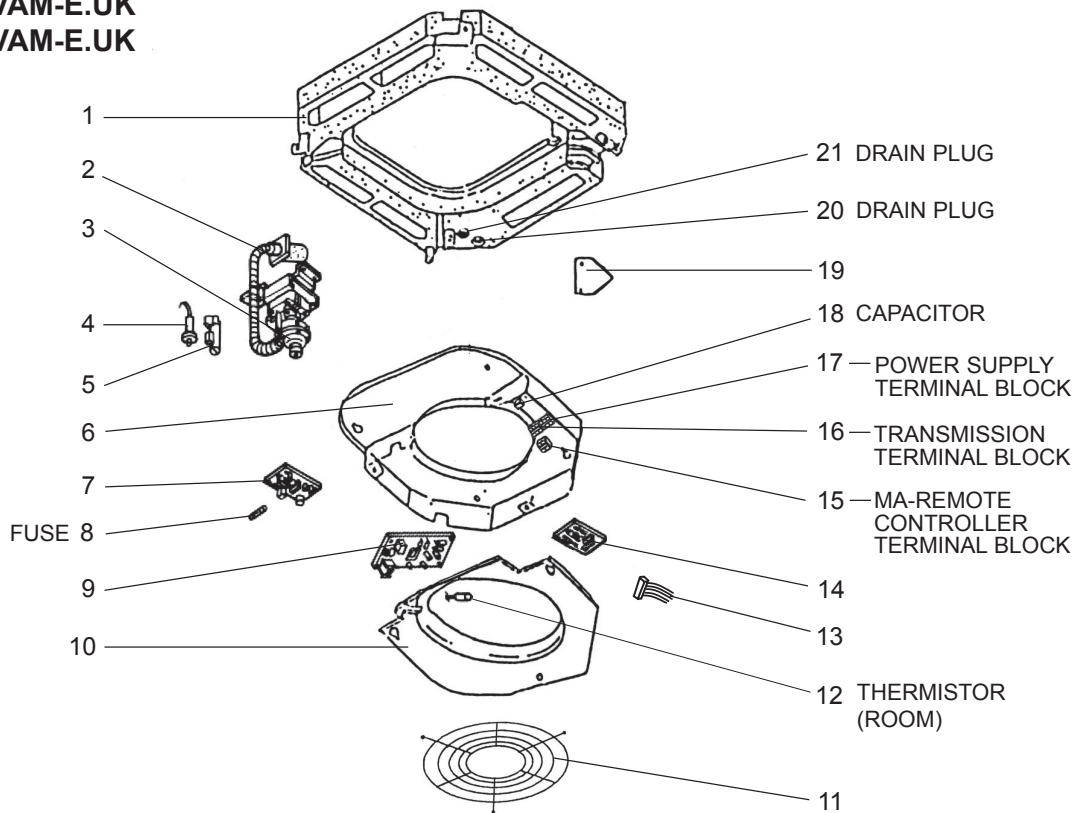

No.	RoHS	Parts No.	Parts Name	Specification	Q'ty / set		Remarks (Drawing No.)	Wiring Diagram Symbol	Recommended Q'ty	Price	
					PLFY-P-VAM-E.UK	32, 40, 50, 63				Unit	Amount
1	G	S70 E02 529	DRAIN PAN			1					
2	G	S70 A41 523	DRAIN SOCKET			1					
3	G	S70 E01 355	DRAIN PUMP			1		DP			
4	G	S70 E00 266	DRAIN SENSOR			1		DS			
5	G	S70 31K 241	DRAIN SENSOR HOLDER			1					
6	G	S70 E00 503	CONTROL BOX			1					
7	G	S70 E02 313	POWER BOARD			1		P.B			
8	G	S70 520 239	FUSE	6.3A 250V		1		FUSE			
9	G	S70 E35 310	INDOOR CONTROLLER BOARD			1		I.B ※			
10	G	S70 003 503	CONTROL COVER ASSY			1					
11	G	S70 E10 675G	FAN GUARD			1					
12	G	S70 E00 202	THERMISTOR (ROOM)			1		TH21			
13	G	S70 E00 304	ADDRESS CABLE			1					
14	G	S70 B02 294	ADDRESS BOARD			1		A.B			
15	G	S70 512 716	MA-REMOTE CONTROLLER TERMINAL BLOCK	2P(1, 2)		1		TB15			
16	G	S70 B02 716	TRANSMISSION TERMINAL BLOCK	3P(M1, M2, S)		1		TB5			
17	G	S70 521 716	POWER SUPPLY TERMINAL BLOCK	3P(L, N, ⊕)		1		TB2			
18	G	S70 576 255	FAN MOTOR CAPACITOR	3.0μF 440V		1		C			
19	G	S70 001 663	CORNER COVER			1					
20	G	S70 A48 524	DRAIN PLUG			1					
21	G	S70 A41 524	DRAIN PLUG			1					

※ The part name of symbol "I.B" is "SPCB".

FUNCTIONAL PARTS
PLFY-P80VAM-E.UK
PLFY-P100VAM-E.UK
PLFY-P125VAM-E.UK

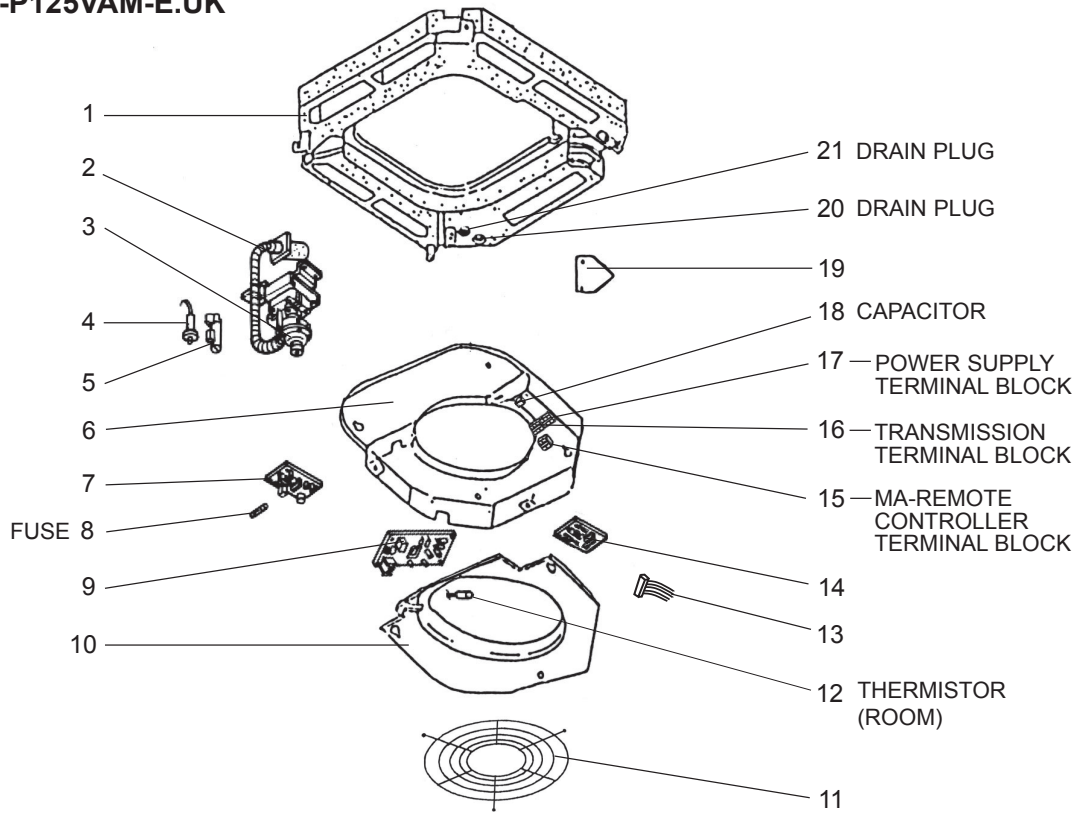

No.	RoHS	Parts No.	Parts Name	Specification	Q'ty / set		Remarks (Drawing No.)	Wiring Diagram Symbol	Recommended Q'ty	Price	
					80	100, 125				Unit	Amount
1	G	S70 E02 529	DRAIN PAN		1						
	G	S70 E01 529	DRAIN PAN			1					
2	G	S70 A41 523	DRAIN SOCKET		1	1					
3	G	S70 E01 355	DRAIN PUMP		1	1		DP			
4	G	S70 E00 266	DRAIN SENSOR		1	1		DS			
5	G	S70 31K 241	DRAIN SENSOR HOLDER		1	1					
6	G	S70 E00 503	CONTROL BOX		1	1					
7	G	S70 E02 313	POWER BOARD		1	1		P.B			
8	G	S70 520 239	FUSE	6.3A 250V	1	1		FUSE			
9	G	S70 E35 310	INDOOR CONTROLLER BOARD		1	1		I.B ※			
10	G	S70 003 503	CONTROL COVER ASSY		1	1					
11	G	S70 E10 675G	FAN GUARD		1	1					
12	G	S70 E00 202	THERMISTOR (ROOM)		1	1		TH21			
13	G	S70 E00 304	ADDRESS CABLE		1	1					
14	G	S70 B02 294	ADDRESS BOARD		1	1		A.B			
15	G	S70 512 716	MA-REMOTE CONTROLLER TERMINAL BLOCK	2P(1, 2)	1	1		TB15			
16	G	S70 B02 716	TRANSMISSION TERMINAL BLOCK	3P(M1, M2, S)	1	1		TB5			
17	G	S70 521 716	POWER SPPLY TERMINAL BLOCK	3P(L, N, ⊕)	1	1		TB2			
18	G	S70 17T 255	FAN MOTOR CAPACITOR	3.5 μ F 440V	1			C			
	G	S70 E02 255	FAN MOTOR CAPACITOR	7.0 μ F 440V		1		C			
19	G	S70 001 663	CORNER COVER		1	1					
20	G	S70 A48 524	DRAIN PLUG		1	1					
21	G	S70 A41 524	DRAIN PLUG		1	1					

※ The part name of symbol "I.B" is "SPCB".

12**OPTIONAL PARTS****12-1. MULTI FUNCTION CASEMENT**

Part No.	PAC-SG03TM-E
----------	--------------

12-2. AIR OUTLET SHUTTER PLATE (20 sets)

Part No.	PAC-SG06SP-E
----------	--------------

12-3. HIGH EFFICIENCY FILTER (PAC-SG03TM-E is required in using this optional part.)

Part No.	PAC-SG01KF
----------	------------





CITY MULTI™

