



# MITSUBISHI ELECTRIC

## Building Air Conditioning Control System

### Group Remote Controller

#### Installation Manual

This installation manual describes only the 4-step basic steps for the Group Remote Controller (PAC-SC30GRA). For information about how to wire and how to install air conditioning units, see the installation manual for them. For your safety, be sure to read the **WARNING** and **CAUTION** sections carefully.

#### 1 Safety Precautions

- The following two symbols are used to denote dangers that may be caused by incorrect use and their degree.
  - WARNING** This symbol denotes what could lead to serious injury or death if you miss the PAC-SC30GRA.
  - CAUTION** This symbol denotes what could lead to property damage or injury to the equipment.
- After reading this installation manual, be sure to read the installation manual for the air conditioning units. When installing the units, refer to the PAC-SC30GRA's manual and that of the units to be installed.

#### WARNING

- **Ensure that installation work is done correctly** following:
  - Ask your dealer or technical representative to install the remote controller.
  - Any deficiency caused by installation may result in an electric shock or fire.
- **Install in a place which is strong enough to withstand** the weight of the remote controller and the wiring. Any lack of strength may cause the PAC-SC30GRA to fall down, resulting in personal injury.
- **Firmly connect the wiring using the specified cables.** The remote controller is designed to be used with the specified cables. If other wiring conditions may produce heat and pose a fire hazard, do not use them.
- **Do not touch the terminals of the PAC-SC30GRA.** Any deficiency caused by touching may result in an electric shock or fire.
- **To dispose of this product, consult your dealer.** Do not throw away your remote controller.

#### CAUTION

- **Do not install in any place exposed to flammable gas leakage.** Doing so may cause an explosion or a fire.
- **Do not install in any place where water or alkaline solution may drip or splash.** Doing so may cause an electric shock or a malfunction.
- **Do not use in any place where the body of the PAC-SC30GRA may be damaged.** Doing so may cause an electric shock or a malfunction.
- **Do not use in any place where the current carrying capacity may be exceeded.** Doing so may cause an electric shock or a malfunction.
- **Do not touch any PCB (Printed Circuit Board) with your fingers.** Doing so may cause an electric shock or a malfunction.
- **Do not touch any PCB with your hands.** Doing so may cause an electric shock or a malfunction.
- **Do not use in any place where the remote controller may be damaged by heat, moisture, or other factors.** Doing so may cause an electric shock or a malfunction.
- **Do not use in any place where the remote controller may be damaged by heat, moisture, or other factors.** Doing so may cause an electric shock or a malfunction.
- **Do not use in any place where the remote controller may be damaged by heat, moisture, or other factors.** Doing so may cause an electric shock or a malfunction.

#### 2 Confirming the Supplied Parts

- Check that the box contains the following parts in addition to the manual:
- 1 Remote controller (with upper and lower case)
  - 2 Cross recessed pan head screws (M4x30)
  - 3 Wood screws (4-1x16, for directly hooking to the wall)
  - 4 Room label
  - 5 Infrared cable (1.2m)
  - 6 Caution label (in 10 languages)
  - 7 Instruction book
- NOTE: The remote controller cord is supplied on site. Use a double cable in accordance with the following specifications. With CAVS, be sure to seal the cable shield so that it does not contact the terminal block.
- Up to 10m: Cable: 0.75mm<sup>2</sup> wire-core cable
  - Longer than 10m: 1.25mm<sup>2</sup> wire-core cable (extension cord)

#### 3 System Configuration

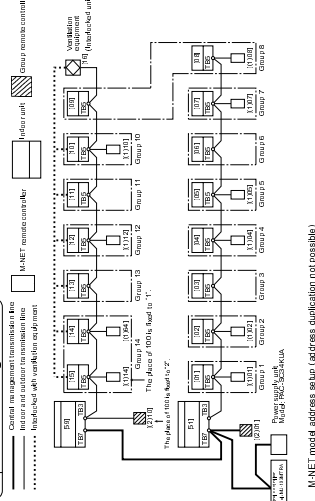

M-NET (master address setup) (address duplication not possible)

Indoor unit / Infrared unit	Address setup	Address
Outdoor unit	Any address within the specified address range	1-50
Remote controller	This master address (enlarged system) + 50	51-100
Group remote controller	Any address within the range specified at right. This smallest group No. to be maintained. *200	101-200
		201-250

NOTE: The only indoor unit this device can be used to operate is an M-NET control indoor unit. It will not operate a K-control indoor unit, even with a K transmission converter (PAC-SC35CA).

Note the following when connecting to central management transmission line (CAUTION):

- 1 Number of system controllers per system which may be supplied with power
- 2 Power supply unit model
- 3 PAC-SC24KUA

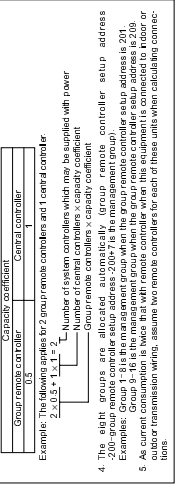

#### 4 How To Install

- 1 Choose a location in which to install the group remote controller (switch box) in accordance with the following:
  - The location should be in a place where it is not exposed to direct sunlight or rain.
  - The location should be in a place where it is not exposed to vibration or noise.
  - The location should be in a place where it is not exposed to heat or cold.
  - The location should be in a place where it is not exposed to moisture or dust.
  - The location should be in a place where it is not exposed to corrosive gases.
  - The location should be in a place where it is not exposed to electromagnetic interference.
- 2 Attach the lower case to the wall or the switch box.

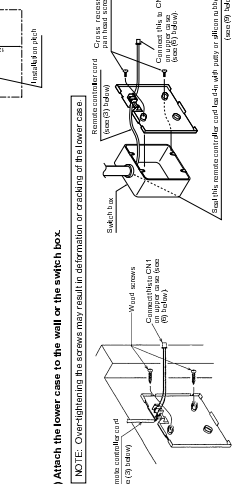

#### When Installing Directly on the Wall

- 1 Connect the remote controller cord to the terminal block on the lower case.

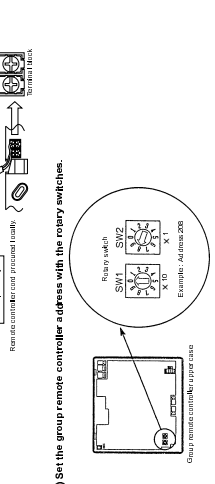

#### When Installing the Switch Box

- 1 Connect the remote controller cord to the terminal block on the lower case.

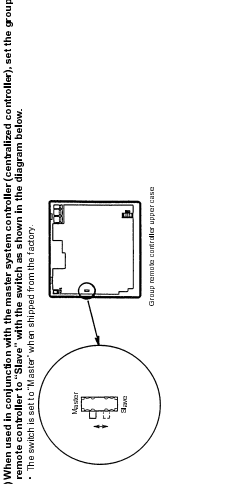

(8) Connect this connector on the power case to the connector CN1 on the upper case.

- Connect firmly as shown below. The system will not operate unless these connections are correct.
- After connecting the wiring, ensure that the upper case does not bang of the cord as shown in the diagram below at the right. This may result in a break in the cord, and thus cause problems with operation.
- Always pass the cord through the hook to hold it in place.

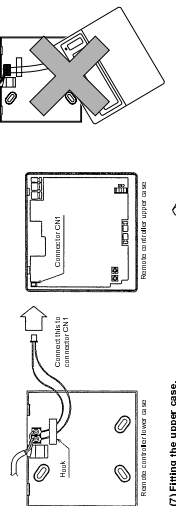

#### (7) Fitting the upper case.

- To remove the upper case, insert a minus screwdriver into one of the open slots and move it in the direction of the arrow as shown in the diagram at right.
- **CAUTION** The remote controller cable is hooked into the open slot. Doing so can result in damage to the cable.

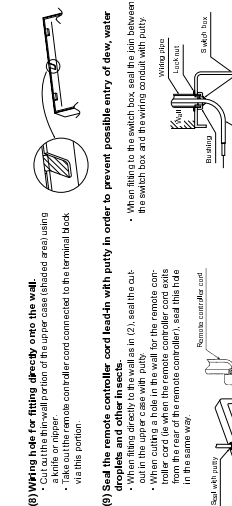

#### (9) Seal the remote controller lead-in with putty in order to prevent possible entry of dew, water droplets and other insects.

- When filling to the switch box, seal the space between the switch box and the wiring conduit with putty.
- When cutting a hole in the wall for the remote controller cord (ie when the remote controller cord exits the wall), seal the hole with putty in the same way.

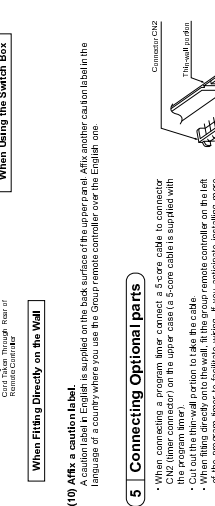

#### (10) Affix a caution label.

- A caution label (English) is supplied on the back surface of the upper panel. Affix another caution label in the language of a country where you use the Group remote controller over the English one.

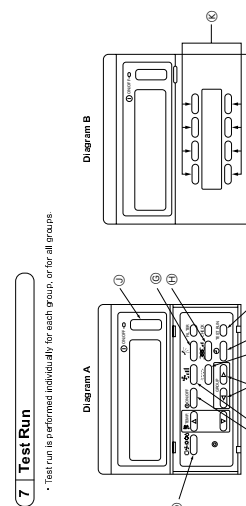

#### Test Run for Each Group

- 1 Open the upper panel.
- 2 Press the **GROUP** switch, which test run is to be executed this time. Example: **Group 5**. Call up Group 5 with the **GROUP** switch.
- 3 Begin test run.

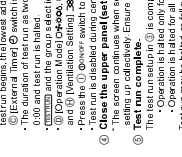

- After the **TEST RUN** switch has been pressed twice in succession the test run display (3 digits) will continuously (The overall status lamp lights up) and group status display flash during test run.
- The smallest address of indoor unit of the smallest number group is displayed on the collective operation setting screen.
- To check the liquid pipe temperature for the indoor units registered in each group, select the indoor unit for which the liquid pipe temperature is to be checked using the **External Time** switch.
- **Close** the upper panel and check the remaining time for the test run.
- The screen continues when setting up individual groups. The collective operation monitor screen appears when setting up collectively. Ensure that the upper panel is fully closed.
- The test run status (3) is completed after two hours and operation is then halted (the test run display is extinguished). Operation is halted only for all groups if a fault occurs. The remaining time (air-conditioning units halted). Test run may be halted as follows:
  - Press the **ON/OFF** switch.
  - Press the **GROUP** switch.
  - Press the **ON/OFF** switch.
- Test run is terminated only for the relevant group when the **ON/OFF** switch is pressed.

#### Test Run for All

- 1 Open the upper panel.
- 2 Call out the collective operation setting screen using the **GROUP** switch.
- 3 Begin test run.



After the **TEST RUN** switch has been pressed twice in succession the test run display (3 digits) will continuously (The overall status lamp lights up) and group status display flash during test run.

- The smallest address of indoor unit of the smallest number group is displayed on the collective operation setting screen.
- To check the liquid pipe temperature for the indoor units registered in each group, select the indoor unit for which the liquid pipe temperature is to be checked using the **External Time** switch.
- **Close** the upper panel and check the remaining time for the test run.
- The screen continues when setting up individual groups. The collective operation monitor screen appears when setting up collectively. Ensure that the upper panel is fully closed.
- The test run status (3) is completed after two hours and operation is then halted (the test run display is extinguished). Operation is halted only for all groups if a fault occurs. The remaining time (air-conditioning units halted). Test run may be halted as follows:
  - Press the **ON/OFF** switch.
  - Press the **GROUP** switch.
  - Press the **ON/OFF** switch.
- Test run is terminated only for the relevant group when the **ON/OFF** switch is pressed.