

December 2012

 No.OCB463
 REVISED EDITION-C

PARTS CATALOG

Series PLFY Ceiling Cassettes

R410A / R407C / R22
Indoor unit
[Model names]
[Service Ref.]

PLFY-P15VCM-E2

**PLFY-P15VCM-E2.TH
 PLFY-P15VCM-E2R1.TH**

PLFY-P20VCM-E2

**PLFY-P20VCM-E2.TH
 PLFY-P20VCM-E2R1.TH
 PLFY-P20VCM-E2R2.TH**

PLFY-P25VCM-E2

**PLFY-P25VCM-E2.TH
 PLFY-P25VCM-E2R1.TH
 PLFY-P25VCM-E2R2.TH**

PLFY-P32VCM-E2

**PLFY-P32VCM-E2.TH
 PLFY-P32VCM-E2R1.TH
 PLFY-P32VCM-E2R2.TH**

PLFY-P40VCM-E2

**PLFY-P40VCM-E2.TH
 PLFY-P40VCM-E2R1.TH
 PLFY-P40VCM-E2R2.TH**
Revision:

- PLFY-P15VCM-E2R1.TH and PLFY-P20/25/32/40VCM-E2R2.TH have been added in REVISED EDITION-C.
- Some descriptions have been modified.

- Please void OCB463 REVISED EDITION-B.

Note :

- RoHS compliant products have <G> mark on spec name plate.

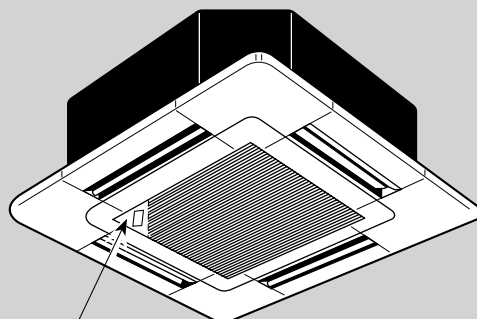
 Model name
 indication

INDOOR UNIT

CONTENTS

1. RoHS PARTS LIST.....2

SERVICE MANUAL (OCH463)

PANEL PARTS
SLP-2ALW
SLP-2AAW

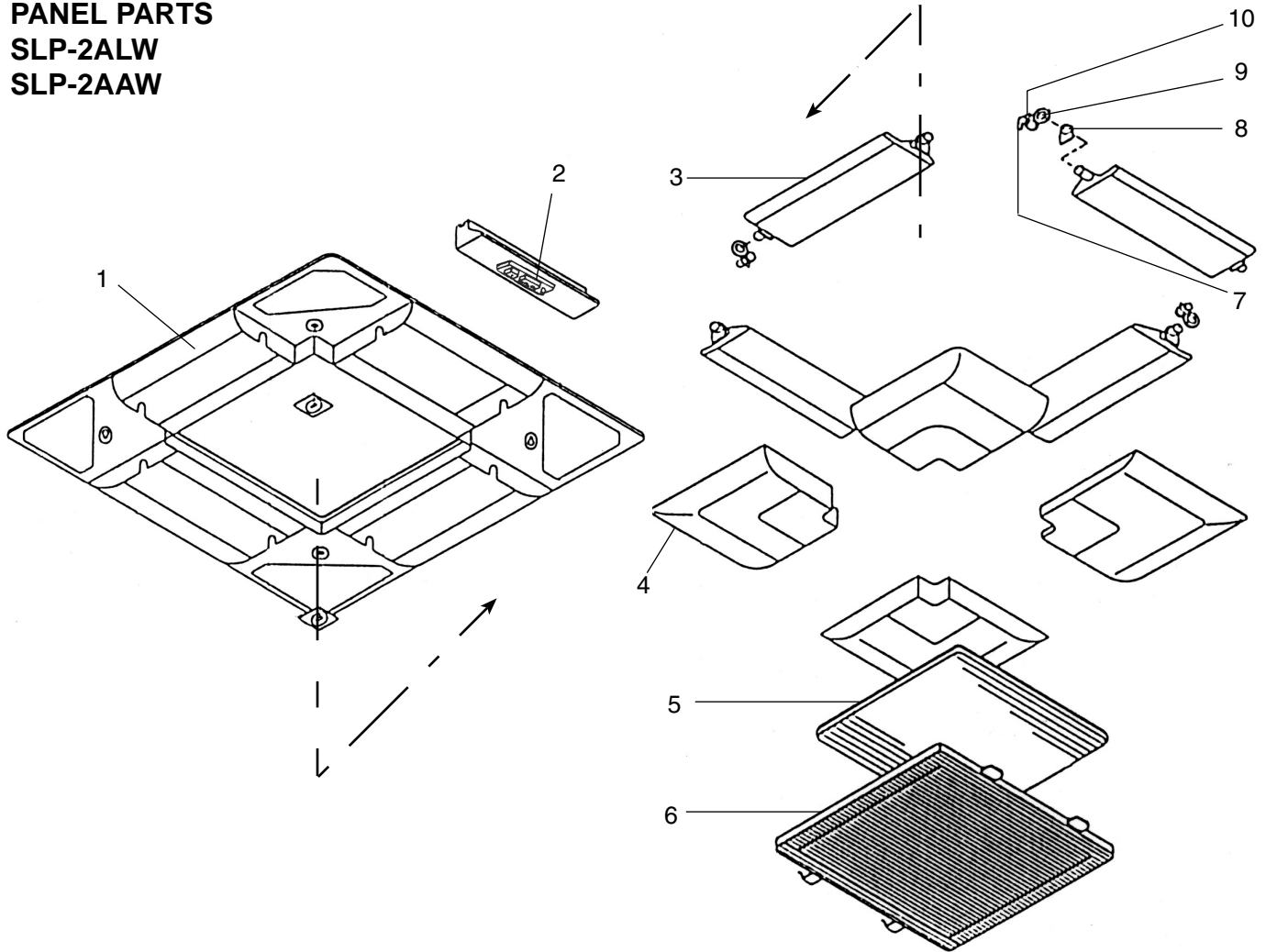

No.	RoHS	Part No.	Part Name	Specification	Q'ty/set		Remarks (Drawing No.)	Wiring Diagram Symbol	Recom- mended Q'ty
					SLP-2				
					ALW	AAW			
1	G	E17 423 003	AIR OUTLET GRILLE		1				
	G	E17 424 003	AIR OUTLET GRILLE			1			
2	G	E17 103 317	WIRELESS REMOTE CONTROL BOARD		1		W.B		
3	G	E17 423 037	AUTO VANE		4	4			
4	G	E17 423 975	CORNER PANEL		4	4			
5	G	E17 103 100	AIR FILTER		1	1			
6	G	E17 423 010	INTAKE GRILLE		1	1			
7	G	E17 103 303	VANE MOTOR		4	4		MV	
8	G	E17 103 044	VANE BUSH		8	8			
9	G	E17 103 031	GEAR (V)		4	4			
10	G	E17 103 032	GEAR (M)		4	4			

RoHS PARTS LIST

ELECTRICAL PARTS

PLFY-P15VCM-E2.TH

PLFY-P20VCM-E2.TH

PLFY-P25VCM-E2.TH

PLFY-P32VCM-E2.TH

PLFY-P40VCM-E2.TH

PLFY-P15VCM-E2R1.TH

PLFY-P20VCM-E2R1.TH

PLFY-P25VCM-E2R1.TH

PLFY-P32VCM-E2R1.TH

PLFY-P40VCM-E2R1.TH

PLFY-P20VCM-E2R2.TH

PLFY-P25VCM-E2R2.TH

PLFY-P32VCM-E2R2.TH

PLFY-P40VCM-E2R2.TH

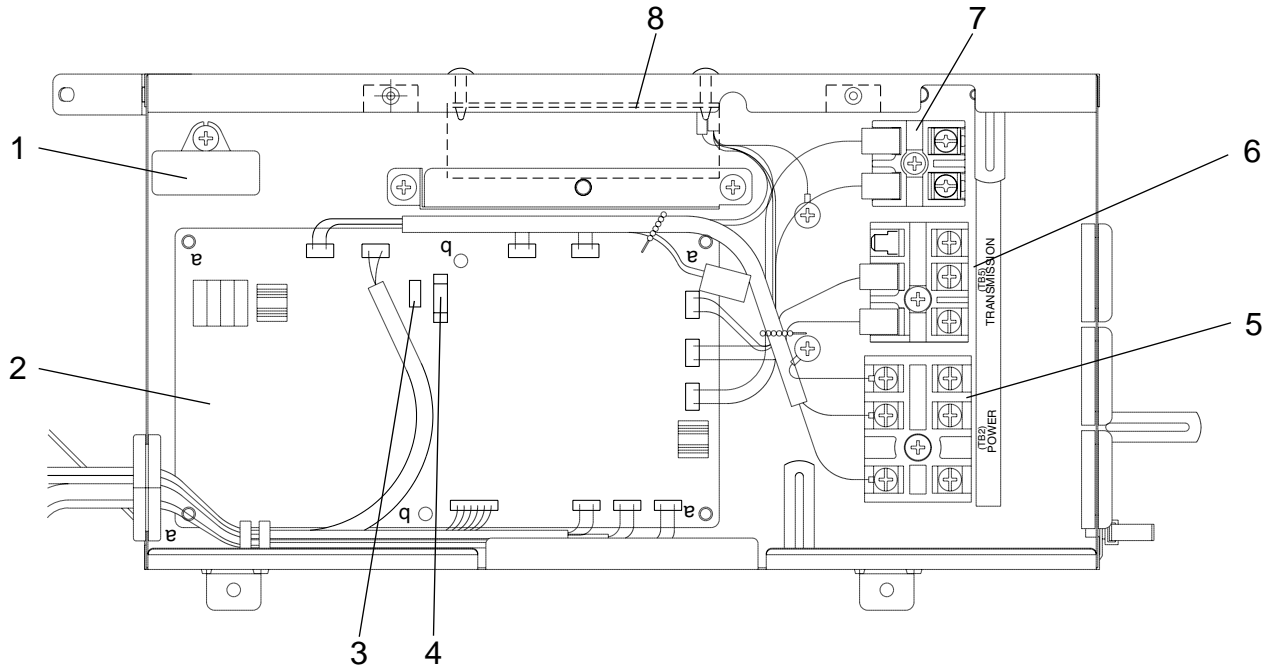

No.	RoHS	Parts No.	Parts name	Specification	Q'ty/unit						Remarks (Drawing No.)	Wiring Diagram Symbol	
					PLFY-P								
					15,20	25,32,40	15	20	25,32,40	20			25,32,40
					VCM-E2.TH		VCM-E2R1.TH		VCM-E2R2.TH				
1	G	E17 154 350	CAPACITOR	1.0 μ F/440VAC	1		1	1		1			C1
	G	E12 095 350	CAPACITOR	1.5 μ F/440VAC		1			1		1		C1
2	G	E17 580 447	INDOOR CONTROLLER BOARD		1	1		1	1				I.B
	G	E17 873 447	INDOOR CONTROLLER BOARD				1			1	1		I.B
3	G	E12 661 385	VARISTOR		1	1	1	1	1	1	1		ZNR
4	G	E17 250 382	FUSE	250V 6.3A	1	1	1	1	1	1	1		FUSE
5	G	E17 155 375	TERMINAL BLOCK	3P(L, N, \oplus)	1	1	1	1	1	1	1		TB2
6	G	E17 154 375	TERMINAL BLOCK	3P(M1, M2, S)	1	1	1	1	1	1	1		TB5
7	G	E17 156 375	TERMINAL BLOCK	2P(1, 2)	1	1	1	1	1	1	1		TB15
8	G	E17 154 440	INDOOR POWER BOARD		1	1		1	1				P.B
	G	E17 852 440	INDOOR POWER BOARD				1			1	1		P.B

RoHS PARTS LIST

FUNCTIONAL PARTS

- PLFY-P15VCM-E2.TH
- PLFY-P15VCM-E2R1.TH
- PLFY-P20VCM-E2.TH
- PLFY-P20VCM-E2R1.TH
- PLFY-P20VCM-E2R2.TH
- PLFY-P25VCM-E2.TH
- PLFY-P25VCM-E2R1.TH
- PLFY-P25VCM-E2R2.TH
- PLFY-P32VCM-E2.TH
- PLFY-P32VCM-E2R1.TH
- PLFY-P32VCM-E2R2.TH
- PLFY-P40VCM-E2.TH
- PLFY-P40VCM-E2R1.TH
- PLFY-P40VCM-E2R2.TH

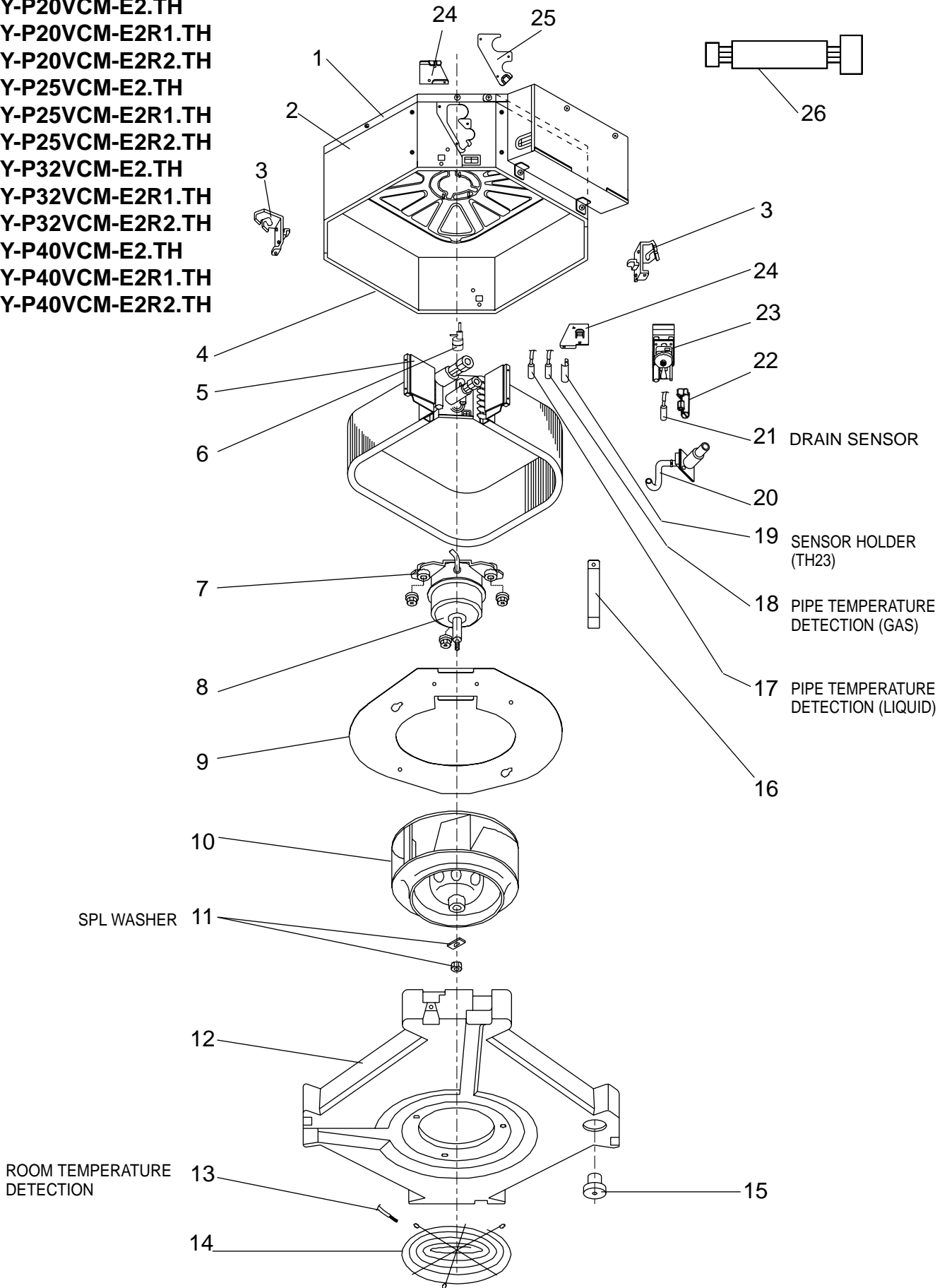

RoHS PARTS LIST

No.	RoHS	Parts No.	Parts name	Specification	Q'ty/unit												Remarks (Drawing No.)	Wiring Diagram Symbol		
					PLFY-P															
					15	20	25	32	40	15	20	25	32	40	20	25			32	40
					VCM-E2.TH				VCM-E2R1.TH				VCM-E2R2.TH							
1	G	E17 104 290	BASE		1	1	1	1	1	1	1	1	1	1	1	1	1			
2	G	E17 104 124	DRUM-1		1	1	1	1	1	1	1	1	1	1	1	1	1			
3	G	E17 104 808	LEG-1		2	2	2	2	2	2	2	2	2	2	2	2	2			
4	G	E17 105 124	DRUM-2		1	1	1	1	1	1	1	1	1	1	1	1	1			
5	G	E17 154 620	INDOOR HEAT EXCHANGER		1	1	1			1	1	1			1	1				
	G	E17 155 620	INDOOR HEAT EXCHANGER					1	1				1	1			1	1		
6	G	E17 154 640	LINEAR EXPANSION VALVE		1	1	1	1	1	1	1	1	1	1	1	1	1		LEV	
7	G	E17 104 105	MOTOR MOUNT		3	3	3	3	3	3	3	3	3	3	3	3	3	3	3pcs/set	
8	G	E17 799 300	INDOOR FAN MOTOR	PK6V8-LA	1					1									MF	
	G	E17 168 300	INDOOR FAN MOTOR	PK6V11-LF		1					1				1				MF	
	G	E17 162 300	INDOOR FAN MOTOR	PK6V15-LD			1					1				1			MF	
	G	E17 164 300	INDOOR FAN MOTOR	PK6V20-LL				1					1				1		MF	
	G	E17 166 300	INDOOR FAN MOTOR	PK6V20-LM					1					1				1	MF	
9	G	E17 104 816	FLAT PLATE		1	1	1	1	1	1	1	1	1	1	1	1	1			
10	G	E17 104 502	TURBO FAN			1	1	1	1											
	G	E17 766 502	TURBO FAN		1					1	1	1	1	1	1	1	1			
11	G	E17 104 097	SPL WASHER			1	1	1	1											
	G	E17 766 097	SPL WASHER		1					1	1	1	1	1	1	1	1			
12	G	E17 104 700	DRAIN PAN		1	1	1	1	1	1	1	1	1	1	1	1	1			
13	G	E17 154 308	ROOM TEMPERATURE DETECTION		1	1	1	1	1	1	1	1	1	1	1	1	1		TH21	
14	G	E17 104 520	FAN GUARD		1	1	1	1	1	1	1	1	1	1	1	1	1			
15	G	E17 104 524	DRAIN PLUG		1	1	1	1	1	1	1	1	1	1	1	1	1			
16	G	E17 104 648	COIL SUPPORT		1	1	1	1	1	1	1	1	1	1	1	1	1			
17	G	E17 154 307	PIPE TEMPERATURE DETECTION/LIQUID		1	1	1	1	1	1	1	1	1	1	1	1	1		TH22	
18	G	E17 154 309	PIPE TEMPERATURE DETECTION/GAS		1	1	1	1	1	1	1	1	1	1	1	1	1		TH23	
19	G	E17 154 241	SENSOR HOLDER/TH23	(TH23)	1	1	1	1	1	1	1	1	1	1	1	1	1			
20	G	E17 104 702	DRAIN HOSE		1	1	1	1	1	1	1	1	1	1	1	1	1			
21	G	E17 104 266	DRAIN SENSOR		1	1	1	1	1	1	1	1	1	1	1	1	1		DS	
22	G	E17 104 241	SENSOR HOLDER	(DS)	1	1	1	1	1	1	1	1	1	1	1	1	1			
23	G	E17 104 355	DRAIN PUMP		1	1	1	1	1	1	1	1	1	1	1	1	1		DP	
24	G	E17 104 809	LEG-2		2	2	2	2	2	2	2	2	2	2	2	2	2			
25	G	E17 154 006	COVER (DRUM)		1	1	1	1	1	1	1	1	1	1	1	1	1			
26	G	E17 580 087	WIRELESS ADAPTER CABLE		1	1	1	1	1	1	1	1	1	1	1	1	1			

CITY MULTI™

MITSUBISHI ELECTRIC CORPORATION

HEAD OFFICE : TOKYO BLDG., 2-7-3, MARUNOUCHI, CHIYODA-KU TOKYO 100-8310, JAPAN