

## Product Information

**EHPT15-17X-UKHLCW**  
FTC5 Pre-plumbed Slimline Cylinders  
for Ecodan Monobloc Units

Making a  
World of  
Difference

ecodan



The pre-plumbed slimline cylinder comes complete with integrated hydraulic components and advanced controls.

Designed to minimise floor space and footprint whilst still offering optimum performance, the cylinder completely integrates with the Ecodan monobloc air source heat pump range. The slimline cylinder provides improved performance and faster heat up times through the use of plate heat exchanger technology. Fast commissioning via an SD card and energy monitoring functions are now included.

### Key Features

- Optional 2-zone energy efficient space heating control
- Pre-plumbed and wired for faster installation
- Hybrid function, for use with conventional boilers
- Energy monitoring as standard

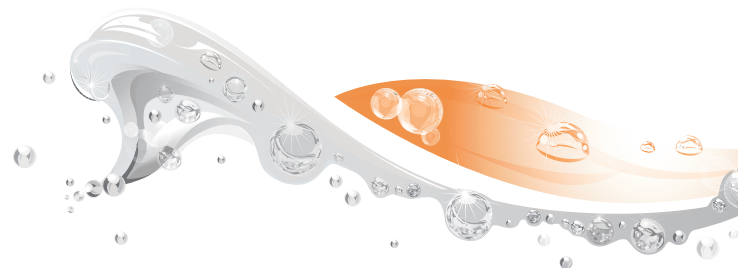

#### ADVANCED CONTROLLER – WITH ENERGY MONITORING



Mitsubishi Electric's fifth generation controller (FTC5) includes intelligent room temperature control as standard. This together with advanced weather compensation ensures the system delivers efficient, comfortable heating regardless of the season. FTC5 now also includes energy monitoring showing consumed and produced energy.

CYLINDER		EHP15X-UKHLCW	EHP17X-UKHLCW		
NOMINAL HOT WATER VOLUME (LITRES)		150	170		
ERP RATING		C	C		
HEAT LOSS (kWh/24hrs)		1.45	1.63		
HEAT LOSS (W)		60	68		
WATER	Flow Rate (l/min) W50 - W85 - W112 - HW140	14.3 - 25.8 - 32.1 - 40.1			
	Primary Pump	Grundfos UPMGEO 25 - 85			
	Secondary Circuit Pump	Grundfos UPM3 25-70			
	Sanitary Hot Water Pump	Grundfos UPSO 15-60 CIL2			
	Connection Size (mm) Heating / DHW (mm)	22	22		
	Primary Expansion Vessel (Litres)	12	18		
WATER SAFETY DEVICES	Water Circuit	Charge Pressure (MPa (Bar))	0.35 (3.5)	0.35 (3.5)	
		Control Thermistor (°C)	1 - 80	1 - 80	
		Pressure Relief Valve (MPa (Bar))	0.3 (3)	0.3 (3)	
	DHW Cylinder	Expansion Relief Valve (Cold)	0.8 (8)	0.8 (8)	
		Control Thermistor	40-70	40-70	
		High Limit Stat (°C)	Mechanical 80 (+/-5)	Mechanical 80 (+/-5)	
Temp and Pressure Relief Valve (°C) / (MPa (Bar))		90 / 1.0 (10)	90 / 1.0 (10)		
DIMENSIONS (mm)	Width	648	648		
	Depth	645	645		
	Height	1515	1689		
	Weight Empty / Full (kg)	54 / 204	60 / 230		
CYLINDER MATERIAL	Cylinder Material	Stainless Steel	Stainless Steel		
	Insulation	CFC / HCFC-free flame-retardant expanded Polyurethane			
	Insulation Type	60	60		
	Insulation Thickness (mm)	3.1	3.1		
	GWP of Insulation	0	0		
ELECTRICAL DATA	Control Board <i>optionally powered by outdoor unit</i>	Electrical Supply	220-240v, 50Hz	220-240v, 50Hz	
		Phase	Single	Single	
		Fuse Rating - MCB Sizes (A) <sup>1</sup>	10	10	
		Electrical Supply	220-240v, 50Hz	220-240v, 50Hz	
		Phase	Single	Single	
	Immersion Heater	Capacity (kW)	3	3	
		Max Running Current (A)	13	13	
		Fuse Rating - MCB Sizes (A) <sup>1</sup>	16	16	
		MECHANICAL ZONES		DHW and 1 Heating Zone <sup>2</sup>	
		OPTIONAL SIMPLIFIED WIRELESS ROOM THERMOSTAT AND WIRELESS RECEIVER		PAR-WT50-E Controller and PAR-WR61-E Receiver	

Cylinder includes: Flow Temperature Controller (FTC5) with Main Controller and Temperature Sensors, Magnetic & Cyclonic Filter, Pumps & Valves for Zone 1 and DHW use, Flow Sensor, Plate Heat Exchanger, Scale Trap, 3kW Immersion Heater and Expansion Vessel.  
<sup>1</sup> MCB Sizes BS EN60898-2 & BS EN60947-2 <sup>2</sup> Optional 2 zone accessory pack available

#### DIMENSIONS

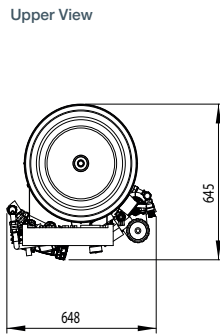
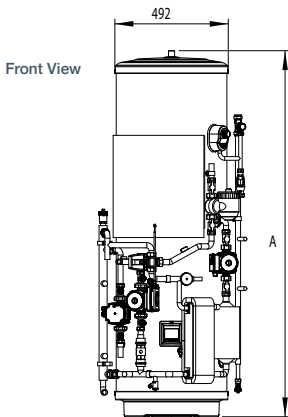

Model	Overall Height (A)
EHP15X-UKHLCW	1515
EHP17X-UKHLCW	1689

\*All dimensions in mm



Telephone: 01707 282880  
 email: heating@meuk.mee.com  
 web: les.mitsubishielectric.co.uk

UNITED KINGDOM Mitsubishi Electric Europe Living Environment Systems Division  
 Travellers Lane, Hatfield, Hertfordshire, AL10 8XB, England General Enquiries Telephone: 01707 282880 Fax: 01707 278881

IRELAND Mitsubishi Electric Europe Westgate Business Park, Ballymount, Dublin 24, Ireland  
 Telephone: Dublin (01) 419 8800 Fax: Dublin (01) 419 8890 International code: (003531)

Country of origin: United Kingdom – Japan – Thailand – Malaysia. ©Mitsubishi Electric Europe 2018. Mitsubishi and Mitsubishi Electric are trademarks of Mitsubishi Electric Europe B.V. The company reserves the right to make any variation in technical specification to the equipment described, or to withdraw or replace products without prior notification or public announcement. Mitsubishi Electric is constantly developing and improving its products. All descriptions, illustrations, drawings and specifications in this publication present only general particulars and shall not form part of any contract. All goods are supplied subject to the Company's General Conditions of Sale, a copy of which is available on request. Third-party product and brand names may be trademarks or registered trademarks of their respective owners.

Note: The fuse rating is for guidance only. Please refer to the relevant databook for detailed specification. It is the responsibility of a qualified electrician/electrical engineer to select the correct cable size and fuse rating based on current regulation and site specific conditions. Mitsubishi Electric's air conditioning equipment and heat pump systems contain a fluorinated greenhouse gas, R410A (GWP:2088), R32 (GWP:675), R407C (GWP:1774) or R134a (GWP:1430). \*These GWP values are based on Regulation (EU) No 517/2014 from IPCC 4th edition. In case of Regulation (EU) No.626/2011 from IPCC 3rd edition, these are as follows: R410A (GWP:1975), R32 (GWP: 550), R407C (GWP:1650) or R134a (GWP:1300).



www.greengateway.mitsubishielectric.co.uk  
 Mitsubishi Electric UK's commitment to the environment

Follow us @meuk\_Jes  
 Follow us @green\_gateway

Mitsubishi Electric  
 Living Environmental Systems UK

mitsubishielectric2

thehub.mitsubishielectric.co.uk

Effective as of June 2018