

SERVICE PARTS LIST FOR MITSUBISHI ELECTRIC PACKAGED AIR-CONDITIONERS

Series : PUHY-RP·YJM-B(-BS)

For use with the R410A

Feb. 2011

BWE10230

INDEX

PUHY-RP200YJM-B
PUHY-RP200YJM-B-BS
PUHY-RP250YJM-B
PUHY-RP250YJM-B-BS
PUHY-RP300YJM-B
PUHY-RP300YJM-B-BS
PUHY-RP350YJM-B
PUHY-RP350YJM-B-BS

Refer to the next page for the package names.

The Package name list

PUHY-RP400YSJM-B(-BS) [PUHY-RP200YJM-B(-BS) + PUHY-RP200YJM-B(-BS)]

PUHY-RP450YSJM-B(-BS) [PUHY-RP200YJM-B(-BS) + PUHY-RP250YJM-B(-BS)]

PUHY-RP500YSJM-B(-BS) [PUHY-RP250YJM-B(-BS) + PUHY-RP250YJM-B(-BS)]

PUHY-RP550YSJM-B(-BS) [PUHY-RP250YJM-B(-BS) + PUHY-RP300YJM-B(-BS)]

PUHY-RP600YSJM-B(-BS) [PUHY-RP300YJM-B(-BS) + PUHY-RP300YJM-B(-BS)]

PUHY-RP650YSJM-B(-BS) [PUHY-RP300YJM-B(-BS) + PUHY-RP350YJM-B(-BS)]

PUHY-RP700YSJM-B(-BS) [PUHY-RP200YJM-B(-BS) + PUHY-RP250YJM-B(-BS) + PUHY-RP250YJM-B(-BS)]

PUHY-RP750YSJM-B(-BS) [PUHY-RP250YJM-B(-BS) + PUHY-RP250YJM-B(-BS) + PUHY-RP250YJM-B(-BS)]

PUHY-RP800YSJM-B(-BS) [PUHY-RP250YJM-B(-BS) + PUHY-RP250YJM-B(-BS) + PUHY-RP300YJM-B(-BS)]

PUHY-RP850YSJM-B(-BS) [PUHY-RP250YJM-B(-BS) + PUHY-RP300YJM-B(-BS) + PUHY-RP300YJM-B(-BS)]

PUHY-RP900YSJM-B(-BS) [PUHY-RP300YJM-B(-BS) + PUHY-RP300YJM-B(-BS) + PUHY-RP300YJM-B(-BS)]

PUHY-RP200,RP250YJM-B(-BS)
PUHY-RP300,RP350YJM-B(-BS)

EXTERNAL PARTS & BLOWER PARTS

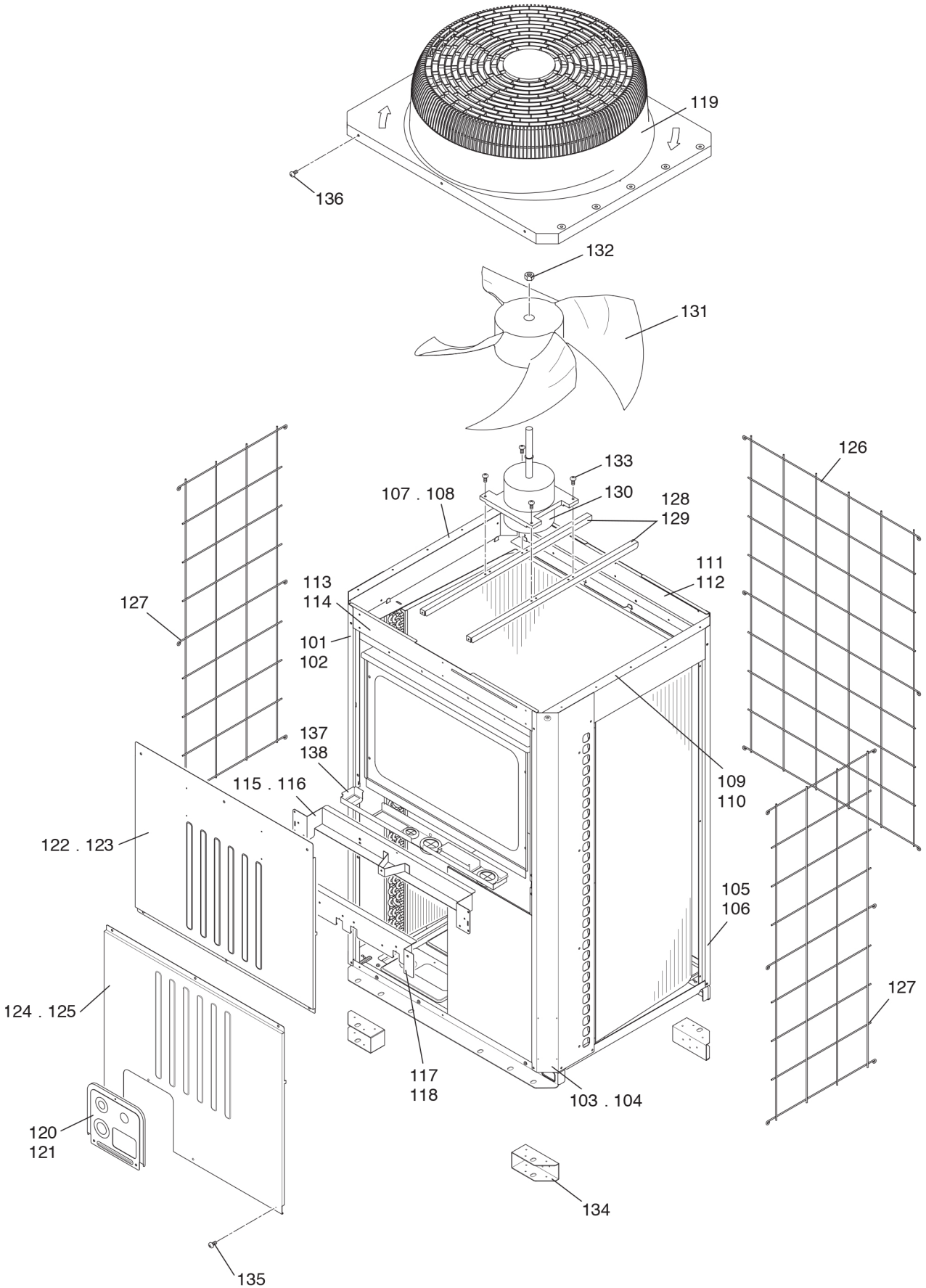

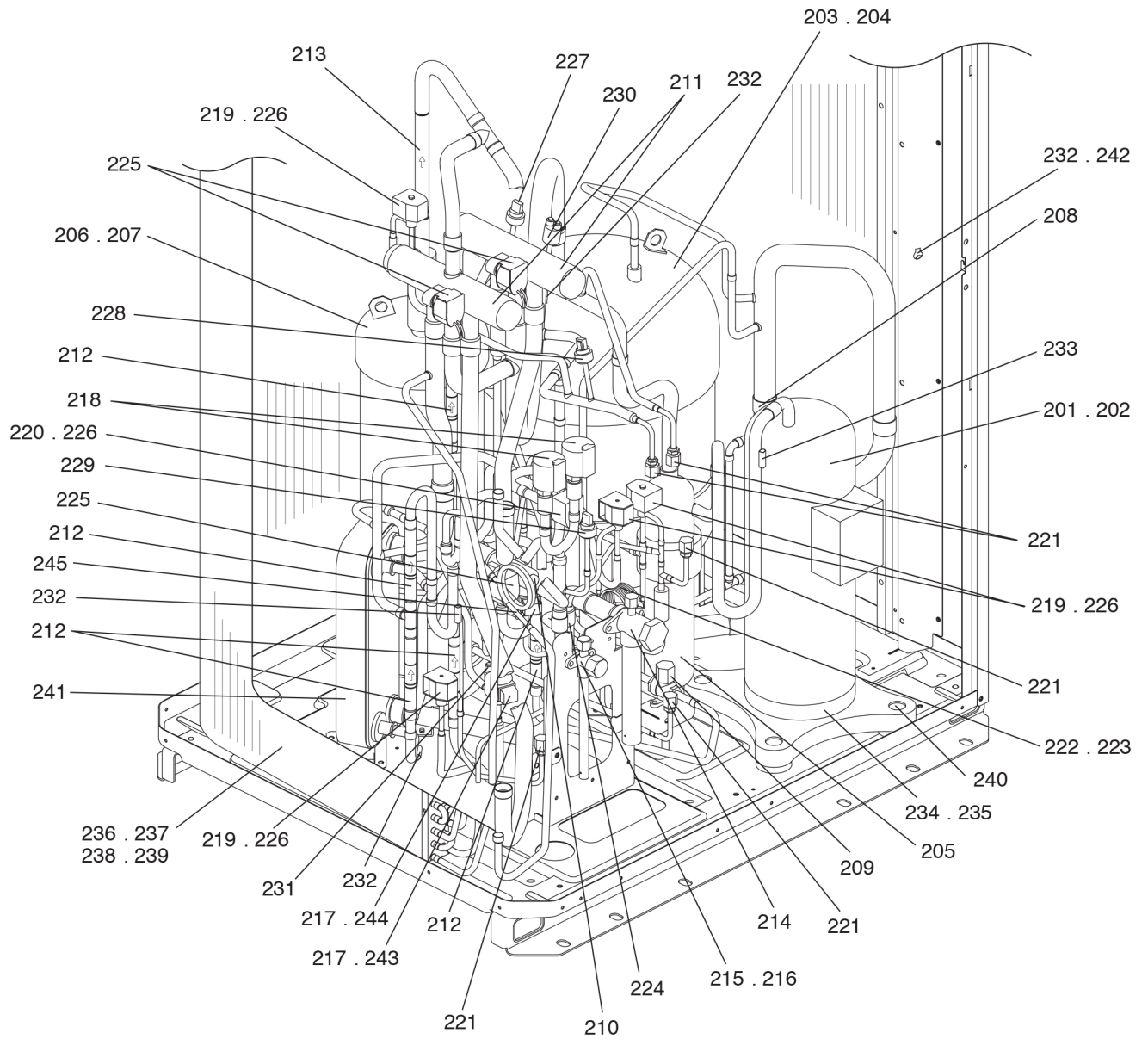

No.	Part No.	G : RoHS Apply Only W : RoHS Apply by Running Change	Part Name	Spec.	PUHY-RP200YJMB	PUHY-RP200YJM-B-BS	PUHY-RP250YJMB	PUHY-RP250YJM-B-BS	PUHY-RP300YJMB	PUHY-RP300YJM-B-BS	Dwg. No.	Notes for the models	Revision info.
201	R69 068 478	G	Scroll compressor	ENB52FC-YE	1	1					EP10107B08		
202	R69 070 478	G	Scroll compressor	HNB78FC-YE			1	1	1	1	EP10109B08		
203	R61 063 484	G	Accumulator assy		1		1		1		KB54J606G05		
204	R61 064 484	G	Accumulator assy	BS		1		1		1	KB54J606G06		
205	R61 018 487	G	Oil separator assy		1	1	1	1	1	1	KB00T550G01		
206	R61 009 530	G	Oil tank		1		1		1		KB54J663G01	(RECOVERY)	
207	R61 010 530	G	Oil tank	BS		1		1		1	KB54J663G02	(RECOVERY)	
208	R63 4H6 534	G	Pipe assy		1	1	1	1	1	1	KB00C787G01	(SUCTION)	
209	R61 001 420	G	Three way valve	SBV-A3YGME-2	1	1	1	1	1	1	P633125X01	<BV3>	
210	R61 004 235	G	Two way valve	MHV-1104	1	1	1	1	1	1	P637048X01	<SV5b>	
211	R63 Y05 154	G	Four way valve	STF-07	2	2	2	2	2	2	P633119X01	<21S4a,21S4b>	
212	R63 984 904	G	Check valve	BCV-804DY	5	5	5	5	5	5	P639163X01	<CV2,CV3,CV4,CV5,CV6>	
213	R63 R43 418	G	Check valve	BCV-1005DYQ82	1	1	1	1	1	1	P639165X01	<CV1>	
214	R61 002 540	G	Valve	VSAMH8SSCM-A	1	1	1	1	1	1	P636343X01	<BV1>	
215	R61 003 540	G	Valve	VSAMH3SSCM-LA1	1	1	1	1	1	1	P636346X01	<BV2>	
216	R61 004 540	G	Valve	VSAMH4SSCM-LA1							P636345X01	<BV2>	
217	R63 4H6 401	G	Linear expansion valve	CAM35-S	2	2	2	2	2	2	P632444X01	<LEV1,SLEV>	
218	R61 015 401	G	Linear expansion valve	EFM-A 1700XA	2	2	2	2	2	2	P632461X01	<LEV2a,LEV2b>	
219	R63 P90 232	G	Solenoid valve	VPV-152D	4	4	4	4	4	4	P631277X01	<SV1a,SV1b,SV8,SV9>	
220	R63 851 921	G	Solenoid valve	ATS-A	1	1	1	1	1	1	P631822X01	<SV3>	
221	R61 003 413	G	Check joint L	R410A	5	5	5	5	5	5	P666001X01	<CJ1,CJ2,CJ3,CJ4,CJ5>	
222	R61 015 425	G	Capillary tube assy		1	1					KB49P478G01	<CP1>	
223	R61 016 425	G	Capillary tube assy				1	1	1	1	KB49P479G01	<CP1>	
224	R61 008 454	G	Strainer	25.4D	1	1	1	1	1	1	KB48K250G01	<ST1>	
225	R63 Y16 243	G	Solenoid coil	STF DV	3	3	3	3	3	3	P472024X01	<21S4a,21S4b,SV5b>	
226	R61 006 243	G	Solenoid coil	VPV Y	5	5	5	5	5	5	P472046X01	<SV1a,SV1b,SV3,SV8,SV9>	
227	R61 006 288	G	Pressure sensor	HP D173	1	1	1	1	1	1	KB00H904G09	<63HS1>	
228	R61 007 288	G	Pressure sensor	LP D173	1	1	1	1	1	1	KB00H904G10	<63LS>	
229	R63 008 288	G	Pressure sensor	HP D184	1	1	1	1	1	1	KB00F899G06	<63HS2>	
230	R63 Y11 208	G	Pressure switch	ACB1UB28W	1	1	1	1	1	1	P426320X01	<63H1>	
231	R63 L01 208	G	Pressure switch	3.3OFF	1	1	1	1	1	1	P426296X01	<63H2>	
232	R61 060 200	G	Thermistor		4	4	4	4	4	4	P418065X01	<TH3,TH5,TH6,TH7>	
233	R63 911 202	G	Thermistor		1	1	1	1	1	1	P425416X02	<TH4>	
234	R63 Y07 237	G	Belt heater	240V 45W			1	1	1	1	P493781X02	<CH11>	
235	R61 003 237	G	Belt heater	240V 35W	1	1					P497067X01	<CH11>	
236	R61 438 480	G	Heat exchanger	2L	1						KD01C880G01		
237	R61 440 480	G	Heat exchanger	2L BS		1					KD01C880G02		
238	R61 441 480	G	Heat exchanger	3L			1		1		KD01C881G01		
239	R61 442 480	G	Heat exchanger	3L BS				1		1	KD01C881G02		
240	R63 852 860	G	Rubber mount	For compressor	4	4	4	4	4	4	W897574H01		
241	R61 437 480	G	Plate heat exchanger assy		1	1	1	1	1	1	KB00P991G03		
242	R61 001 310	G	Sensor holder		1	1	1	1	1	1	KB25B471G02		
243	R63 4H6 402	G	Linear expansion valve coil	CAM	1	1	1	1	1	1	P472057X02	<LEV1>	
244	R63 4H7 402	G	Linear expansion valve coil	CAM	1	1	1	1	1	1	P472058X02	<SLEV>	
245	R61 017 425	G	Capillary tube assy		1	1					KB49U153G01	<CP2>	

No.	Part No.	G : RoHS Apply Only W : RoHS Apply by Running Change		Spec.	PUHY-RP300YJM-B	PUHY-RP350YJM-B-BS					Dwg. No.	Notes for the models	Revision info.
			Part Name										
201	R69 068 478	G	Scroll compressor	ENB52FC-YE							EP10107B08		
202	R69 070 478	G	Scroll compressor	HNB78FC-YE	1	1					EP10109B08		
203	R61 063 484	G	Accumulator assy		1						KB54J606G05		
204	R61 064 484	G	Accumulator assy	BS		1					KB54J606G06		
205	R61 018 487	G	Oil separator assy		1	1					KB00T550G01		
206	R61 009 530	G	Oil tank		1						KB54J663G01	(RECOVERY)	
207	R61 010 530	G	Oil tank	BS		1					KB54J663G02	(RECOVERY)	
208	R63 4H6 534	G	Pipe assy		1	1					KB00C787G01	(SUCTION)	
209	R61 001 420	G	Three way valve	SBV-A3YGME-2	1	1					P633125X01	<BV3>	
210	R61 004 235	G	Two way valve	MHV-1104	1	1					P637048X01	<SV5b>	
211	R63 Y05 154	G	Four way valve	STF-07	2	2					P633119X01	<21S4a,21S4b>	
212	R63 984 904	G	Check valve	BCV-804DY	5	5					P639163X01	<CV2,CV3,CV4,CV5,CV6>	
213	R63 R43 418	G	Check valve	BCV-1005DYQ82	1	1					P639165X01	<CV1>	
214	R61 002 540	G	Valve	VSAMH8SSCM-A	1	1					P636343X01	<BV1>	
215	R61 003 540	G	Valve	VSAMH3SSCM-LA1							P636346X01	<BV2>	
216	R61 004 540	G	Valve	VSAMH4SSCM-LA1	1	1					P636345X01	<BV2>	
217	R63 4H6 401	G	Linear expansion valve	CAM35-S	2	2					P632444X01	<LEV1,SLEV>	
218	R61 015 401	G	Linear expansion valve	EFM-A 1700XA	2	2					P632461X01	<LEV2a,LEV2b>	
219	R63 P90 232	G	Solenoid valve	VPV-152D	4	4					P631277X01	<SV1a,SV1b,SV8,SV9>	
220	R63 851 921	G	Solenoid valve	ATS-A	1	1					P631822X01	<SV3>	
221	R61 003 413	G	Check joint L	R410A	5	5					P666001X01	<CJ1,CJ2,CJ3,CJ4,CJ5>	
222	R61 015 425	G	Capillary tube assy								KB49P478G01	<CP1>	
223	R61 016 425	G	Capillary tube assy		1	1					KB49P479G01	<CP1>	
224	R61 008 454	G	Strainer	25.4D	1	1					KB48K250G01	<ST1>	
225	R63 Y16 243	G	Solenoid coil	STF DV	3	3					P472024X01	<21S4a,21S4b,SV5b>	
226	R61 006 243	G	Solenoid coil	VPV Y	5	5					P472046X01	<SV1a,SV1b,SV3,SV8,SV9>	
227	R61 006 288	G	Pressure sensor	HP D173	1	1					KB00H904G09	<63HS1>	
228	R61 007 288	G	Pressure sensor	LP D173	1	1					KB00H904G10	<63LS>	
229	R63 008 288	G	Pressure sensor	HP D184	1	1					KB00F899G06	<63HS2>	
230	R63 Y11 208	G	Pressure switch	ACB1UB28W	1	1					P426320X01	<63H1>	
231	R63 L01 208	G	Pressure switch	3.3OFF	1	1					P426296X01	<63H2>	
232	R61 060 200	G	Thermistor		4	4					P418065X01	<TH3,TH5,TH6,TH7>	
233	R63 911 202	G	Thermistor		1	1					P425416X02	<TH4>	
234	R63 Y07 237	G	Belt heater	240V 45W	1	1					P493781X02	<CH11>	
235	R61 003 237	G	Belt heater	240V 35W							P497067X01	<CH11>	
236	R61 438 480	G	Heat exchanger	2L							KD01C880G01		
237	R61 440 480	G	Heat exchanger	2L BS							KD01C880G02		
238	R61 441 480	G	Heat exchanger	3L	1						KD01C881G01		
239	R61 442 480	G	Heat exchanger	3L BS		1					KD01C881G02		
240	R63 852 860	G	Rubber mount	For compressor	4	4					W897574H01		
241	R61 437 480	G	Plate heat exchanger assy		1	1					KB00P991G03		
242	R61 001 310	G	Sensor holder		1	1					KB25B471G02		
243	R63 4H6 402	G	Linear expansion valve coil	CAM	1	1					P472057X02	<LEV1>	
244	R63 4H7 402	G	Linear expansion valve coil	CAM	1	1					P472058X02	<SLEV>	
245	R61 017 425	G	Capillary tube assy								KB49U153G01	<CP2>	

