

Product Information

KS8-CMB-P1016V-HB1
Slave BC Controller with
Port Isolation Valves

Making a
World of
Difference

CITY MULTI



At the heart of both the R2 and WR2 Series, the BC controller makes simultaneous heating and cooling possible. It has the 'intelligence' to be the system's decision-maker. The BC controller is available with factory-fitted valves on each port enabling isolation of fan coils. This allows the VRF system to still operate whilst installation or maintenance is carried out in individual rooms.

Key Features

- Transferring energy around the system
- Drawing on energy from the heat source units/outdoor units
- Directing energy as requested by the individual indoor units
- Instructs the heat source unit/outdoor unit on the amount of refrigerant (liquid or gas) that is required to achieve the requested cooling or heating requirements
- Allows unique 2-pipe heat recovery application
- HIC Circuit for improved efficiency
- Brazed connections
- Isolation valves factory-fitted on each port



Air Conditioning | Heating
Ventilation | Controls

Air Conditioning

Product Information

KS8-CMB-P1016V-HB1 Slave BC Controller with Port Isolation Valves

Making a
World of
Difference

SLAVE BC CONTROLLER	KS8-CMB-P1016V-HB1
NUMBER OF CONNECTIONS	16
WEIGHT (kg)	55 + 14.5
DIMENSIONS (mm)	
Width	1098
Depth	432 + 280
Height	284
ELECTRICAL SUPPLY	220-240v, 50Hz
PHASE	Single
POWER INPUT (kW)	0.301
RUNNING CURRENT (A)	1.26
FUSE RATING (BS88) – HRC (A)	6
MAINS CABLE NO. CORES	3
BC BOX	CMB-P1016V-HB1

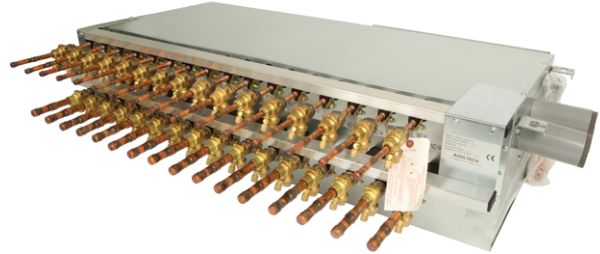

DIMENSIONS

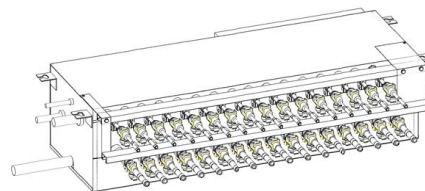
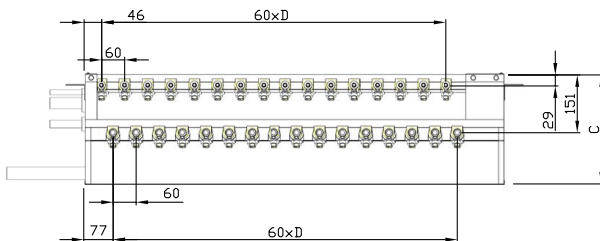
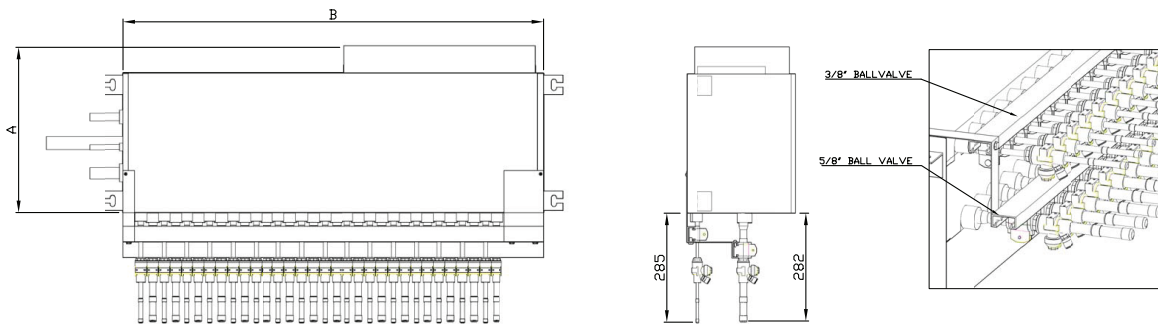

CODE	DESCRIPTION	MODEL	DIMENSIONS				WEIGHT
			A	B	C	D	
10100571	4 WAY BC BOX MOD	CMBP104VG1	432	648	284	4	4.2
10100571	5 WAY BC BOX MOD	CMBP105VG1	432	648	284	5	5
10100572	6 WAY BC BOX MOD	CMBP106VG1	432	648	284	6	5.8
10100573	8 WAY SLAVE BOX MOD	CMBP108VGB1	432	648	284	8	7.5
10100574	8 WAY MASTER BOX MOD	CMBP108VGA1	520	1110	289	8	7.9
10100575	10 WAY MASTER BOX MOD	CMBP1010VGA1	520	1110	289	13	9.5
10100576	13 WAY MASTER BOX MOD	CMBP1013VGA1	520	1110	289	13	12
10100577	16 WAY MASTER BOX MOD	CMBP1016VGA1	520	1110	289	13	14.5
10100578	16 WAY SLAVE BOX MOD	CMBP1016VHB1	432	1098	284	13	14.5



Telephone: 01707 282880

email: air.conditioning@meuk.mee.com web: www.airconditioning.mitsubishielectric.co.uk

UNITED KINGDOM Mitsubishi Electric Europe Living Environmental Systems Division
Travellers Lane, Hatfield, Hertfordshire, AL10 8XB, England General Enquiries Telephone: 01707 282880 Fax: 01707 278881

IRELAND Mitsubishi Electric Europe Westgate Business Park, Ballymount, Dublin 24, Ireland
Telephone: Dublin (01) 419 8800 Fax: Dublin (01) 419 8890 International code: (003531)

Country of origin: United Kingdom – Japan – Thailand – Malaysia. ©Mitsubishi Electric Europe 2015. Mitsubishi and Mitsubishi Electric are trademarks of Mitsubishi Electric Europe B.V. The company reserves the right to make any variation in technical specification to the equipment described, or to withdraw or replace products without prior notification or public announcement. Mitsubishi Electric is constantly developing and improving its products. All descriptions, illustrations, drawings and specifications in this publication present only general particulars and shall not form part of any contract. All goods are supplied subject to the Company's General Conditions of Sale, a copy of which is available on request. Third-party product and brand names may be trademarks or registered trademarks of their respective owners.



Note: The fuse rating is for guidance only. Please refer to the relevant databook for detailed specification. It is the responsibility of a qualified electrician/electrical engineer to select the correct cable size and fuse rating based on current regulation and site specific conditions. Mitsubishi Electric's air conditioning and heat pump systems contain fluorinated greenhouse gases R410A, R407C and R134a.



www.greengateway.mitsubishielectric.co.uk

Mitsubishi Electric UK's commitment
to the environment



Follow us @meuk_Jes
Follow us @green_gateway



Mitsubishi Electric
Living Environmental Systems UK



mitsubishielectric2

Effective as of April 2015