

Air Conditioning

Product Information

MSY-TP R32
High SHF Wall Mounted System
Inverter Heat Pump (Cooling Only)

Making a
World of
Difference

M series



The M Series **MSY-TP R32** High SHF wall mounted system blends energy efficiency with a modern white design. This cooling only unit has a high sensible cooling capacity, making it ideal for small computer rooms or areas that require a greater degree of sensible cooling. The MSY-TP also utilises low GWP R32 refrigerant.

Key Features

- Compact and stylish white design
- High sensible cooling ability
- Highly energy efficient, utilising low GWP R32 refrigerant
- Weekly timer provides greater control of scheduling
- Cooling down to -25°C outdoor air temperature



Cooling | Heating | Ventilation | Controls

R32

Air Conditioning

Product Information

MSY-TP R32
High SHF Wall Mounted System
Inverter Heat Pump (Cooling Only)

Making a
World of
Difference



| MSY-TP - INDOOR UNITS | | MSY-TP35VF | MSY-TP50VF |
|---------------------------------|-----------------------------------|-----------------------------------|-----------------------------------|
| CAPACITY (kW) | Cooling (nominal) Cooling (UK) | 3.5 (1.5-4.0) 3.47 (1.48-3.96) | 5.0 (1.5-5.7) 4.96 (1.48-5.65) |
| SHF (nominal) | | 0.98 | 0.82 |
| EER (nominal) | | 4.61 | 3.45 |
| SEER (BS EN14825) | | 9.00 | 8.00 |
| EP ENERGY EFFICIENCY CLASS | Cooling | A+++ | A++ |
| AIRFLOW (l/s) | Cooling - Lo-Mi-Hi-SHi | 168-193-228-273 | 168-193-228-273 |
| PIPE SIZE mm (in) | Gas | 9.52 (3/8") | 9.52 (3/8") |
| | Liquid | 6.35 (1/4") | 6.35 (1/4") |
| SOUND PRESSURE LEVEL (dBA) | Cooling - Lo-Mi-Hi-SHi | 31-36-40-45 | 31-36-40-45 |
| SOUND POWER LEVEL (dBA) | | 60 | 60 |
| DIMENSIONS (mm) | Width x Depth x Height | 923 x 250 x 305 | 923 x 250 x 305 |
| WEIGHT (kg) | | 12.5 | 12.5 |
| ELECTRICAL SUPPLY | | 220-240v, 50Hz | 220-240v, 50Hz |
| FUSE RATING (BS88) - HRC (A) | | 10 | 10 |
| INTERCONNECTING CABLE No. CORES | | 4 | 4 |

| MUY-TP - OUTDOOR UNITS | | MUY-TP35VF | MUY-TP50VF |
|--|------------------------|--------------------|--------------------|
| SOUND PRESSURE LEVEL (dBA) | Cooling | 45 | 47 |
| SOUND POWER LEVEL (dBA) | Cooling | 58 | 61 |
| WEIGHT (kg) | | 34 | 34 |
| DIMENSIONS (mm) | Width x Depth x Height | 800 x 285 x 550 | 800 x 285 x 550 |
| ELECTRICAL SUPPLY | | Fed by Indoor Unit | Fed by Indoor Unit |
| PHASE | | Single | Single |
| SYSTEM POWER INPUT (kW) | Cooling (nominal) | 0.76 | 1.45 |
| | Cooling (UK) | 0.64 | 1.12 |
| STARTING CURRENT (A) | | 3.6 | 6.4 |
| SYSTEM RUNNING CURRENT (A) | Cooling [MAX] | 3.6 [9.2] | 6.4 [9.2] |
| FUSE RATING (BS88) - HRC (A) | | 10 | 10 |
| MAINS CABLE No. CORES | | 3 | 3 |
| MAX PIPE LENGTH (m) | | 20 | 20 |
| MAX HEIGHT DIFFERENCE (m) | | 12 | 12 |
| CHARGE REFRIGERANT (kg) / CO ₂ EQUIVALENT (t) | | 0.85 / 0.57 | 0.85 / 0.57 |
| MAX ADDITIONAL REFRIGERANT (kg) / CO ₂ EQUIVALENT (t) | | 0.13 / 0.09 | 0.13 / 0.09 |

Notes: The SHF figures are based on nominal conditions. Requires an additional MAC-334IF-E interface and PAR-40MAA wired remote controller

PRODUCT DIMENSIONS

MSY-TP35/50VF

Front View

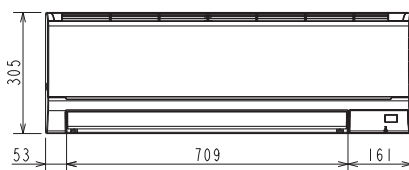

Upper View

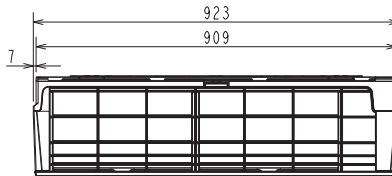

Side View

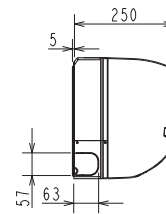

Telephone: 01707 282880
email: air.conditioning@meuk.com
web: airconditioning.mitsubishielectric.co.uk

UNITED KINGDOM Mitsubishi Electric Europe Living Environment Systems Division
Travellers Lane, Hatfield, Hertfordshire, AL10 8XB, England General Enquiries Telephone: 01707 282880 Fax: 01707 278881

IRELAND Mitsubishi Electric Europe Westgate Business Park, Ballymount, Dublin 24, Ireland
Telephone: Dublin (01) 419 8800 Fax: Dublin (01) 419 8890 International code: (003531)

Country of origin: United Kingdom - Japan - Thailand - Malaysia. ©Mitsubishi Electric Europe 2018. Mitsubishi and Mitsubishi Electric are trademarks of Mitsubishi Electric Europe B.V. The company reserves the right to make any variation in technical specification to the equipment described, or to withdraw or replace products without prior notification or public announcement. Mitsubishi Electric is constantly developing and improving its products. All descriptions, illustrations, drawings and specifications in this publication present only general particulars and shall not form part of any contract. All goods are supplied subject to the Company's General Conditions of Sale, a copy of which is available on request. Third-party product and brand names may be trademarks or registered trademarks of their respective owners.

Note: The fuse rating is for guidance only. Please refer to the relevant databook for detailed specification. It is the responsibility of a qualified electrician/electrical engineer to select the correct cable size and fuse rating based on current regulation and site specific conditions. Mitsubishi Electric's air conditioning equipment and heat pump systems contain a fluorinated greenhouse gas, R410A (GWP:2088), R32 (GWP:675), R407C (GWP:1774) or R134a (GWP:1430). *These GWP values are based on Regulation (EU) No 517/2014 from IPCC 4th edition. In case of Regulation (EU) No.626/2011 from IPCC 3rd edition, these are as follows: R410A (GWP:1975), R32 (GWP: 550), R407C (GWP:1650) or R134a (GWP:1300).



www.greengateway.mitsubishielectric.co.uk
Mitsubishi Electric UK's commitment
to the environment

Follow us @meuk_Jes
Follow us @green_gateway

Mitsubishi Electric
Living Environmental Systems UK

YouTube
mitsubishielectric2

BLOG
thehub.mitsubishielectric.co.uk

Effective as of December 2018